

U. S. Department of Agriculture

FOREST SERVICE

E-21
[Handwritten signature]

1147 NATIONAL FOREST

CORNERS OF THE PUBLIC SURVEY

T. *1147* R. *27* Mer.

Section 4 Corner common to Sections *1, 2, 3*, and *12*

Corner consists of a *Post* (not) in place

State condition *good*

Dimensions above ground _____ inches

Sketch grooves, letters, figures, or notches, on proper face or edge.

CARDINAL POSITION

DIAGONAL POSITION

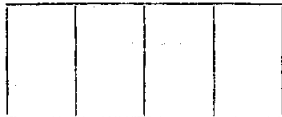

Mound of _____ is located _____

Pits are located _____

Sketch markings of Bearing Trees (or Rocks) in proper box and fill blanks below, giving bearings from Corner to Trees and Distances in Links.

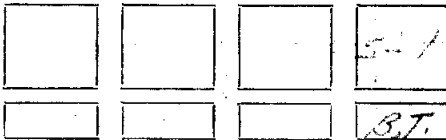

Species _____ *ASIPCA*

Diameter _____ *14"*

Bearing _____ *N 57° E*

Distance _____ *53.4/2*

Do you believe this to be a genuine Land Office Corner? *yes*

If not, why? _____

Lloyd W. Johnson

(Signature)

Jan 10 1934
(Date)

(Title)

E-21

Corner again.
This cor. is in the
center of the Road and
can be located
from county road
Notes

Metal Location Poster is on a
tree 7 inches diameter, on the west
side of Road - 22145
from which this Corner bears
chains distant.
Give any further facts which will aid in finding this

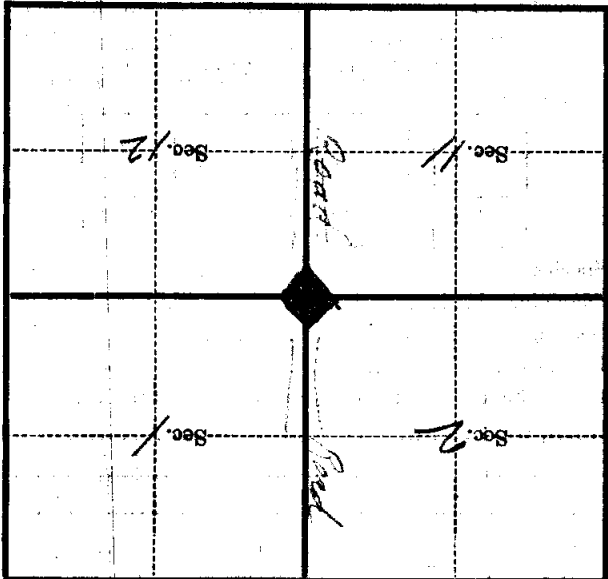

T. 149 R. 27
S. 2
Mer. 5
B-21
(Make sketch of topography near Corner)

U. S. Department of Agriculture

FOREST SERVICE

Chippewa NATIONAL FOREST

CORNERS OF THE PUBLIC SURVEY

T. *149* R. *27* Mer.

Section 4 Corner common to Sections

1, 2, 3, and 4

Corner consists of a *Post* (not) in place

State condition *good*

Dimensions above ground _____ inches

Sketch grooves, letters, figures, or notches, on proper face or edge.

CARDINAL POSITION

DIAGONAL POSITION



N W S E



NW SW SE NE

Mound of _____ is located _____

Pits are located _____

Sketch markings of Bearing Trees (or Rocks) in proper box and fill blanks below, giving bearings from Corner to Trees and Distances in Links.



Species *A.S.P.O.N*

Diameter *1 1/2*

Bearing *N 51° E*

Distance *53.4/2*

Do you believe this to be a genuine Land Office Corner? *Yes*

If not, why? _____

Lloyd W. Johnson
(Signature)

(Date)

(Title)

E21

U. S. Department of Agriculture

FOREST SERVICE

Chippewa NATIONAL FOREST

CORNERS OF THE PUBLIC SURVEY

T. *47* R. *57* Mer.

Corner common to Sections *1, 2, 3, 4*, and *5*

Corner consists of a *stone* (not) in place

State condition *good*

Dimensions above ground _____ inches

Sketch grooves, letters, figures, or notches, on proper face or edge.

CARDINAL POSITION

DIAGONAL POSITION



N W S E



NW SW SE NE

Mound of _____ is located _____

Pits are located _____

Sketch markings of Bearing Trees (or Rocks) in proper box and fill blanks below, giving bearings from Corner to Trees and Distances in Links.



Species _____ *Aspen*

Diameter _____ *14"*

Bearing _____ *N 10° E*

Distance _____ *53.4 ft.*

Do you believe this to be a genuine Land Office Corner? *Yes*

If not, why? _____

(Signature)

(Date)

(Office)

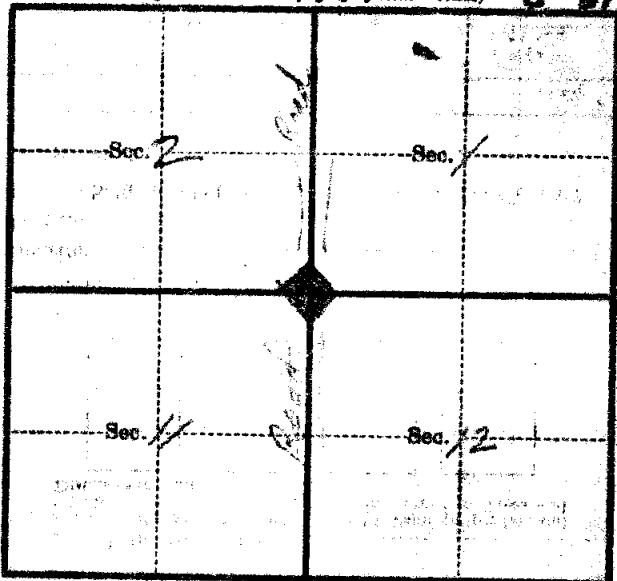

Metal Location Poster is on a W. Pine tree 7 inches diameter, on the West side of Road 401-526K5 from which this Corner bears _____ chains distant.

Give any further facts which will aid in finding this Corner again.

This cot. is in the
West of the Road and
can be located
from County Road
Notes