

U. S. Department of Agriculture

FOREST SERVICE

CP

parted

Chocoma NATIONAL FOREST

CORNERS OF THE PUBLIC SURVEY

T. 149 R. 27 5 Mer.

Corner common to Sections

2, and

Corner consists of a (not) in place

State condition

Dimensions above ground inches

Sketch grooves, letters, figures, or notches, on proper face or edge.

CARDINAL POSITION

DIAGONAL POSITION

--	--	--	--

--	--	--	--

N W S E

NW SW SE NE

Mound of is located

Pits are located

Sketch markings of Bearing Trees (or Rocks) in proper box and fill blanks below, giving bearings from Corner to Trees and Distances in Links.

44
5-2

44
5-2

44
5-2

B.T.

B.T.

B.T.

--

Species ALPINE ALPINE ALPINE

Diameter 7 7 7

Bearing N42W N4E N54E

Distance 20 ft 10 4 ft 9.00 ft

Do you believe this to be a genuine Land Office Corner?

If not, why? This is the center

of sec. 2-301 by a

WANNY Surveyor

W. Johnson

(Signature)

Jan 10-1934

(Date)

Surveyor

(Title)

C-193

Metal Location Poster is on a *Aspen* tree *6* inches diameter, on the *NW* side of *Tree* from which this Corner bears *34 x 5* chains distant.

Give any further facts which will aid in finding this Corner again.

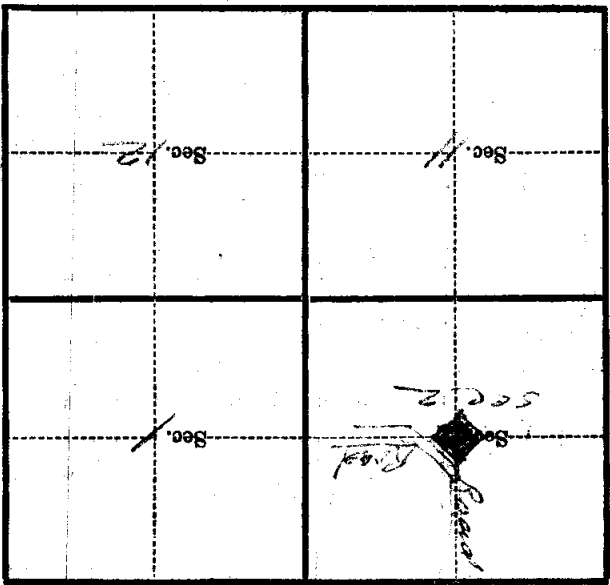

(Make sketch of topography near Corner)

T. 149 R. 27
S. C. 11
C-19

Form 874-9—Revised May, 1918
U. S. Department of Agriculture
FOREST SERVICE

C-19

Chippewa NATIONAL FOREST

CORNERS OF THE PUBLIC SURVEY

T. 149 R. 27 S. Mer.

Center $\frac{1}{4}$ Corner common to Sections
2, and

Corner consists of a ~~rod~~ in place
State condition

Dimensions above ground inches

Sketch grooves, letters, figures, or notches, on proper face or edge.

CARDINAL POSITION

DIAGONAL POSITION

N	W	S	E

NW	SW	SE	NE

Mound of is located

Pits are located

Sketch markings of Bearing Trees (or Rocks) in proper box and fill blanks below, giving bearings from Corner to Trees and Distances in Links.

$\frac{1}{4}$ S-2	$\frac{1}{4}$ S-2	$\frac{1}{4}$ S-2	
----------------------	----------------------	----------------------	--

B.T.	B.T.	B.T.	
------	------	------	--

Species N. PINE N. PINE J. PINE

Diameter 7 7 7

Bearing N42W N4E N54E

Distance 20 ft. 10.4 ft. 9.00 ft.

Do you believe this to be a genuine Land Office Corner?

If not, why? This is the Center
of sec. 2 set by A County
Surveyor.

Lloyd H. Johnson

(Signature)

Jan 16, 1936
(Date)

Surveyor
(Title)

C-19

Corner again.

Give any further facts which will aid in finding this

~~34 LINKS~~ chains distant.

from which this Corner bears N 12° W.

side of tree

tree 6 inches diameter, on the N.W.

Metal Location Poster is on an ASPEN.

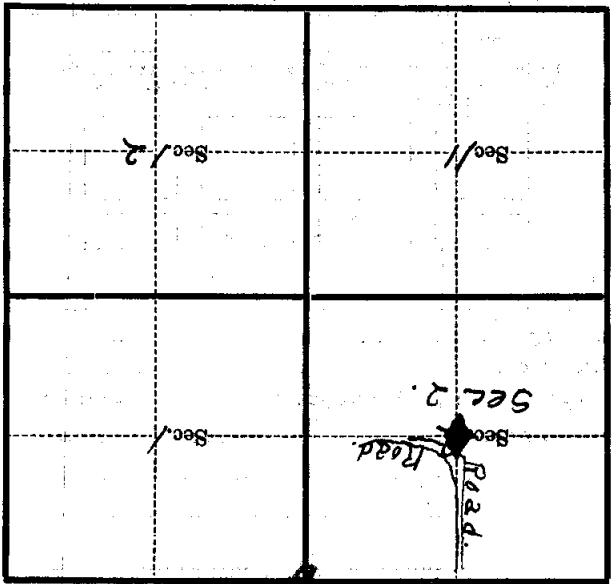

(Make sketch of topography near Corner)