

Form 874-9—Revised May, 1918
 U. S. Department of Agriculture
 FOREST SERVICE

Chippewa NATIONAL FOREST

CORNERS OF THE PUBLIC SURVEY

T. 149 R. 27 5th Mer.

5th Corner common to Sections
27, 26, 34, and 35

Corner consists of a ~~stone~~ (not) in place

State condition _____

Dimensions above ground _____ inches

Sketch grooves, letters, figures, or notches, on proper face or edge.

CARDINAL POSITION

DIAGONAL POSITION

--	--	--	--

N W S E

--	--	--	--

NW SW SE NE

Mound of _____ is located _____

Pits are located _____

Sketch markings of Bearing Trees (or Rocks) in proper box and fill blanks below, giving bearings from Corner to Trees and Distances in Links.

✓	✓	✓	
1	1	1	

Species Stump ASPEN ELM

Diameter 16" 8"

Bearing S52°W S64°E N64°E

Distance 441 1031 721

Do you believe this to be a genuine Land Office Corner? Yes

If not, why? _____

Roy Nelson
 (Signature)

2/4/35
 (Date)

(Title) V-17

151

Corner again.

Give any further facts which will aid in finding this

chains distant.

from which this Corner bears *5620 W.*

side of

Sec 86

inches diameter, on the

W

Metal Location Poster is on a

Regular Post

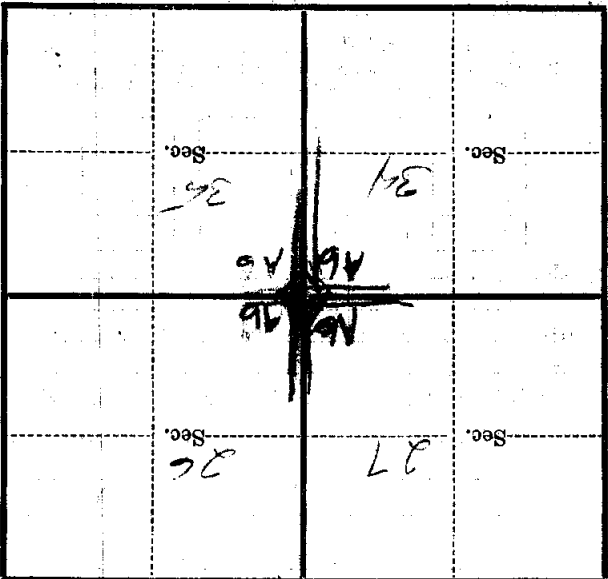

(Make sketch of topography near Corner)

T. 144 R. 27 Mer. *566*

U. S. Department of Agriculture

FOREST SERVICE

V-17

Posted

Chippewa ~~Acq.~~ NATIONAL FOREST

CORNERS OF THE PUBLIC SURVEY

T. 149 N R. 27 W 5th Mer.
section Corner common to Sections
27, 26, 34, and 35

Corner consists of a _____ (tree) in place
State condition _____

Dimensions above ground _____ inches

Sketch grooves, letters, figures, or notches, on proper face or edge.

CARDINAL POSITION

DIAGONAL POSITION

	illegible		
N	W	S	E

NW	SW	SE	NE

Mound of _____ is located _____

Pits are located _____

Sketch markings of Bearing Trees (or Rocks) in proper box and fill blanks below, giving bearings from Corner to Trees and Distances in Links.

illegible			

Species --- Aspen Elm ---
 Diameter stump 16" 8"
 Bearing S52°W S64°E N 64°E
 Distance 44 li. 103 li. 72 links

Do you believe this to be a genuine Land Office Corner? **Yes**

If not, why? _____

Roy Nelson
(Signature)

2/4/35
(Date)

Chief of party COC
(Title)

V-17

Dashed lines for writing.

Corner again.

Give any further facts which will aid in finding this

0.15 chains distant.

from which this Corner bears S 62° W

side of section 26

inches diameter, on the S W

Metal Location Poster is on a regular post

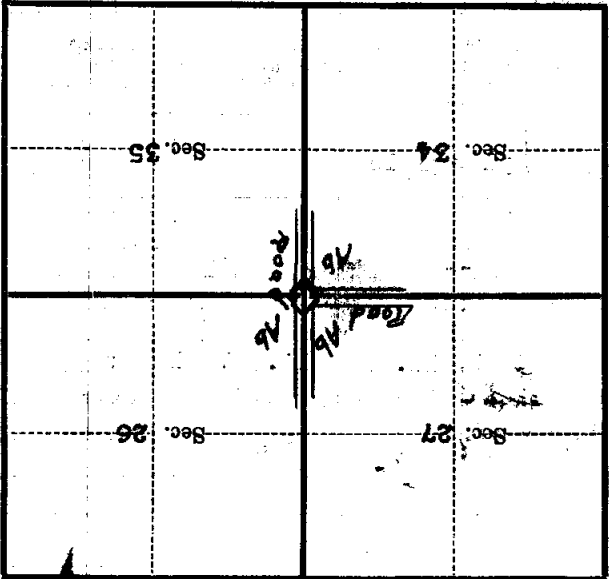

(Make sketch of topography near Corner)