

U. S. Department of Agriculture
FOREST SERVICE

Chippewa NATIONAL FOREST
CORNERS OF THE PUBLIC SURVEY

T. *149N* R. *27W* S. *5TH* Mer.

Corner common to Sections

9, *10*, *14*, and *15*

Corner consists of a *Post* (not) in place

State condition

Dimensions above ground *30* inches

Sketch grooves, letters, figures, or notches, on proper face or edge.

CARDINAL POSITION

DIAGONAL POSITION

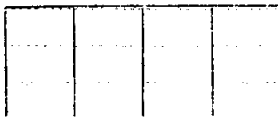
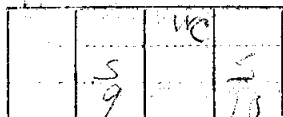

N

W

S

E

NW

SW

SE

NE

Mound of _____ is located

Pits are located

Sketch markings of Bearing Trees (or Rocks) in proper box and fill blanks below, giving bearings from Corner to Trees and Distances in Links.

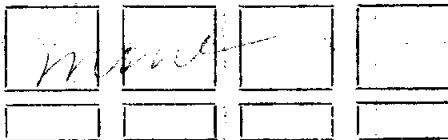

Species _____

Diameter _____

Bearing _____

Distance _____

Do you believe this to be a genuine Land Office Corner? *Y*

If not, why? _____

Rory J. ...
(Signature)

(Date)

(Title)

2/21/24

Dotted lines for writing notes.

Corner again.

Give any further facts which will aid in finding this
from which this Corner bears ~~171~~ *171* ~~chance~~ distant.
side of *Common*
tree. inches diameter, on the *South*
Metal Location Poster is on a *FENCE POST*

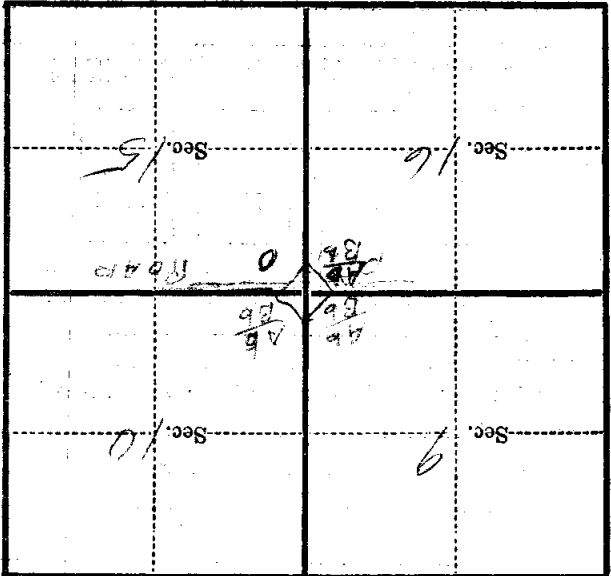

(Make sketch of topography near Corner)

T. 149 N. R. 27 W. 6TH Mer.

U. S. Department of Agriculture

FOREST SERVICE

J-13

Chippewa NATIONAL FOREST

CORNERS OF THE PUBLIC SURVEY

T. 149 R. 27 5 Mer.

S.E. COR. W.C. Corner common to Sections

9, 10, 15, and 16

Corner consists of a W.C. Post in place

State condition Good.

Dimensions above ground 3 inches

Sketch grooves, letters, figures, or notches, on proper face or edge.

CARDINAL POSITION

DIAGONAL POSITION

N	W	S	E

NW	SW	SE	NE

Mound of _____ is located _____

Pits are located _____

Sketch markings of Bearing Trees (or Rocks) in proper box and fill blanks below, giving bearings from Corner to Trees and Distances in Links.

Species _____

Diameter _____

Bearing _____

Distance _____

Do you believe this to be a genuine Land Office Corner? _____

If not, why? _____

F. B. Ames.

(Signature)

Surveyor

(Title)

1-4-34

(Date)

J-13

Witness Corner
60 YARDS North of Corner.

Corner again.

Give any further facts which will aid in finding this

25 YARDS distant.

from which this Corner bears Due North

side of East & West Line.

5 inches diameter, on the North

Metal Location Poster is on a Fence Post

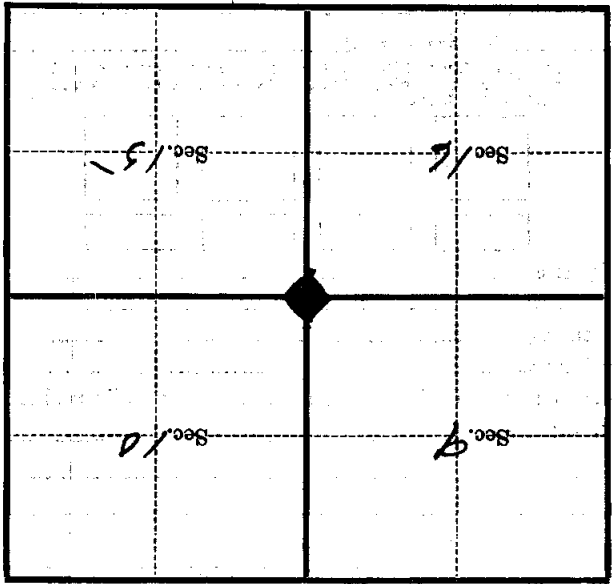

(Make sketch of topography near Corner)

T. 149 R. 27 S. Mer.

Form 874-9—Revised May, 1918
U. S. Department of Agriculture
FOREST SERVICE

J13
posted
10/2

Chippewa NATIONAL FOREST

CORNERS OF THE PUBLIC SURVEY

T. 149 R. 27 5th Mer.

Sec. 6 or W.C. Corner common to Sections

9, 10, 15, and 16

Corner consists of a W.C. post () in place

State condition Good

Dimensions above ground 5 inches

Sketch grooves, letters, figures, or notches, on proper face or edge.

CARDINAL POSITION

DIAGONAL POSITION



N W S E



NW SW SE NE

Mound of _____ is located _____

Pits are located _____

Sketch markings of Bearing Trees (or Rocks) in proper box and fill blanks below, giving bearings from Corner to Trees and Distances in Links.

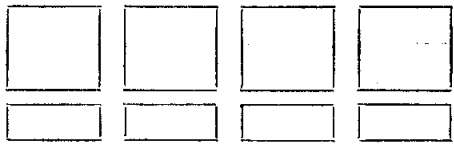

Species _____

Diameter _____

Bearing _____

Distance _____

Do you believe this to be a genuine Land Office Corner? _____

If not, why? _____

11-4-35 (Date)

J. C. [Signature] (Signature)
[Title] (Title)

Corner again: Witness Corner 50 YARDS NORTH OF COR.

Metal Location Poster is on a Fence Post 5 inches diameter, on the North side of East + West line from which this Corner bears 25 YARDS distant. Give any further facts which will aid in finding this

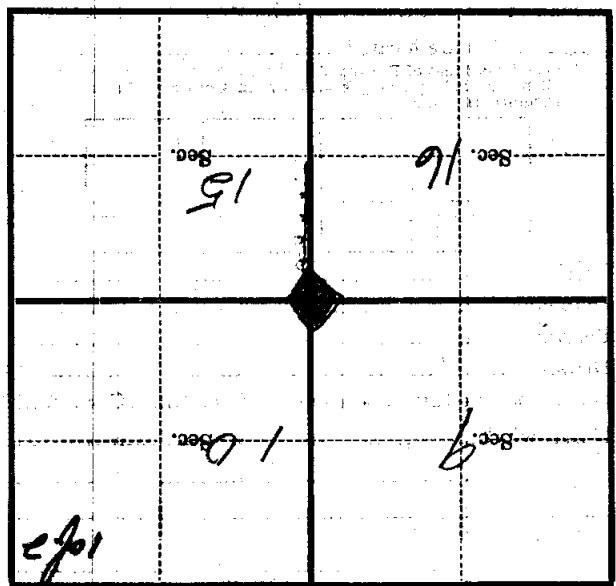

(Make sketch of topography near Corner)

T. 149 R. 27 Mer. 5-13

U. S. Department of Agriculture
FOREST SERVICE

J13
20/2

Chippewa Aog. NATIONAL FOREST
CORNERS OF THE PUBLIC SURVEY

T. 149N R. 27W 5th Mer.

Section Corner common to Sections
9, 10, 16, and 15

Corner consists of a post (not) in place

State condition Good

Dimensions above ground 30 inches

Sketch grooves, letters, figures, or notches, on proper face or edge.

CARDINAL POSITION

DIAGONAL POSITION

	S	WC	S
N	9		10
W		S	E

NW	SW	SE	NE

Mound of is located

Pits are located

Sketch markings of Bearing Trees (or Rocks) in proper box and fill blanks below, giving bearings from Corner to Trees and Distances in Links.

No bearing trees.			

Species

Diameter

Bearing

Distance

Do you believe this to be a genuine Land Office Corner? Yes.

If not, why?

Ray Nelson
(Signature)

2/28/35
(Date)

Chief or party. COO
(Title)

J-13

Corner again.

Give any further facts which will aid in finding this

0.17 chains distant.

from which this Corner bears South

side of Sec. 10

tree inches diameter, on the south

Metal Location Poster is on a fence post

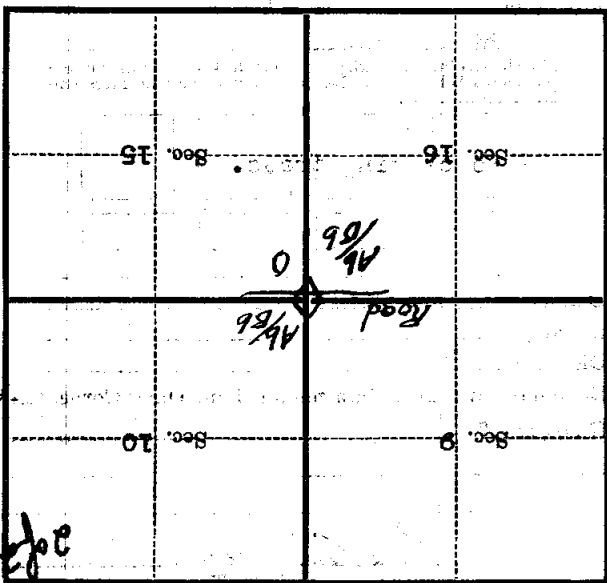

(Make sketch of topography near Corner)

T. 149N R. 27W 5th Mer.

2 of 3
 5-13
 1/12