

Form 874-9—Revised May, 1918
U. S. Department of Agriculture
FOREST SERVICE

R9
posted

Chippewa NATIONAL FOREST
CORNERS OF THE PUBLIC SURVEY

T. 149 N R. 27 W 5th Mer.

Section Corner common to Sections
20, 21, 28, and 29

Corner consists of a Wooden post in place
State condition Good

Dimensions above ground 28 inches
Sketch grooves, letters, figures, or notches, on proper face or edge.

CARDINAL POSITION

DIAGONAL POSITION

N	W	S	E

S 20	S 29	S 28	S 21
NW	SW	SE	NE

Mound of _____ is located _____

Pits are located _____

Sketch markings of Bearing Trees (or Rocks) in proper box and fill blanks below, giving bearings from Corner to Trees and Distances in Links.

S 29			
B.T.			

Species Tam. Stub

Diameter 6"

Bearing S. 55° W

Distance 3 paces

Do you believe this to be a genuine Land Office Corner? yes
If not, why? _____

(5) Verne Gilley

(Signature)

Field Asst.

(Title)

5/31/35
(Date)

10 chains North of location
poster on road.

Corner again.

Give any further facts which will aid in finding this

3.5 acres ~~of~~ distant.

from which this Corner bears

NE

side of

Tree

tree 5 inches diameter, on the

NE

Metal Location Poster is on a

Birch

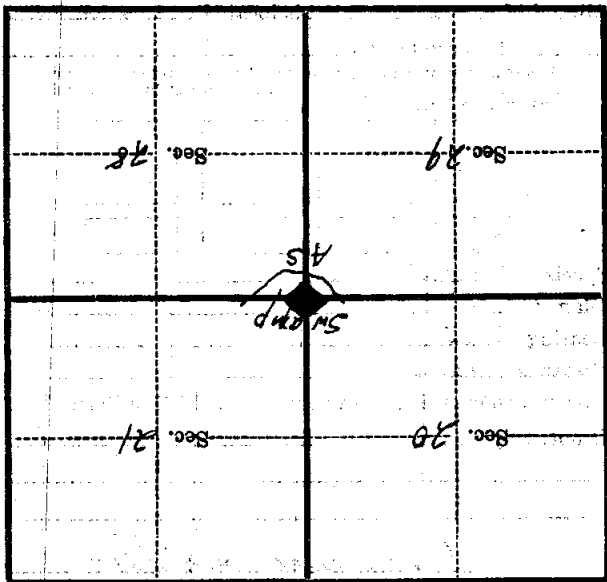

(Make sketch of topography near Corner)

T. 149 R. 27
Mer. 2-9

U. S. Department of Agriculture

FOREST SERVICE

Chippewa NATIONAL FOREST

CORNERS OF THE PUBLIC SURVEY

T. 149 N R. 27 W 5 1/2 Mer.

Sec Corner common to Sections 20, 21, 29, and 28

Corner consists of a Post (not) in place

State condition

Dimensions above ground 26 inches

Sketch grooves, letters, figures, or notches, on wood, stone, or brick.

CARDINAL POSITION

DIAGONAL POSITION

--	--	--	--

N W S E

T-149 N R 27 W			
521	528	529	520

NW SW SE NE

Mound of is located

Pits are located

Sketch markings of Bearing Trees (or Rocks) in proper box and fill blanks below, giving bearings from Corner to Trees and Distances in Links.

	None		

Species

Diameter

Bearing

Distance

Do you believe this to be a genuine Land Office Corner? No

If not, why? No BTs

Hanks

(Signature)

4/29/34

(Date)

T. F.

(Title)

Line Wall cutout from Road to Corner

Corner again.

Give any further facts which will aid in finding this

chains distant.

from which this Corner bears

side of

tree inches diameter, on the

Metal Location Poster is on a

None

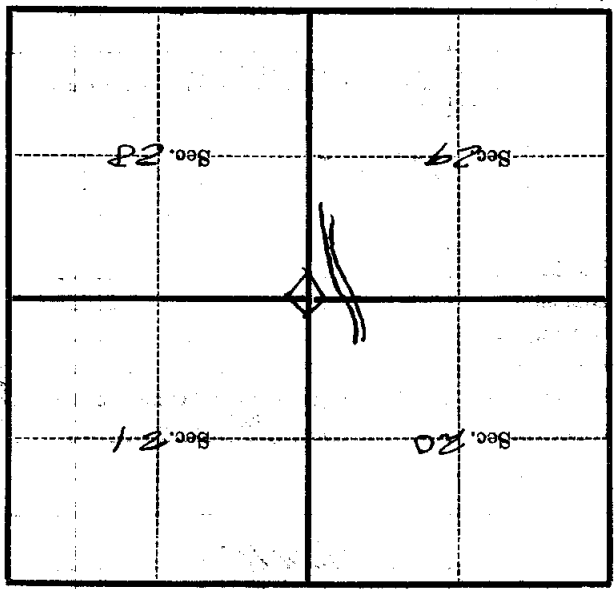

(Make sketch of topography near Corner)