

Form 874-9—Revised May, 1918
U. S. Department of Agriculture
FOREST SERVICE

Chippewa NATIONAL FOREST
CORNERS OF THE PUBLIC SURVEY

T. 149 R. 27 5th Mer.

Sec Corner common to Sections
28, 29, 32, and 33

Corner consists of a aspen (~~rock~~) in place

State condition replaced

Dimensions above ground 36 inches

Sketch grooves, letters, figures, or notches, on proper face or edge.

CARDINAL POSITION

DIAGONAL POSITION

--	--	--	--

N W S E

--	--	--	--

NW SW SE NE

Mound of _____ is located _____

_____ Pits are located _____

Sketch markings of Bearing Trees (or Rocks) in proper box and fill blanks below, giving bearings from Corner to Trees and Distances in Links.

S 29			
BT			

Species Larix

Diameter 6 in fallen

Bearing N 42° W

Distance 30

Do you believe this to be a genuine Land Office Corner? yes

If not, why? _____

J. M. Larson
(Signature)

Dec 31 - 35
(Date)

Compassman
(Title)

Corner again.
This corner was
reestablished from
S. of a field mark

Metal Location Poster is on a
tree 4 inches diameter, on the N.W.
side of tree, facing corner
from which this Corner bears
16 S. 37° E.
Give any further facts which will aid in finding this

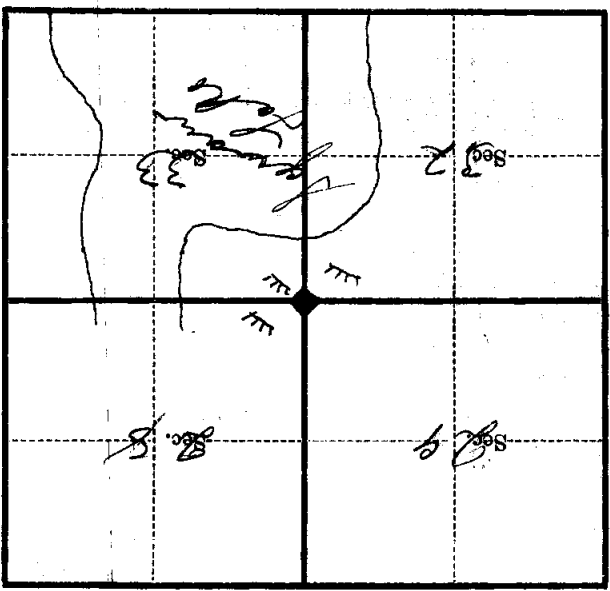

(Make sketch of topography near Corner)

U. S. Department of Agriculture

FOREST SERVICE

V9 P

Chippewa NATIONAL FOREST

CORNERS OF THE PUBLIC SURVEY

T. 149N R. 27W 5th Mer.

Sec. Corner common to Sections

28, 29, 32, and 33

Corner consists of a Aspen (marked) in place

State condition replaced

Dimensions above ground 36 inches

Sketch grooves, letters, figures, or notches, on proper face or edge.

CARDINAL POSITION

DIAGONAL POSITION

N	W	S	E

NW	SW	SE	NE

Mound of _____ is located _____

Pits are located _____

Sketch markings of Bearing Trees (or Rocks) in proper box and fill blanks below, giving bearings from Corner to Trees and Distances in Links.

5			
29			
B.T.			

Species Tamarack

Diameter 6" (to top)

Bearing N42°W

Distance 30'

Do you believe this to be a genuine Land Office Corner? Yes

If not, why? _____

J. M. Larson (Signature)

Dec 31 '35 (Date)

Compassman (Title)

V-9

from G. L. D. field notes.

This corner was established

Corner again.

Give any further facts which will aid in finding this

16 links across distant.

from which this corner bears
side of tree, facing corner
5 57° E

tree 4 inches diameter, on the N.W.
Metal Location Poster is on a Balsam

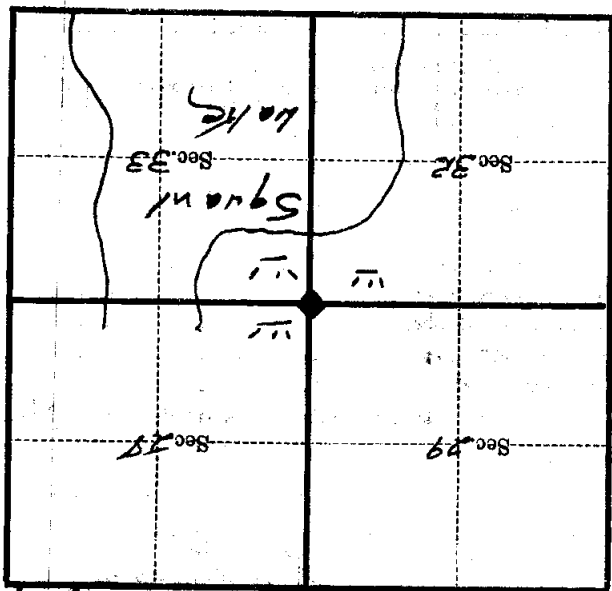

(Make sketch of topography near corner)

T 179N R. 27W S 4. Mer
V-9

U. S. Department of Agriculture

FOREST SERVICE

Chippewa NATIONAL FOREST

CORNERS OF THE PUBLIC SURVEY

T. 149 N R. 27 W 5th Mer.

Sec. Corner common to Sections

28, 29, 32, and 33

Corner consists of a Aspen (cut) in place

State condition replaced

Dimensions above ground 36 inches

Sketch grooves, letters, figures, or notches, on proper face or edge.

CARDINAL POSITION

DIAGONAL POSITION

N	W	S	E

NW	SW	SE	NE

Mound of is located

Pits are located

Sketch markings of Bearing Trees (or Rocks) in proper box and fill blanks below, giving bearings from Corner to Trees and Distances in Links.

5			
29			
B.T.			

Species Lamerock

Diameter 6" (falling)

Bearing N 42° W

Distance 30

Do you believe this to be a genuine Land Office Corner? Yes

If not, why?

J. M. Larson (Signature)

Dec 31, 25 (Date) Game Warden (Title)

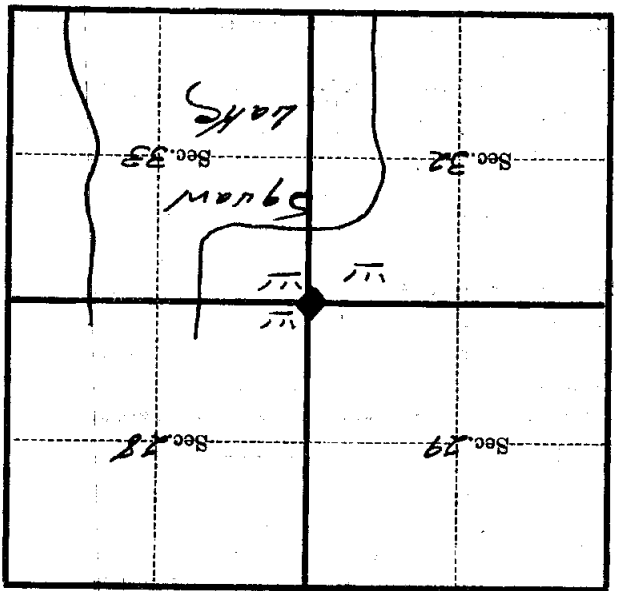

(Make sketch of topography near Corner)

T. 14N. R. 17W. 5th Mc.

Metal Location Poster is on a Dalsam

tree 4 inches diameter, on the N.W.

side of tree, facing corner

from which this Corner bears S 37° E

16 links distant.

Give any further facts which will aid in finding this

Corner again.

This corner was established

from G.L.O. field notes.