

U. S. Department of Agriculture  
FOREST SERVICE

A-5

NATIONAL FOREST

CORNERS OF THE PUBLIC SURVEY

T. 149 N. R. 27 W. 5<sup>TH</sup> Mer.

SECTION Corner common to Sections  
31, 32, 6, and 5

Corner consists of a BIRCHPOST (not) in place  
State condition WELL PRESERVED

Dimensions above ground 22 inches

Sketch grooves, letters, figures, or notches, on proper face or edge.

CARDINAL POSITION

DIAGONAL POSITION

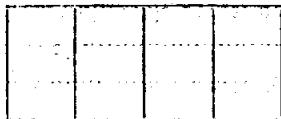

N W S E

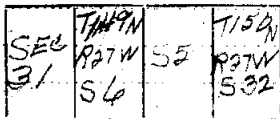

NW SW SE NE

Mound of \_\_\_\_\_ is located \_\_\_\_\_

Pits are located \_\_\_\_\_

Sketch markings of Bearing Trees (or Rocks) in proper box and fill blanks below, giving bearings from Corner to Trees and Distances in Links.

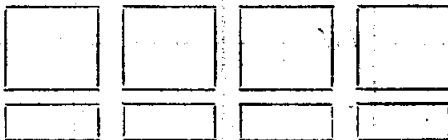

Species STONE

Diameter \_\_\_\_\_

Bearing \_\_\_\_\_

Distance \_\_\_\_\_

Do you believe this to be a genuine Land Office Corner? NO

If not, why? CORNER HAS BEEN MADE TOO RECENTLY

Harrison Adams

(Signature)

9/6/34

(Date)

(Title)

A-5

.....  
.....  
.....  
.....  
.....  
.....  
.....  
.....  
.....  
.....

Corner again.

Give any further facts which will aid in finding this  
..... chains distant.  
..... from which this Corner bears  
..... side of  
..... tree ..... inches diameter, on the  
..... Metal Location Poster is on a

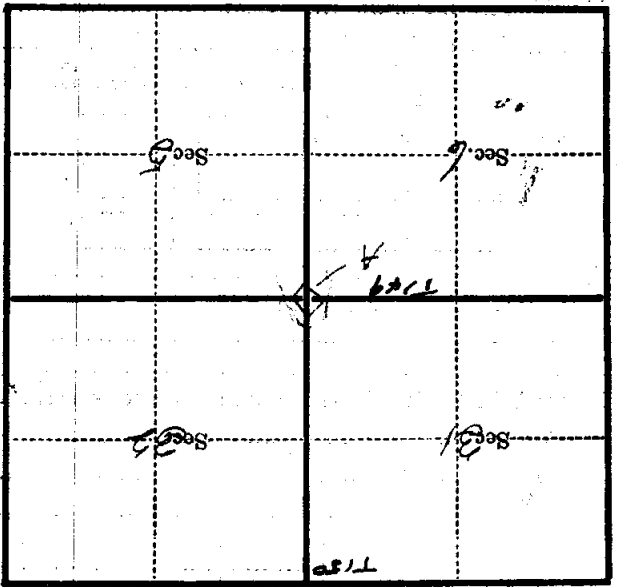

(Make sketch of topography near Corner)

Form 874-9—Revised May, 1918  
 U. S. Department of Agriculture  
 FOREST SERVICE

*Posted A-5*

NATIONAL FOREST

CORNERS OF THE PUBLIC SURVEY

T. <sup>150</sup>149 N R. 27 W 5 th Mer.

Section Corner common to Sections  
 31, 32, 6, and 5

Corner consists of a Birch post (not) in place  
 State condition Well preserved

Dimensions above ground 22 inches

Sketch grooves, letters, figures, or notches, on proper face or edge.

CARDINAL POSITION

DIAGONAL POSITION

N	W	S	E

S	T149		T150
31	R 27	S	R 27
	S 6	5	S 32
NW	SW	SE	NE

Mound of is located

Pits are located

Sketch markings of Bearing Trees (or Rocks) in proper box and fill blanks below, giving bearings from Corner to Trees and Distances in Links.

Species None  
 Diameter  
 Bearing  
 Distance

Do you believe this to be a genuine Land Office Corner? **NO**

If not, why? Corner has been made too recently.

*arrison adams*

(Signature)

9/6/34  
 (Date)

*c.c.c. asst. Lesher*  
 (Title)

**A-5**

MICROWFILMED SET

Dotted lines for writing.

Corner again.

Give any further facts which will aid in finding this  
chains distant.  
from which this Corner bears  
side of  
tree inches diameter, on the  
Metal Location Poster is on a

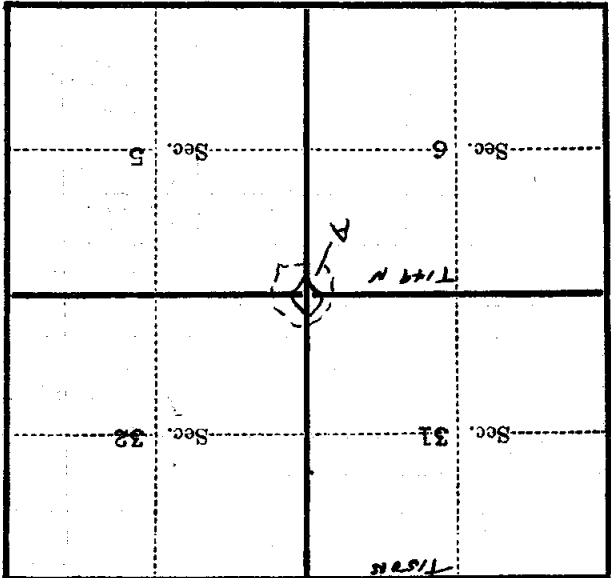

(Make sketch of topography near Corner)