

U. S. Department of Agriculture  
FOREST SERVICE

Chippewa NATIONAL FOREST  
CORNERS OF THE PUBLIC SURVEY

T. 149 R. 27 Sth Mer.

Section Corner common to Sections  
13, 18, 24, and 19

Corner consists of a Post (not) in place  
State condition \_\_\_\_\_

Dimensions above ground \_\_\_\_\_ inches

Sketch grooves, letters, figures, or notches, on proper face or edge.

CARDINAL POSITION				DIAGONAL POSITION			
				T-149 S-13	R-27 S24	T-149 S19	R-27 S18
N	W	S	E	NW	SW	SE	NE

Mound of \_\_\_\_\_ is located \_\_\_\_\_

Pits are located \_\_\_\_\_

Sketch markings of Bearing Trees (or Rocks) in proper box and fill blanks below, giving bearings from Corner to Trees and Distances in Links.

	No	B	Ts

Species \_\_\_\_\_

Diameter \_\_\_\_\_

Bearing \_\_\_\_\_

Distance \_\_\_\_\_

Do you believe this to be a genuine Land Office Corner? Yes

If not, why? \_\_\_\_\_

(Signature) \_\_\_\_\_

(Date) \_\_\_\_\_

(Title) N-1

Dotted lines for writing notes.

Corner again.

Give any further facts which will aid in finding this  
chains distant.  
from which this Corner bears  
side of  
tree inches diameter, on the  
Metal Location Poster is on a

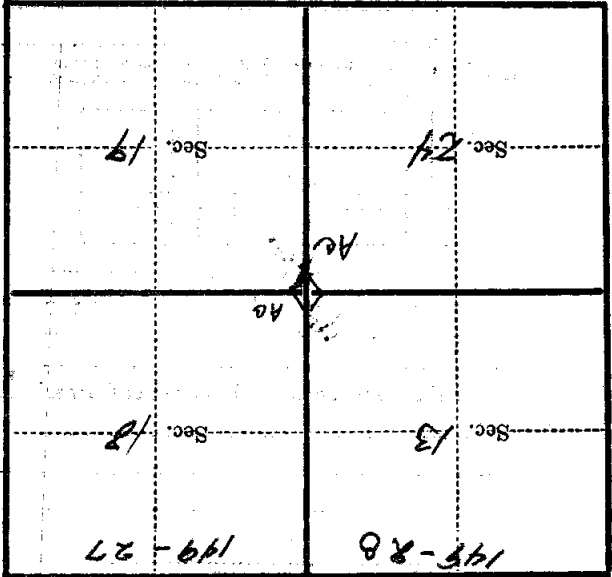

(Make sketch of topography near Corner)

T. R. Mer.

Form 874-0—Revised May, 1918  
 U. S. Department of Agriculture  
 FOREST SERVICE

N-1

Chippewa NATIONAL FOREST  
 CORNERS OF THE PUBLIC SURVEY

T. 149N R. 27W 5th Mer.

15 Section Corner common to Sections  
13, 18, 24, and 19

Corner consists of a post (not) in place

State condition \_\_\_\_\_

Dimensions above ground \_\_\_\_\_ inches

Sketch grooves, letters, figures, or notches, on proper face or edge.

CARDINAL POSITION

DIAGONAL POSITION

--	--	--	--

T149 S13	R28W S24	T149 S19	R27 S18
-------------	-------------	-------------	------------

N W S E

NW SW SE NE

Mound of \_\_\_\_\_ is located \_\_\_\_\_

Pits are located \_\_\_\_\_

Sketch markings of Bearing Trees (or Rocks) in proper box and fill blanks below, giving bearings from Corner to Trees and Distances in Links.

No	Bearing	Trees	

Species \_\_\_\_\_

Diameter \_\_\_\_\_

Bearing \_\_\_\_\_

Distance \_\_\_\_\_

Do you believe this to be a genuine Land Office Corner? **Yes**

If not, why? \_\_\_\_\_

*H. Adams*  
 (Signature)

Asst. Leader **CSG**

(Date)

N-1

Metal Location Poster is on a tree inches diameter, on the side of from which this Corner bears chains distant. Give any further facts which will aid in finding this Corner again.

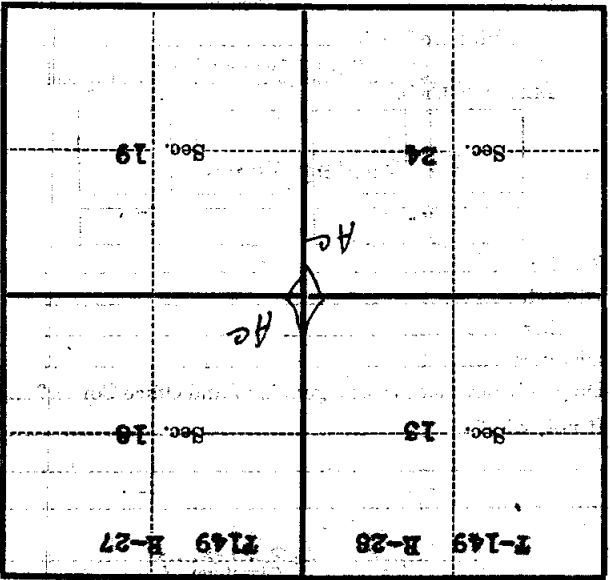

(Make sketch of topography near corner)

T. 149N R. 27W  
 149 B-28  
 149 B-27  
 Mer. N-1