

Form 874-9—Revised May, 1918
U. S. Department of Agriculture
FOREST SERVICE

R-1
H

Chippewa NATIONAL FOREST
CORNERS OF THE PUBLIC SURVEY

T. 149N R. 27W 5th Mer.

Section Corner common to Sections
24, 19, 25, and 30

Corner consists of a Aspen post (not) in place
State condition replaced

Dimensions above ground 30 inches

Sketch grooves, letters, figures, or notches, on proper face or edge.

CARDINAL POSITION

DIAGONAL POSITION



N W S E

NW SW SE NE

Mound of _____ is located _____

_____ Pits are located _____

Sketch markings of Bearing Trees (or Rocks) in proper box and fill blanks below, giving bearings from Corner to Trees and Distances in Links.

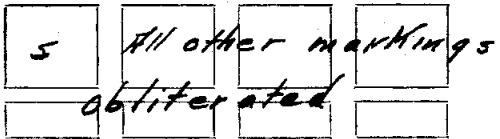

Species Stub, badly decayed

Diameter 10"

Bearing S 18° 30' E

Distance 7 links

Do you believe this to be a genuine Land Office Corner? Yes

If not, why? _____

J. M. Larson
(Signature)

Dec 19, '30
(Date)

Sompson
(Title)

R-1

Corner again.

Give any further facts which will aid in finding this

~~20 links~~ ~~or~~ ~~more~~ distant.

from which this Corner bears *N31°30'W*

side of *tree facing corner*

tree *5* inches diameter, on the *N.E.*

Metal Location Poster is on a *Aspen*

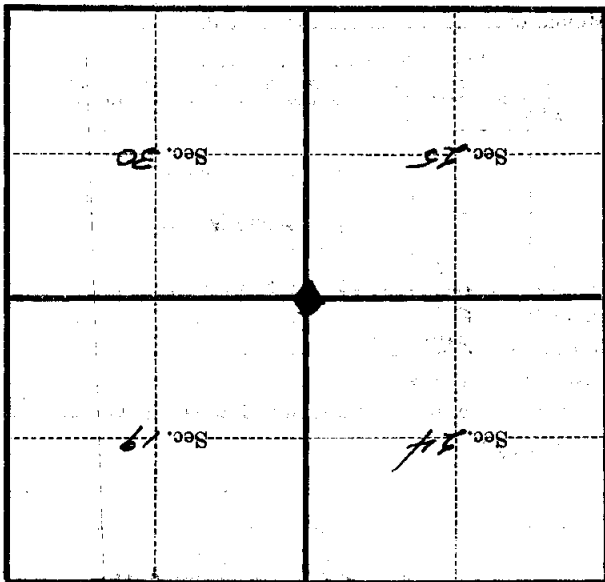

(Make sketch of topography near Corner)

T. 149N R. 22W S. 44
Mer. *R-1*