

Form 874-9—Revised May, 1918
U. S. Department of Agriculture
FOREST SERVICE

L21
P

Chippewa NATIONAL FOREST

CORNERS OF THE PUBLIC SURVEY

T. 149 N R. 26 W 5th Mer.

Quarter Corner common to Sections
13, and 14

Corner consists of a Cedar Post (~~not~~) in place
State condition Good

Dimensions above ground 30 inches
Sketch grooves, letters, figures, or notches, on proper face or edge.

CARDINAL POSITION

DIAGONAL POSITION

--	--	--	--

N W S E

--	--	--	--

NW SW SE NE

Mound of _____ is located _____

_____ Pits are located _____

Sketch markings of Bearing Trees (or Rocks) in proper box and fill blanks below, giving bearings from Corner to Trees and Distances in Links.

<u>1/4</u> <u>514</u>			
<u>B.T.</u>			

Species Cedar

Diameter 2"

Bearing S 18° W

LKS Distance 8 1/2

Do you believe this to be a genuine Land Office Corner? No

If not, why? Corner & B.T.s lost. Established Cor. on straight line between sec. Cors & at Equal Distances

J A Gjelhaug
(Signature)

9/27/35
(Date)

Jr Civil Engr.
(Title)

Corner again.

Give any further facts which will aid in finding this

0.08 1/2 chains distant.

from which this Corner bears N 18° E

side of Tree

tree 7" inches diameter, on the N.E.

Metal Location Poster is on a Cedar

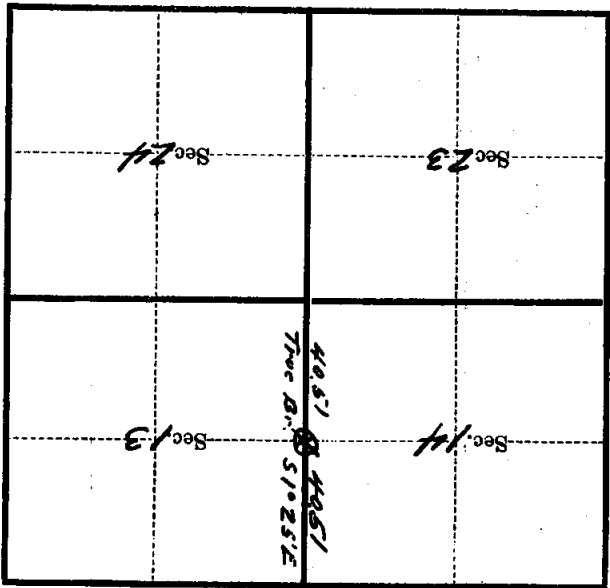

(Make sketch of topography near Corner)

T. 149 N. R. 26 W. 5 1/4 Mer.