

U. S. Department of Agriculture
FOREST SERVICE

A 18

P
5
36

NATIONAL FOREST

CORNERS OF THE PUBLIC SURVEY

T. ¹⁴⁹130 R. 26 5TH Mer.

W. ¹⁴th Corner common to Sections

-----, -----, 2, and 35

Corner consists of a BALSAM (not) in place

State condition FAIR

Dimensions above ground 3x3x40 inches

Sketch grooves, letters, figures, or notches, on proper face or edge.

CARDINAL POSITION

DIAGONAL POSITION

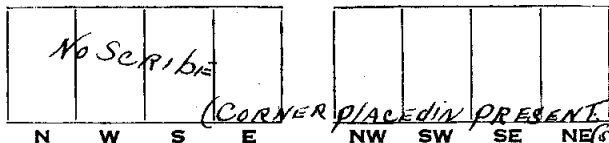

Mound of ----- is located -----

Pits are located -----

Sketch markings of Bearing Trees (or Rocks) in proper box and fill blanks below, giving bearings from Corner to Trees and Distances in Links.

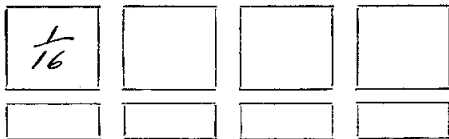

Species J.P.

Diameter 13"

Bearing N 61° E

Distance 6.1k.

Do you believe this to be a genuine Land Office Corner? No

If not, why? CORNER SET IN PRESENT SURVEY. B.T. FROM COUNTY SURVEY.

H.C. Momm

(Signature)

Dec. 2, 1935
(Date)

J. Forester
(Title)

CORNER ON EDGE OF TIMBER LINE

Corner again.

Give any further facts which will aid in finding this

D.H.7 chains distant.

from which this Corner bears *N 80° W*

side of *TREE*

tree 6 inches diameter, on the *NW*

Metal Location Poster is on a *N.P.*

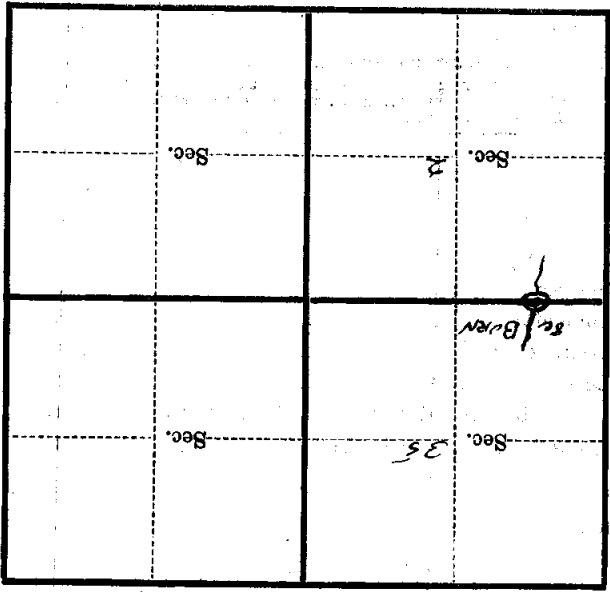

(Make sketch of topography near Corner)

T. 150
149
R. 26
5TH Mer.