

U. S. Department of Agriculture  
FOREST SERVICE

A9 36

Chippewa NATIONAL FOREST

CORNERS OF THE PUBLIC SURVEY

T. 149 N R. 26 W 5<sup>th</sup> Mer.

Section Corner common to Sections

4, 5, 32, and 33

Corner consists of a Cedar (~~not~~) in place

State condition Good

Dimensions above ground \_\_\_\_\_ inches

Sketch grooves, letters, figures, or notches, on proper face or edge.

CARDINAL POSITION

DIAGONAL POSITION



Mound of \_\_\_\_\_ is located \_\_\_\_\_

Pits are located \_\_\_\_\_

Sketch markings of Bearing Trees (or Rocks) in proper box and fill blanks below, giving bearings from Corner to Trees and Distances in Links.

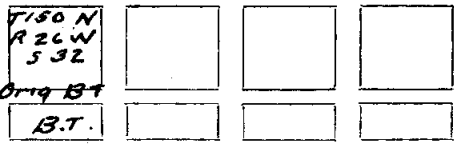

Species Cedar Cedar

Diameter 12" 5"

Bearing N 90° W S 75° W

Lks. Distance 26 6

Do you believe this to be a genuine Land Office Corner? yes

If not, why? \_\_\_\_\_

\_\_\_\_\_  
\_\_\_\_\_

J A Ogelbaug  
(Signature)

9/19/35  
(Date)

Jr. Civil Engr  
(Title)

Found one old orig B.T. placed poster  
and set new cedar post  
Corner again.

Give any further facts which will aid in finding this  
0.06 chains distant.  
from which this Corner bears N 75° E  
side of Tree  
tree 5 inches diameter, on the NE  
Metal Location Poster is on a Cedar

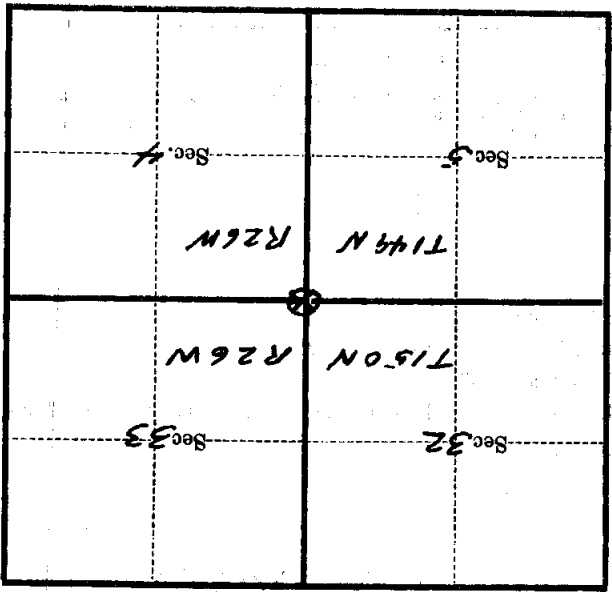

(Make sketch of topography near Corner)

T. 149 N. R. 26 W. S. 74 Mer.