

U. S. Department of Agriculture
FOREST SERVICE

Chippewa NATIONAL FOREST

CORNERS OF THE PUBLIC SURVEY

T. 148N R. 30 & 29 W 5th P. Mer.
Quarter Corner common to Sections

24, and 19

Corner consists of a Cedar post (~~not~~) in place

State condition Good

Dimensions above ground 40 inches

Sketch grooves, letters, figures, or notches, on proper face or edge.

CARDINAL POSITION

DIAGONAL POSITION

N	W	S	E

NW	SW	SE	NE

Mound of _____ is located _____

Pits are located _____

Sketch markings of Bearing Trees (or Rocks) in proper box and fill blanks below, giving bearings from Corner to Trees and Distances in Links.

Co. B.T.

<u>1/4 S</u> <u>24</u>

--

--

--

B.T.

--

--

--

Species Dead Tam.

Diameter 8"

Bearing S. 70° W

Distance 64

Do you believe this to be a genuine Land Office Corner? Yes

If not, why? _____

John A. Gjelhaug

(Signature)

Jr. Civil Engineer

(Title)

9-2-38

(Date)

Corner again.

Give any further facts which will aid in finding this

0.44 chains distant.

from which this Corner bears S. 80° W

side of Tree

tree 10 inches diameter, on the West

Metal Location Poster is on a Aspen

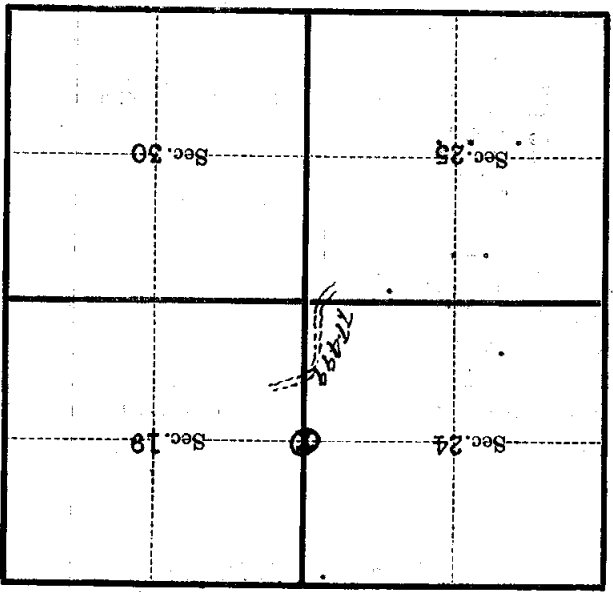

(Make sketch of topography near Corner)

T. 148 N R. 30 & 29 W 5th P. Mer.

P-25

U. S. Department of Agriculture

FOREST SERVICE

Chippewa NATIONAL FOREST

CORNERS OF THE PUBLIC SURVEY

T. 148N. R. 30-29W. 5th P. Mer.

Quarter Corner common to Sections
 _____, _____, 24, and 19

Corner consists of a Cedar Post (not) in place

State condition Good

Dimensions above ground 40 inches
 Sketch grooves, letters, figures, or notches, on proper face or edge.

CARDINAL POSITION

DIAGONAL POSITION

--	--	--	--

N W S E

--	--	--	--

NW SW SE NE

Mound of _____ is located _____

_____ Pits are located _____

Sketch markings of Bearing Trees (or Rocks) in proper box and fill blanks below, giving bearings from Corner to Trees and Distances in Links.

Co. P.T. 1/4 S 24			
P.T.			

Species Diad. Tam.

Diameter 8"

Bearing S. 70° W

Distance 64

Do you believe this to be a genuine Land Office Corner? Yes.

If not, why? _____

John A. Gjelhaug

(Signature)

Jr. Civil Eng.

(Title)

9/2/38

(Date)

Metal Location Poster is on a *Aspen* tree *10* inches diameter, on the *WEST* side of *tree* from which this Corner bears *S 80° W.* *0.99* chains distant.
 Give any further facts which will aid in finding this Corner again.

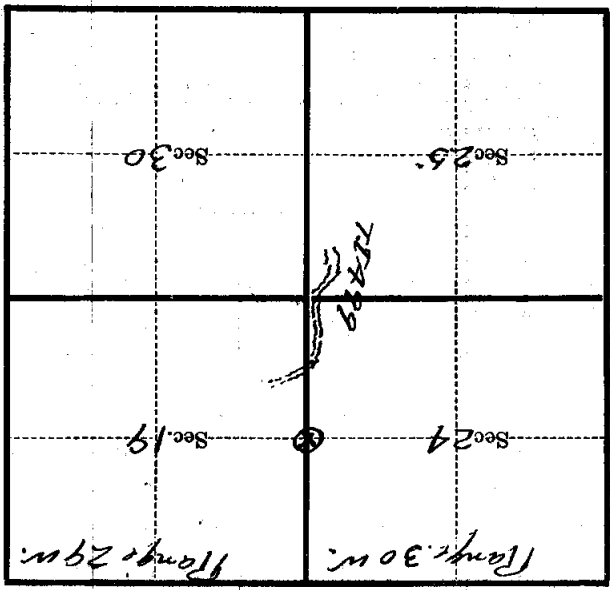

(Make sketch of topography near Corner)

T. 198N. R. 30-29W. S. 19P. Mer.