

Form 874-9—Revised May, 1918
U. S. Department of Agriculture
FOREST SERVICE

*usually
Post*

Chippewa NATIONAL FOREST

CORNERS OF THE PUBLIC SURVEY

T. 148 N. R. 30 W. 5th Mer.

1/4- Corner common to Sections
12, and 13

Corner consists of a Post ~~(not)~~ in place
State condition

Dimensions above ground _____ inches
Sketch grooves, letters, figures, or notches, on proper face or edge.

CARDINAL POSITION

DIAGONAL POSITION

N	W	S	E

NW	SW	SE	NE

Mound of _____ is located _____

Pits are located _____

Sketch markings of Bearing Trees (or Rocks) in proper box and fill blanks below, giving bearings from Corner to Trees and Distances in Links.

BT	BT		

Species Spruce

Diameter _____

Bearing SE NW

Distance 50 Links 40 Links

Do you believe this to be a genuine Land Office Corner? Yes

If not, why? _____

J. P. Bauch
G. U. Bauch
(Signature)

Junior Forester
(Title)

11/29/55
(Date)

Metal Location Poster is on a tree _____ inches diameter, on the _____ side of _____ from which this Corner bears _____ chains distant.
 Give any further facts which will aid in finding this Corner again.

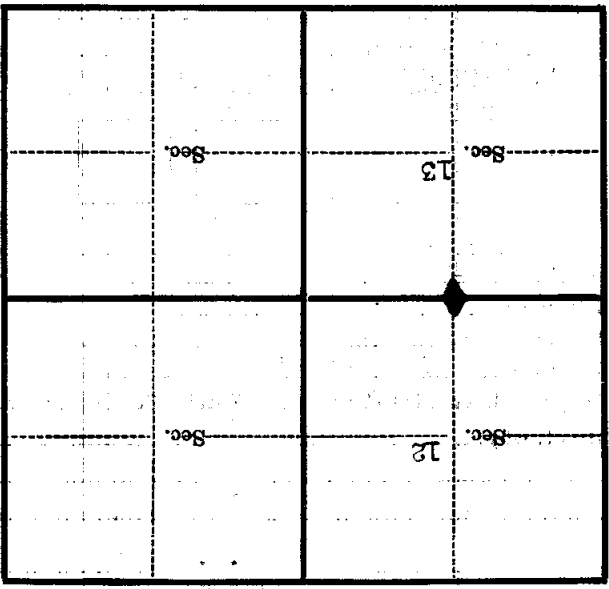

(Make sketch of topography near Corner)

T. 148 N. R. 30 W. 5th Mer. J-23

Form 874-9—Revised May, 1918

U. S. Department of Agriculture

FOREST SERVICE

Chippewa NATIONAL FOREST

CORNERS OF THE PUBLIC SURVEY

T. 148N. R. 30W. 572P. Mer.

Quarter Corner common to Sections
.....,, 12, and 13

Corner consists of a Wood Post (~~rod~~) in place

State condition Good

Dimensions above ground 40 inches

Sketch grooves, letters, figures, or notches, on proper face or edge.

CARDINAL POSITION

DIAGONAL POSITION

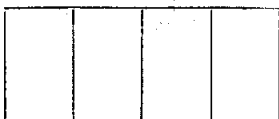

Mound of is located

Pits are located

Sketch markings of Bearing Trees (or Rocks) in proper box and fill blanks below, giving bearings from Corner to Trees and Distances in Links.

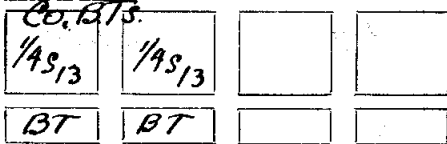

Species Spruce Spruce

Diameter 7" 8"

Bearing S 28° W. S 26° E.

Distance 13 30 1/2

Do you believe this to be a genuine Land Office Corner? yes

If not, why?

John A. Gjelhaug

(Signature)

Mr. Civil Eng.

(Title)

6/28/39

(Date)

Corner again.

Give any further facts which will aid in finding this

0.13 chains distant.

from which this Corner bears

N. 28° E

side of Tree

tree 7 inches diameter, on the N.E.

Metal Location Poster is on a Spruce

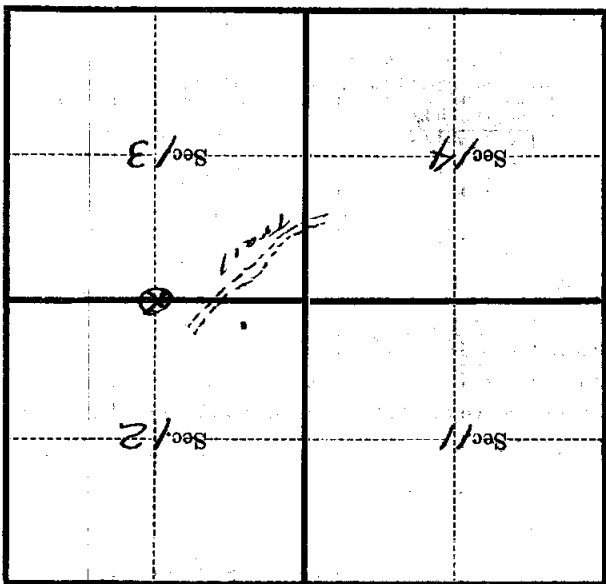

(Make sketch of topography near Corner)

T. 198N. R. 30W. 252
573 P
J-23 Mer.