

Form 874-9—Revised May, 1918

U. S. Department of Agriculture

FOREST SERVICE

Chippewa NATIONAL FOREST

CORNERS OF THE PUBLIC SURVEY

T. 148N R. 30W 5th Mer.

Sec. Corner common to Sections 11, 12, 13, and 14

Corner consists of a Stake (not) in place State condition good

Dimensions above ground 28 inches

Sketch grooves, letters, figures, or notches, on proper face or edge.

CARDINAL POSITION

DIAGONAL POSITION

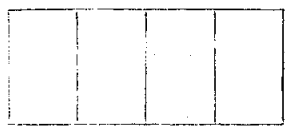
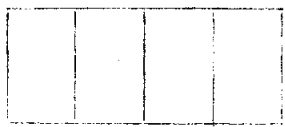

Mound of is located

Pits are located

Sketch markings of Bearing Trees (or Rocks) in proper box and fill blanks below, giving bearings from Corner to Trees and Distances in Links.

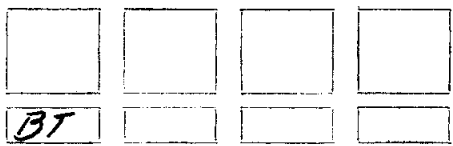

Species

Diameter

Bearing

Distance

Do you believe this to be a genuine Land Office Corner? No

If not, why? County survey made here but no corner evidenced

G.D. Bauch (Signature)

S.F. (Title)

11/27/35 (Date)



Form 874-9—Revised May, 1918

U. S. Department of Agriculture

FOREST SERVICE

Chippewa NATIONAL FOREST

CORNERS OF THE PUBLIC SURVEY

T. 148 N. R. 30 W. 5th P. Mer.

Section Corner common to Sections 11, 12, 13, and 14

Corner consists of 3 Iron Pipes (not) in place State condition Good

Dimensions above ground inches

Sketch grooves, letters, figures, or notches, on proper face or edge.

CARDINAL POSITION

DIAGONAL POSITION

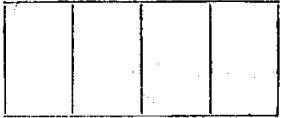

N W S E

NW SW SE NE

Mound of is located

Pits are located

Sketch markings of Bearing Trees (or Rocks) in proper box and fill blanks below, giving bearings from Corner to Trees and Distances in Links.

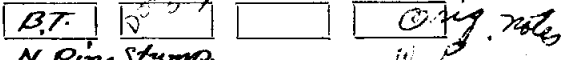

Species N. Pine Stump

Diameter 14" 14 21 16

Bearing S. 57° E S. 35° E N. 13 W

Distance 70 12 30

Do you believe this to be a genuine Land Office Corner? yes.

If not, why?

K. V. Styler

(Signature)

Leader.

(Title)

5/3/30

(Date)

Corner again.

Give any further facts which will aid in finding this

0.60 chains distant.

from which this Corner bears S. 61° W.

side of *Tree*

tree 8 inches diameter, on the S.W.

Metal Location Poster is on an *Aspen*

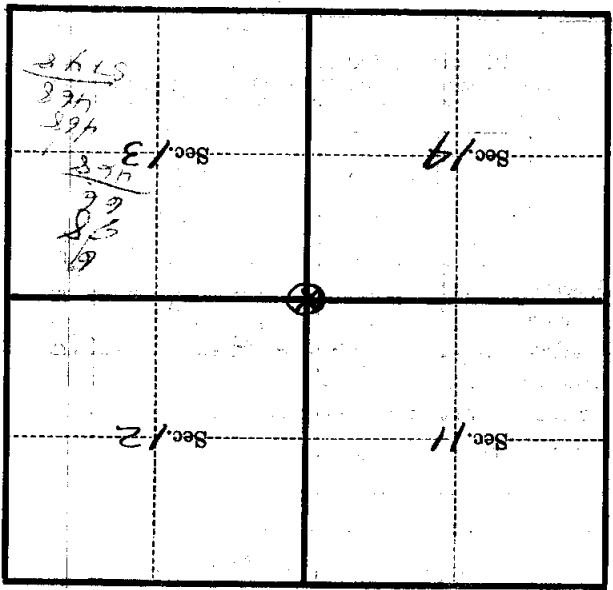

(Make sketch of topography near Corner)

T. 148N. R. 30W. 54P. Mer.