

L-21

Form 874-9—Revised May, 1918

U. S. Department of Agriculture
FOREST SERVICE

Chippewa NATIONAL FOREST

CORNERS OF THE PUBLIC SURVEY

T. 148 N. R. 30 W. 5th P. Mer.

Quarter _____ Corner common to Sections

_____, 13, and 14

Corner consists of a Scribed Wood Post in place

State condition Good

Dimensions above ground 30 inches

Sketch grooves, letters, figures, or notches, on proper face or edge.

CARDINAL POSITION

DIAGONAL POSITION



Mound of _____ is located _____

_____ Pits are located _____

Sketch markings of Bearing Trees (or Rocks) in proper box and fill blanks below, giving bearings from Corner to Trees and Distances in Links.

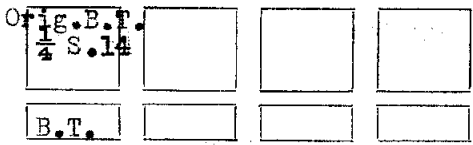

Species Tam'c fallen down

Diameter 5"

Bearing N. 29° W.

Distance 72

Do you believe this to be a genuine Land Office Corner? Yes

If not, why? _____

K.V. Styler

(Signature)

Leader

(Title)

5/3/38

(Date)

L-21

Metal Location Poster is on a *W. Pine*
 tree 5 inches diameter, on the *N.W.*
 side of *Tree*
 from which this Corner bears *N. 60° W.*
 chains distant. *0.77*
 Give any further facts which will aid in finding this
 Corner again.

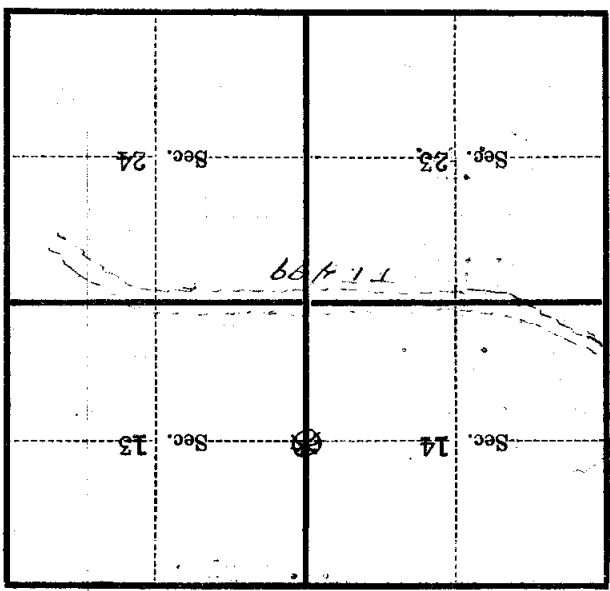

(Make sketch of topography near Corner)

T. 148 N. R. 30 W. 5th P. Mer.

L-21

U. S. Department of Agriculture

FOREST SERVICE

Chippewa NATIONAL FOREST

CORNERS OF THE PUBLIC SURVEY

T. 148N. R. 30W. 5th P. Mer.

Quarter Corner common to Sections
 _____, _____, 13, and 14

Corner consists of a Scribed Wood Post (~~not~~) in place
 State condition Good

Dimensions above ground 30 inches
 Sketch grooves, letters, figures, or notches, on proper face or edge.

CARDINAL POSITION

DIAGONAL POSITION

N	W	S	E

NW	SW	SE	NE

Mound of _____ is located _____

Pits are located _____

Sketch markings of Bearing Trees (or Rocks) in proper box and fill blanks below, giving bearings from Corner to Trees and Distances in Links.

<u>Orig. B.T.</u> <u>1/4 S</u> <u>14</u>			
<u>B.T.</u>			

Orig. notes

Species Tangle, Fallen down large trees

Diameter 5" 6

Bearing N. 29° W. S. 50° E N 49° W

Distance 72 20 12

Do you believe this to be a genuine Land Office Corner? Yes

If not, why? _____

K.V. Styler

(Signature)

Leader

5/3/38

(Date)

(Title)

L-21

26.400
13.800
22.600

Corner again.

Give any further facts which will aid in finding this

0.77 chains distant.

from which this Corner bears N. 60° W.

side of tree

tree 5 inches diameter, on the N.W.

Metal Location Poster is on a W. Pine

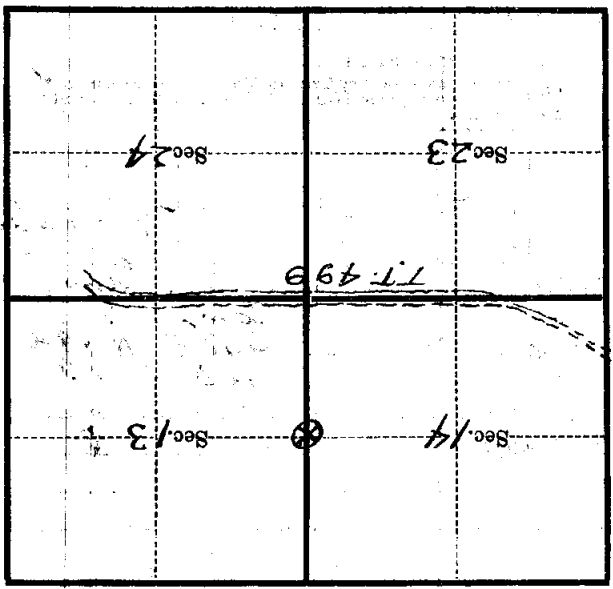

(Make sketch of topography near Corner)

T. 148 N. R. 30 W. 5th P. Mer.