

**U. S. Department of Agriculture**  
**FOREST SERVICE**

Chippewa NATIONAL FOREST

**CORNERS OF THE PUBLIC SURVEY**

T. 148 N R. 30 W 5th P. Mer.  
Quarter Corner common to Sections

10, and 15

Corner consists of a Tam'c post (not) in place

State condition Good

Dimensions above ground 48 inches

Sketch grooves, letters, figures, or notches, on proper face or edge.

CARDINAL POSITION

DIAGONAL POSITION

--	--	--	--

N W S E

--	--	--	--

NW SW SE NE

Mound of is located

Pits are located

Sketch markings of Bearing Trees (or Rocks) in proper box and fill blanks below, giving bearings from Corner to Trees and Distances in Links.

Orig. B.T.

1/4 S			T
15			

B.T.			
------	--	--	--

Species Tam'c Stp.

Diameter 7"

Bearing S. 47° W

Distance 9

Do you believe this to be a genuine Land Office Corner? Yes

If not, why?

John A. Gjelhaug

(Signature)

10-20-38

Jr. Civil Engineer

(Date)

(Title)

Corner again.

Give any further facts which will aid in finding this

0.097 chains distant.

from which this Corner bears S. 47° E.

side of Tree

tree 5 inches diameter, on the S. E.

Metal Location Poster is on a Tam'o

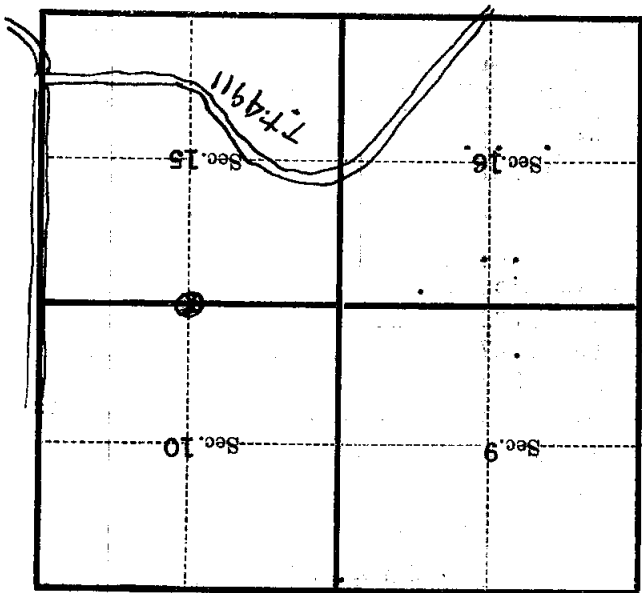

(Make sketch of topography near Corner)

T. 148 N R. 30 W 5th P. Mer.

J-15

Form 874-9—Revised May, 1918  
U. S. Department of Agriculture  
FOREST SERVICE

Chippewa NATIONAL FOREST

CORNERS OF THE PUBLIC SURVEY

T. 148 N. R. 30 W 524 P. Mer.

Quarter Corner common to Sections  
10, and 15

Corner consists of a Tamie Post (not) in place  
State condition Good

Dimensions above ground 48 inches  
Sketch grooves, letters, figures, or notches, on proper face or edge.

CARDINAL POSITION

DIAGONAL POSITION

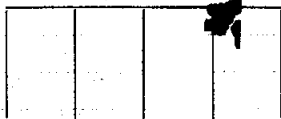
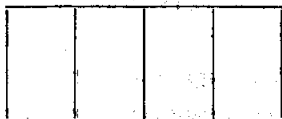

N W S E

NW SW SE NE

Mound of \_\_\_\_\_ is located \_\_\_\_\_

Pits are located \_\_\_\_\_

Sketch markings of Bearing Trees (or Rocks) in proper box and fill blanks below, giving bearings from Corner to Trees and Distances in Links.



Species Tamie sp.

Diameter 7"

Bearing S 47 W ← Don't check with orig.

Distance 9 N 45 E 12 1/2

Do you believe this to be a genuine Land Office Corner? yes

If not, why? \_\_\_\_\_

John A. Guelhaug

(Signature)

Jr. Civil Eng.

(Title)

10/24/38  
(Date)

Corner again.  
 Give any further facts which will aid in finding this  
 0.09 1/2 chains distant.  
 from which this Corner bears S 47° E.  
 side of ~~the~~  
 tree 5 inches diameter, on the SE  
 Metal Location Poster is on a *Tong*

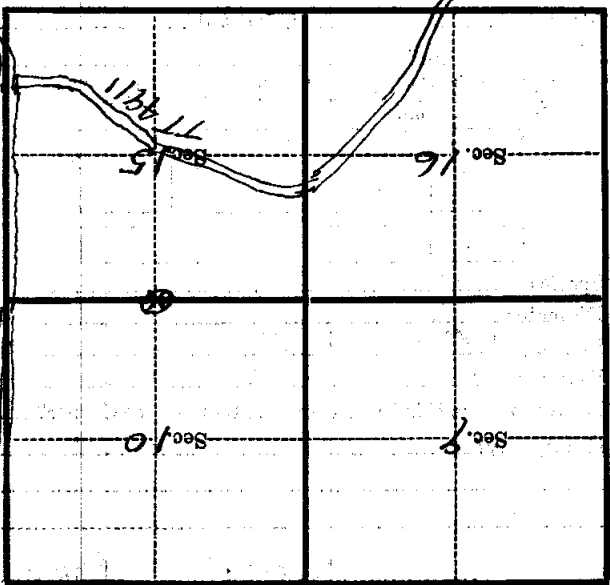

(Make sketch of topography near Corner)

T148N R. 30W. 579P Mer.