

1 of 2

J-9

Form 874-B—Revised May, 1918

U. S. Department of Agriculture

FOREST SERVICE

Chippewa NATIONAL FOREST

CORNERS OF THE PUBLIC SURVEY

T. 148 N. R. 30 W. 5th P. Mer.

Section Corner common to Sections

8, 9, 16, and 17

Corner consists of a Cedar post (not) in place

State condition Good

Dimensions above ground 48 inches

Sketch grooves, letters, figures, or notches, on proper face or edge.

CARDINAL POSITION

DIAGONAL POSITION

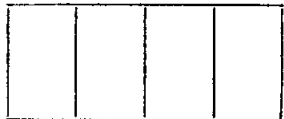

N W S E

NW SW SE NE

Mound of is located

Pits are located

Sketch markings of Bearing Trees (or Rocks) in proper box and fill blanks below, giving bearings from Corner to Trees and Distances in Links.

Only B.T.

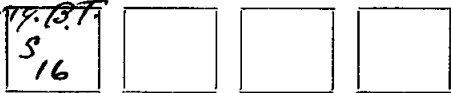

Species Elm

Diameter 22"

Bearing S. 62° E.

Distance 20 1/2

Do you believe this to be a genuine Land Office Corner? yes

If not, why?

K. V. Styler

(Signature)

Leader

(Title)

5/11/38

(Date)

J-9

Corner again.

Give any further facts which will aid in finding this

0.23 chains distant.

from which this Corner bears S 43° W.

side of Tree

tree 24 inches diameter, on the S.W.

Metal Location Poster is on an Elm

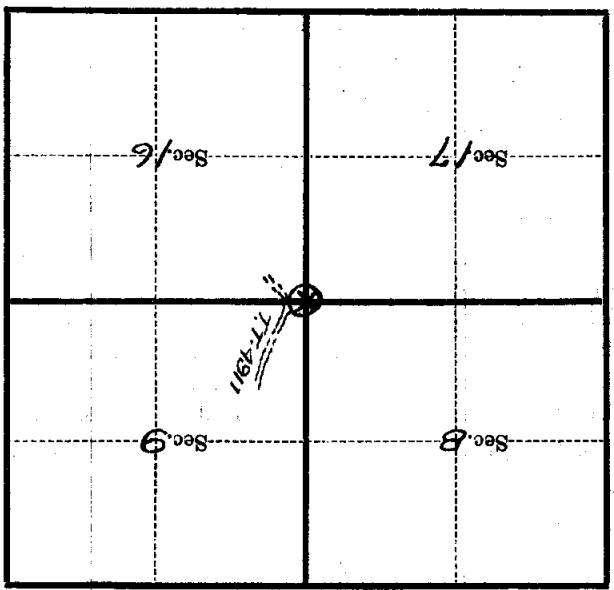

(Make sketch of topography near Corner)

T/4817 R. 30W. Mer. 5-13 P. J-9



(Make sketch of topography near Corner and show section line markers thus "X")

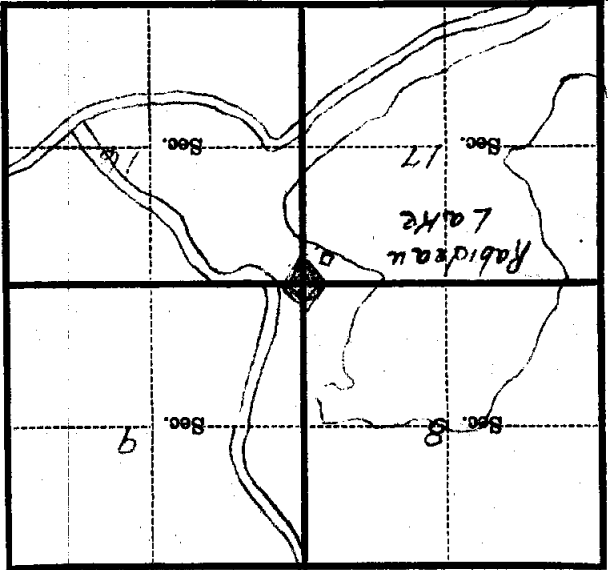

Metal Location Poster is on a Maple (B.T.)

tree 4 inches diameter, on the SE

side of tree

from which this Corner bears S 87 1/2° E, 13.6 Chains.

Section line marker between Secs. and is on

a Post on the 2208

(Tree, post, etc.) located 100 chains E, 1/4 Sec. Cor.; 1/2 Cor.; 1/4 Sec. Cor.

(CROSS OUT NONAPPLICABLE) Give any further facts needed to find Corner again:

COR IS WEST OF CURVE

IN RD # 2208 NORTH OF

PRIVATE RD. LINE BOUND

SOUTH AND EAST TO RDS.

U. S. Department of Agriculture  
FOREST SERVICE

NATIONAL FOREST

CORNERS OF THE PUBLIC SURVEY

T. 148 R. 30 Mer.

sec Corner common to Sections  
8, 9, 17, and 16

Corner consists of a Cement Mon. (not) in place  
State condition New

Dimensions above ground 1 1/2 inches

Sketch grooves, letters, figures, or notches, on proper face or edge.

CARDINAL POSITION

DIAGONAL POSITION

--	--	--	--

--	--	--	--

N W S E

NW SW SE NE

Mound of \_\_\_\_\_ is located \_\_\_\_\_

Pits are located \_\_\_\_\_

Sketch markings of Bearing Trees (or Rocks) in proper box and fill blanks below, giving bearings from Corner to Trees and Distances in Links.

S 8	S 16	S 8	S 16	S 9

Species	<u>Maple</u>	<u>Elm</u>	<u>Maple</u>	<u>Y Birch</u>	<u>Maple</u>
Diameter	<u>13.2</u>	<u>24"</u>	<u>4"</u>	<u>6"</u>	<u>5"</u>
Bearing	<u>N 75 W</u>	<u>S 67 E</u>	<u>N 37 1/2 W</u>	<u>S 15 E</u>	<u>N 43 E</u>
Distance	<u>13.2</u>	<u>14.5</u>	<u>13.6'</u>	<u>16.7</u>	<u>46.7'</u>

Do you believe this to be a genuine Land Office Corner? \_\_\_\_\_

If not, why? \_\_\_\_\_

(Signature)

10-31-58  
(Date)

(Title)

J-9

Metal Location Poster on  
Post along Rd #2508  
Corner again.

Give any further facts which will aid in finding this  
13.6' chains distant.  
from which this Corner bears  
S 37 1/2 E  
side of tree  
4 inches diameter, on the  
Maple SE

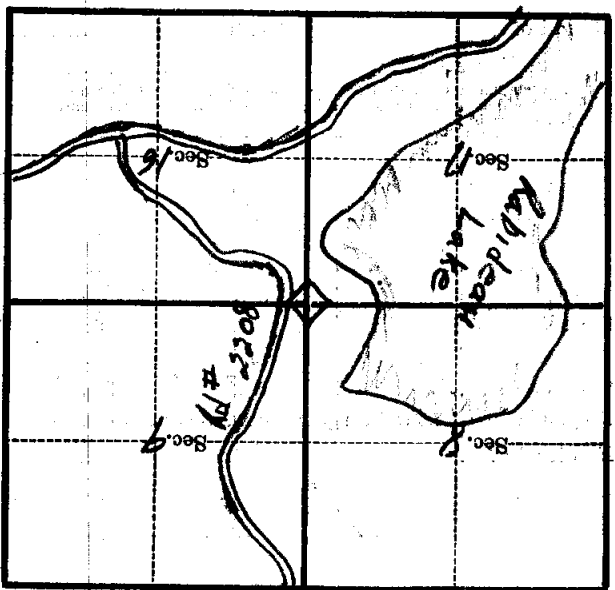

(Make sketch of topography near Corner)

T. 148 R. 20  
5th Mer.

**U. S. Department of Agriculture**

**FOREST SERVICE**

Chippewa NATIONAL FOREST

**CORNERS OF THE PUBLIC SURVEY**

T. 148 N R. 30 W 5<sup>th</sup> Mer.

Section Corner common to Sections

8, 9, 16, and 17

Corner consists of a 6" cement monument with stamped bronze marker (not) in place

State condition Need

Dimensions above ground 18 inches.

Sketch grooves, letters, figures, or notches, on proper face or edge.

STONE CORNERS

METAL CORNERS

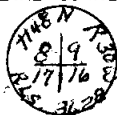
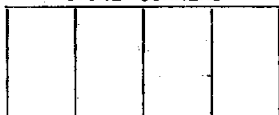

N W S E

Mound of \_\_\_\_\_ is located \_\_\_\_\_

Pits are located \_\_\_\_\_

Sketch markings of Bearing Trees (or Rocks) in proper box and fill blanks below, giving bearings from Corner to Trees and Distances in Links.

S-8

S-16

S-8

S-16

S-9

0719

0719

New

New

New

BT

BT

BT

BT

BT

Species Maple Elm Maple Y. Birch maple

Diameter 13" stub 24" 4" 6" 5"

Bearing N 75 W S 67 E N 37 1/2 W S 15 E N 43 E

Distance 13.2' 14.5' 13.6' 16.7' 46.7'

Do you believe this to be a genuine Land Office Corner? Yes

why? \_\_\_\_\_

Joseph H. Lausche

(Signature)

Engr. Aid

(Title)

Mer. *30 W* *57 1/2*

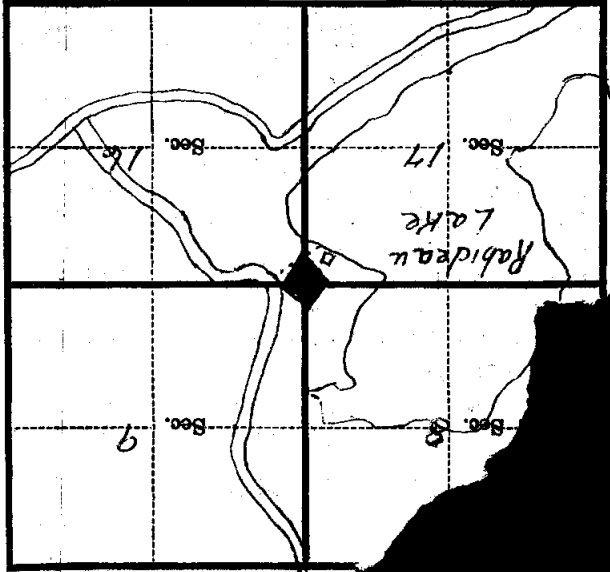

Metal Location Poster is on a *Maple* (B.T.) tree *4* inches diameter, on the *SE* side of *Tree* from which this Corner bears *S 81 1/2 E, 13.1'* Chains. (Bearing) (Distance)

Section line marker between Secs. *17* and *9* is on a *Post* on the *2208* (Tree, post, etc.)

located *100* chains *1, 1/2, 1/4* from Sec. Cor.; *1/2* Cor.; *1/4* Sec. Cor. (Cross out nonapplicable) (Name of road, trail, etc.)

*COR* is west of *CURVE* in *Rd # 2208*, North of *Private Rd*, line *1/2* *3rd* *SOUTH* and *EAST* to *Rds*.

Give any further facts needed to find Corner again:

-----  
 -----  
 -----



Form 874-9—Revised May, 1918  
U. S. Department of Agriculture  
FOREST SERVICE

Chippewa NATIONAL FOREST

CORNERS OF THE PUBLIC SURVEY

T. 148 N. R. 30 W. 5th P. Mer.

Section \_\_\_\_\_ Corner common to Sections  
8, 9, 16, and 17

Corner consists of a Ceder Post (~~not~~) in place

State condition Good

Dimensions above ground 48 inches  
Sketch grooves, letters, figures, or notches, on proper face or edge.

CARDINAL POSITION

DIAGONAL POSITION

--	--	--	--

N W S E

--	--	--	--

NW SW SE NE

Mound of \_\_\_\_\_ is located \_\_\_\_\_

Pits are located \_\_\_\_\_

Sketch markings of Bearing Trees (or Rocks) in proper box and fill blanks below, giving bearings from Corner to Trees and Distances in Links.

Org. B.T. S. 16			
R.T.			

Species Elm

Diameter 22"

Bearing S. 62° E.

Distance 20  $\frac{1}{2}$

Do you believe this to be a genuine Land Office Corner? Yes

If not, why? \_\_\_\_\_

K.V. Styler  
(Signature)

Leader

5/11/38  
(Date)

(Title)

Corner again.

Give any further facts which will aid in finding this

0.23 chains distant.

from which this Corner bears S. 43° W.

side of Tree

tree 24 inches diameter, on the S. W.

Metal Location Poster is on an Elm

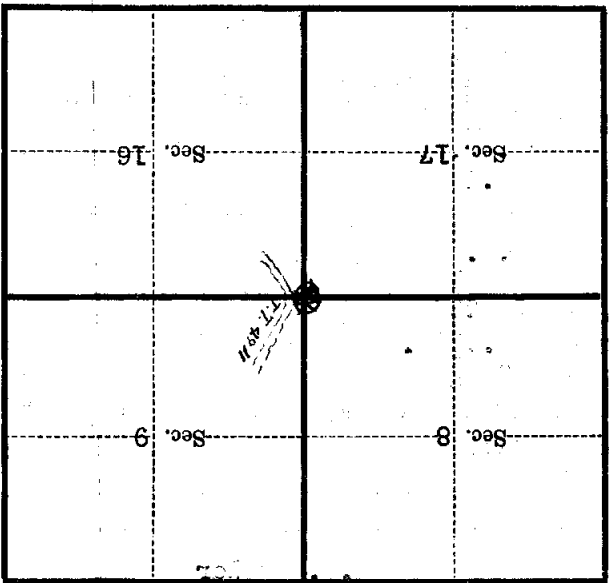

(Make sketch of topography near Corner)

T. 148 N. R. 30 W. 5th P. Mer.