

1 of 3

N-9

Form 874-9—Revised May, 1918

U. S. Department of Agriculture

FOREST SERVICE

Chippewa NATIONAL FOREST

CORNERS OF THE PUBLIC SURVEY

T. 148 N. R. 30 W. 5th Mer.

Section 16, 17, 20, and 21 Corner common to Sections

Corner consists of a Post (not) in place State condition Good

Dimensions above ground 36 inches

Sketch grooves, letters, figures, or notches, on proper face or edge.

CARDINAL POSITION

DIAGONAL POSITION

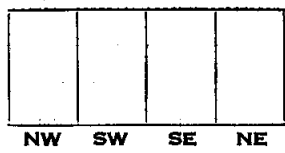
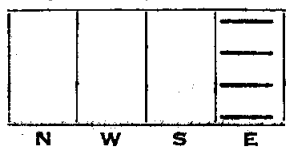

Mound of is located

Pits are located

Sketch markings of Bearing Trees (or Rocks) in proper box and fill blanks below, giving bearings from Corner to Trees and Distances in Links.

148/30			
S 20			
BT			

Species 9

Diameter 16

Bearing SW

Distance 21 links

Do you believe this to be a genuine Land Office Corner? Yes

If not, why?

G. D. Bauch

G. D. Bauch

(Signature)

Junior Forester

1/14/36

(Date)

(Title)

N-9

Metal Location Poster is on a tree \_\_\_\_\_ inches diameter, on the side of \_\_\_\_\_ from which this Corner bears \_\_\_\_\_ chains distant.

Give any further facts which will aid in finding this Corner again.

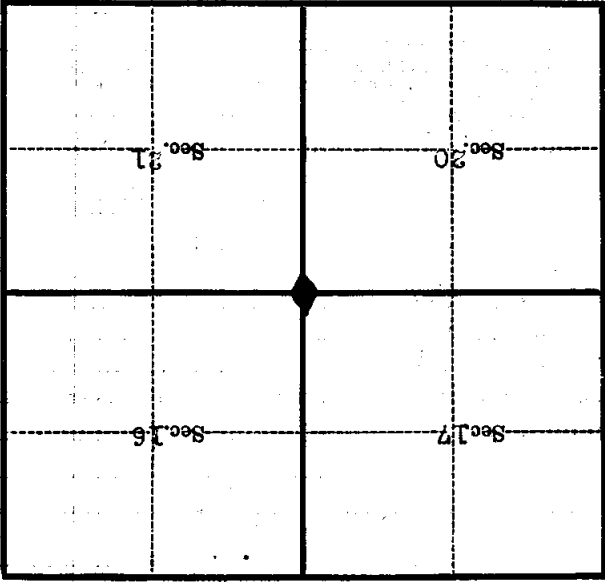

(Make sketch of topography near Corner)

T. 148 N. R. 30 W. lot 3 5th Mer. N-9

U. S. Department of Agriculture

FOREST SERVICE

Chippewa NATIONAL FOREST

CORNERS OF THE PUBLIC SURVEY

T. 148 N. R. 30 W. 5th. P. Mer.

Section Corner common to Sections

16, 17, 20, and 21

Corner consists of a Cedar Post in place

State condition Good

Dimensions above ground 36 inches

Sketch grooves, letters, figures, or notches, on proper face or edge.

CARDINAL POSITION

DIAGONAL POSITION

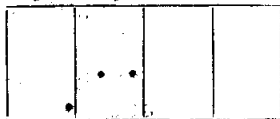
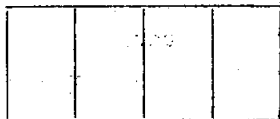

Mound of is located

Pits are located

Sketch markings of Bearing Trees (or Rocks) in proper box and fill blanks below, giving bearings from Corner to Trees and Distances in Links.



Species W. Pine

Diameter 16"

Bearing S. 49° W.

Distance 19

Do you believe this to be a genuine Land Office Corner? Yes

If not, why?

John A. Gjelhaug

(Signature)

11/3/38

(Date)

Jr. Civil Eng.

(Title)

Corner again.

Give any further facts which will aid in finding this

0.19 chains distant.

from which this Corner bears N.49° E.

side of Tree

tree 16 inches diameter, on the N.E.

Metal Location Poster is on a W. Pine

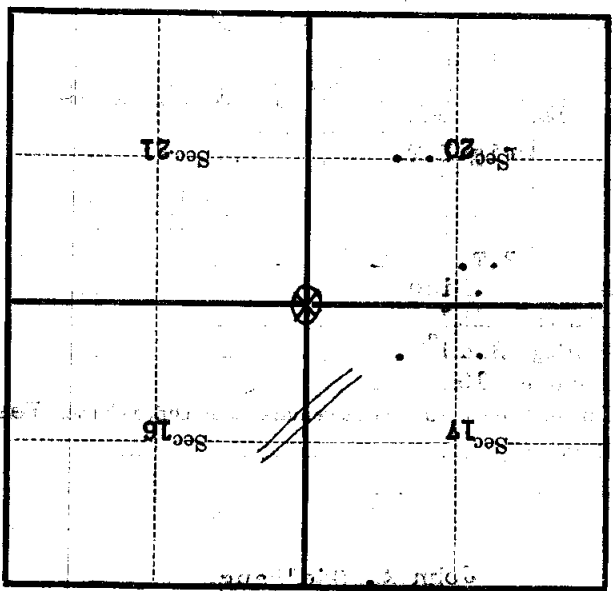

(Make sketch of topography near Corner)

T. 148 N. R. 30 W. S. 5th. P. Mer.

2-0f3

N-9

**U. S. Department of Agriculture**  
**FOREST SERVICE**

Chippewa NATIONAL FOREST

**CORNERS OF THE PUBLIC SURVEY**

T. 148N R. 32W 5<sup>th</sup> Mer.

Section Corner common to Sections  
16, 17, 20, and 21

Corner consists of a 6" concrete monument (not) in place  
stamped bronze marker, State condition New

Dimensions above ground 18 inches.

Sketch grooves, letters, figures, or notches, on proper face or edge.

STONE CORNERS

METAL CORNERS

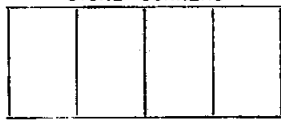

N W S E



Mound of \_\_\_\_\_ is located \_\_\_\_\_

Pits are located \_\_\_\_\_

Sketch markings of Bearing Trees (or Rocks) in proper box and fill blanks below, giving bearings from Corner to Trees and Distances in Links.

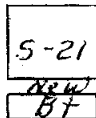
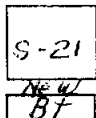
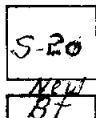
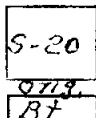

Species	<u>W. Pine</u>	<u>Basswood</u>	<u>Elm</u>	<u>Cedar</u>
Diameter	<u>23"</u>	<u>7"</u>	<u>12"</u>	<u>10"</u>
Bearing	<u>S47W</u>	<u>S46W</u>	<u>S43E</u>	<u>S89<math>\frac{1}{2}</math>E</u>
Distance	<u>73'</u>	<u>30.5'</u>	<u>36.5'</u>	<u>58.5'</u>

Do you believe this to be a genuine Land Office Corner? Yes  
If not, why? \_\_\_\_\_

Joseph F. Lausecke  
(Signature)

10-24-58  
(Date)

Surveyor  
(Title)

T. 148 N. R. 30 W. Mer. 3 of 3 N-9

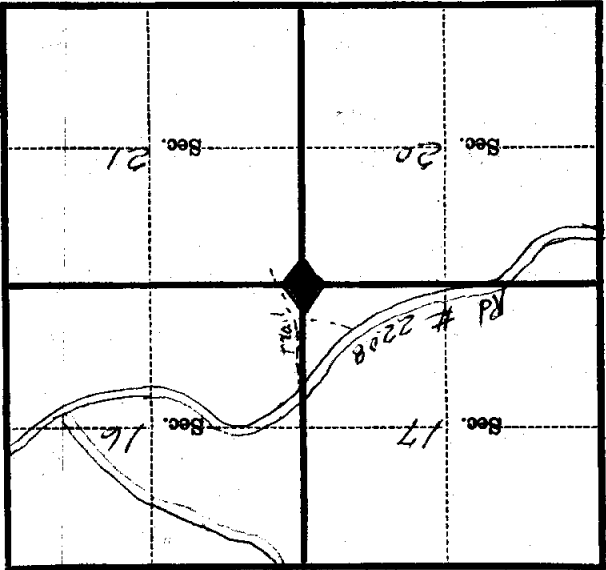

(Make sketch of topography near Corner and show section line markers thus "X")

Metal Location Poster is on a W. PINE CRG. BT. tree 23 inches diameter, on the NE side of Tree from which this Corner bears N 47 E, 73' Chains. Section line marker between Secs.      and      is on a      on the      (Tree, post, etc.) (Name of road, trail, etc.) located chains E, W, N, S, from Sec. Cor.; 1/4 Cor.; Witness Cor. (Cross out nonapplicable) Give any further facts needed to find Corner again:

Tag on tree is visible from trail approx 35' East of CAR.

Trail is not passable by Car.

Form 874-9—Revised May, 1918  
U. S. Department of Agriculture  
FOREST SERVICE

Chippewa NATIONAL FOREST

CORNERS OF THE PUBLIC SURVEY

T. 148N. R. 30W 522P Mer.

Section Corner common to Sections

16, 17, 20, and 21

Corner consists of a Cedar Post (~~not~~) in place

State condition Good

Dimensions above ground 36 inches

Sketch grooves, letters, figures, or notches, on proper face or edge.

CARDINAL POSITION

DIAGONAL POSITION

N	W	S	E

NW	SW	SE	NE

Mound of \_\_\_\_\_ is located \_\_\_\_\_

Pits are located \_\_\_\_\_

Sketch markings of Bearing Trees (or Rocks) in proper box and fill blanks below, giving bearings from Corner to Trees and Distances in Links.

<u>Orig. BT.</u>			
------------------	--	--	--

<u>BT.</u>	<u>Orig. notes</u>	
------------	--------------------	--

Species W. Pine J. Pine

Diameter 16" 4"

Bearing S 49° W. S 47° W.

Distance 19 11

Do you believe this to be a genuine Land Office Corner? Yes

If not, why? \_\_\_\_\_

John A. Gethung

(Signature)

Jr. Civil Eng.

(Title)

11/3/38

(Date)

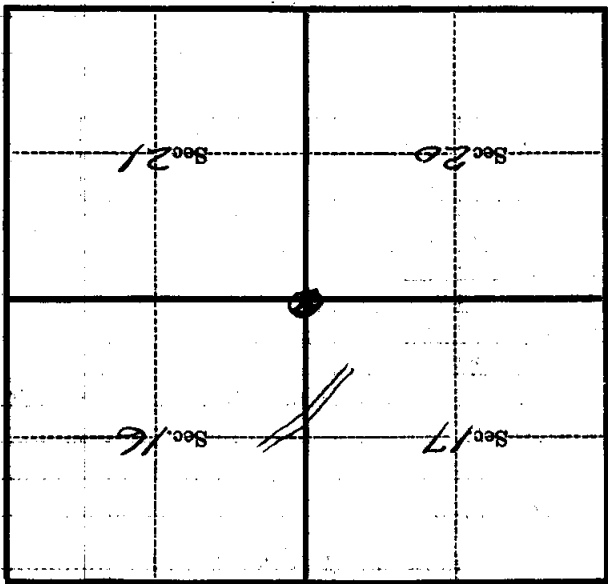

(Make sketch of topography near Corner)

T/148N. R. 30W. 5TH P Mer.

Metal Location Poster is on a *W.P.M.*  
 tree *16* inches diameter, on the *N.E.*  
 side of *Tree*  
 from which this Corner bears *0.19*  
 chains distant.

Give any further facts which will aid in finding this  
 Corner again.



Form 874-9—Revised May, 1918  
 U. S. Department of Agriculture  
 FOREST SERVICE

Chippewa NATIONAL FOREST

CORNERS OF THE PUBLIC SURVEY

T. 148 N. R. 30 W. 5th. P. Mer.

Section \_\_\_\_\_ Corner common to Sections

16, 17, 20, and 21

Corner consists of a Cedar Post (~~rock~~) in place

State condition Good

Dimensions above ground 36 inches

Sketch grooves, letters, figures, or notches, on proper face or edge.

CARDINAL POSITION

DIAGONAL POSITION



N W S E



NW SW SE NE

Mound of \_\_\_\_\_ is located \_\_\_\_\_

Pits are located \_\_\_\_\_

Sketch markings of Bearing Trees (or Rocks) in proper box and fill blanks below, giving bearings from Corner to Trees and Distances in Links.



Species W. Pine

Diameter 16"

Bearing S. 49° W.

Distance 19

Do you believe this to be a genuine Land Office Corner? Yes

If not, why? \_\_\_\_\_

John A. Gjelhaug  
 (Signature)

11/3/38  
 (Date)

Jr. Civil Eng.  
 (Title)

N-9

*Handwritten notes and scribbles at the top of the page.*

Corner again.

Give any further facts which will aid in finding this  
chains distant. **0.18**  
from which this Corner bears **N. 69° E.**  
side of **tree**  
tree **12** inches diameter, on the **N.E.**  
Metal Location Poster is on a **W. Pine**

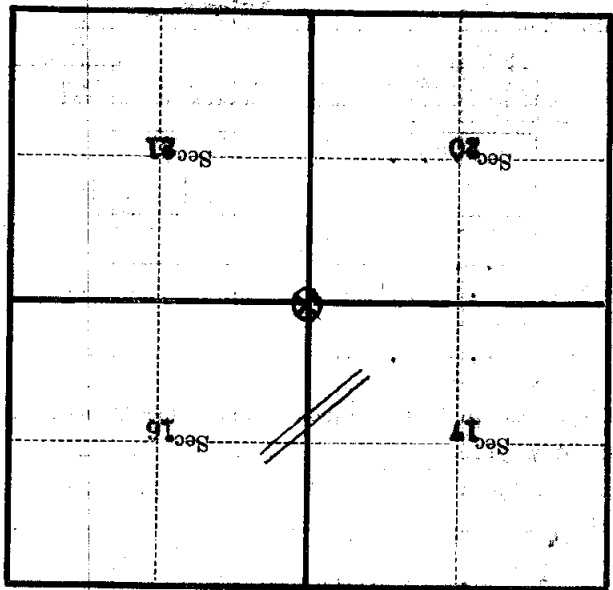

(Make sketch of topography near Corner)

T. 148 N. R. 50 W. S. 10 E. Mer.

**U. S. Department of Agriculture**

**FOREST SERVICE**

Chippewa NATIONAL FOREST

**CORNERS OF THE PUBLIC SURVEY**

T. 148N R. 30W Mer. 5<sup>th</sup>

Section Corner common to Sections  
16, 17, 20, and 21

Corner consists of a 6" concrete <sup>MONUMENT WITH</sup> (not) in place  
stamped bronze marker. <sup>NEW</sup>  
State condition

Dimensions above ground 18 inches.

Sketch grooves, letters, figures, or notches, on proper face or edge.

STONE CORNERS

METAL CORNERS



Mound of \_\_\_\_\_ is located \_\_\_\_\_

Pits are located \_\_\_\_\_

Sketch markings of Bearing Trees (or Rocks) in proper box and fill blanks below, giving bearings from Corner to Trees and Distances in Links.

S-20	S-20	S-21	S-21
NEW	NEW	NEW	NEW
BT	BT	BT	BT

Species	W. PINE	Basswood	Elm	Cedar
Diameter	23"	7"	12"	10"
Bearing	S47W	S46W	S43E	S89½E
Distance	7.3'	30.5'	36.5'	59.5'

Do you believe this to be a genuine Land Office Corner? YES

If not, why? \_\_\_\_\_

*Joseph F. Lusche*

(Signature)

10-24-58  
(Date)

*Eng. R. D.*  
(Title)

T. 148 N. R. 30 W. Mer. 5th

(Make sketch of topography near Corner and show section line markers thus "X")

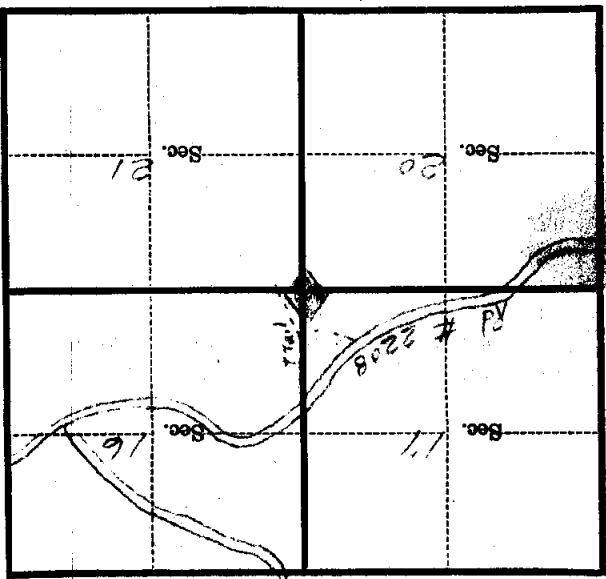

Metal Location Poster is on a W. Pine 0mg. Bt. tree 3 inches diameter, on the NE side of Tree

from which N. 73° E this Corner bears 73 (Bearing) and Chains (Distance) is on

Section line marker between Secs.      and      is on      on the     

located (Tree, post, etc.)      chains      W., N., S., from Sec. Cor.;  $\frac{1}{4}$  Cor.; Witness Cor. (Cross out nonapplicable)

Give any further facts needed to find Corner again:

Tag on tree is visible from trail approx 35 East of car

Trail is not possible by car