

Section Corners Sec. 29-30-31-32 ²⁰⁸

T 148N R 30W Mer. 5th

Corner is
a post.

Height

Dia

Marked not
legible.

BEARING TREES

Marks B.T.

Species Cedar

Diameter 10"

Bearing N5°W.

District

Metal poster on

Remarks:

Date 11/28/33 Signed J. A. Gickney

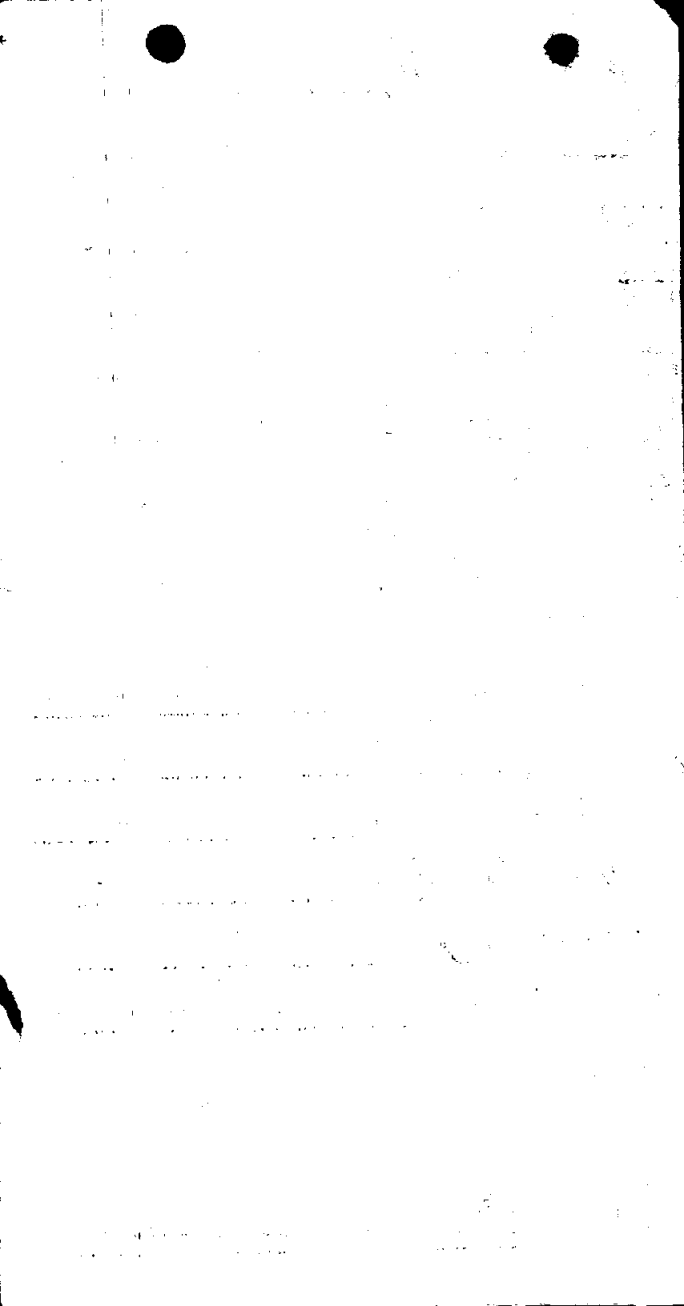

1072

V-5

Form 874-9—Revised May, 1918

U. S. Department of Agriculture

FOREST SERVICE

Chippewa NATIONAL FOREST

CORNERS OF THE PUBLIC SURVEY

T. 148 N R. 30 5th P. Mer.

Section Corner common to Sections

29, 30, 31, and 32

Corner consists of a Cedar post (not) in place

State condition Good

Dimensions above ground 50 inches

Sketch grooves, letters, figures, or notches, on proper face or edge.

CARDINAL POSITION

DIAGONAL POSITION

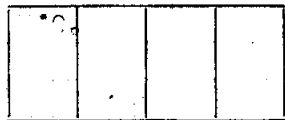
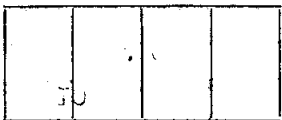

Mound of is located

Pits are located

Sketch markings of Bearing Trees (or Rocks) in proper box and fill blanks below, giving bearings from Corner to Trees and Distances in Links.

Orig. B.T.

Marked new B.T.

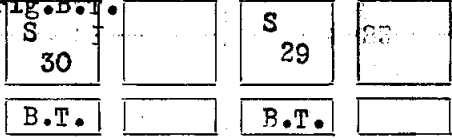

Species Cedar Aspen

Diameter 6" 9"

Bearing N. 40° W N. 54° E

Distance .09 .42

Do you believe this to be a genuine Land Office Corner? Yes

If not, why?

John A. Gjelhaug

(Signature)

Jr. Civil Engineer

12/9/38

(Date)

(Title)

V-5

T. 148 N. R. 30 W. 5th P. Mer. V-5

(Make sketch of topography near Corner)

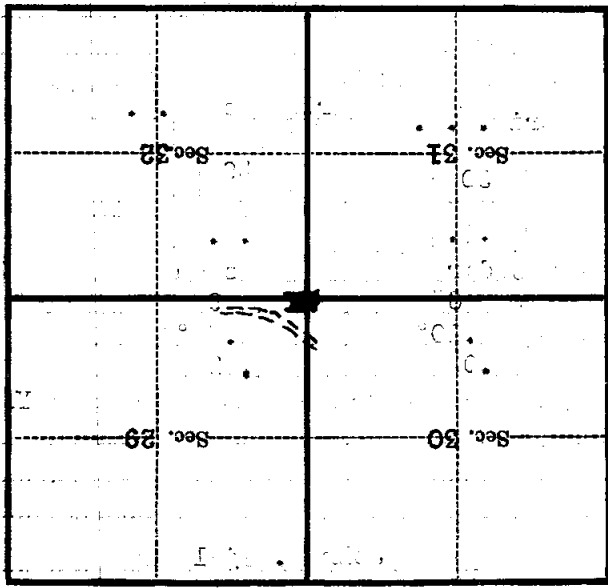

Metal Location Poster is on a Baln of Gilhead

tree 10 inches diameter, on the North

side of tree

from which this Corner bears N.6°E

0.10 chains distant.

Give any further facts which will aid in finding this

Corner again.

U. S. Department of Agriculture
FOREST SERVICE

Chippewa NATIONAL FOREST

CORNERS OF THE PUBLIC SURVEY

T. 148 N R. 30 W 5th Mer.

Section 29 Corner common to Sections
29, 30, 31, and 32

Corner consists of a 2" Pipe with Brass cap (not) in place
State condition NEW

Dimensions above ground 1.8 inches.

Sketch grooves, letters, figures, or notches, on proper face or edge.

STONE CORNERS

METAL CORNERS

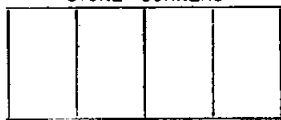

N W S E



Mound of _____ is located _____

Pits are located _____

Sketch markings of Bearing Trees (or Rocks) in proper box and fill blanks below, giving bearings from Corner to Trees and Distances in Links.

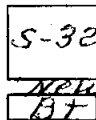
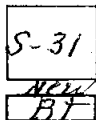
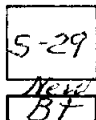
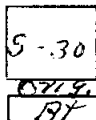

Species	<u>Cedar</u>	<u>Cedar</u>	<u>Cedar</u>	<u>Cedar</u>
Diameter	<u>8</u>	<u>9"</u>	<u>9"</u>	<u>9"</u>
Bearing	<u>N. 32 W</u>	<u>N. 18 E</u>	<u>S. 63 W</u>	<u>S. 2 1/2 E</u>
Distance	<u>26.1'</u>	<u>42.0'</u>	<u>19.0'</u>	<u>25.8'</u>

Do you believe this to be a genuine Land Office Corner? Yes.
If not, why? _____

Joseph F. Lausche

(Signature)

10-23-58

(Date)

Engl. Aid

(Title)

(Make sketch of topography near Corner and show section line markers like "X")

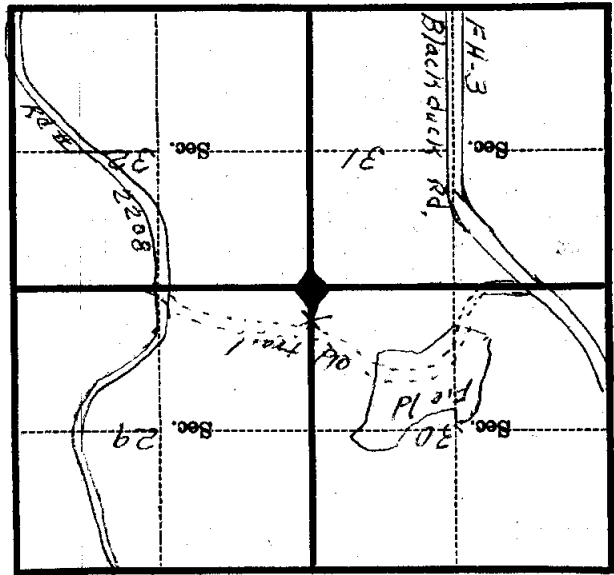

Metal Location Poster is on a Cedar

tree 9 inches diameter, on the N.E

side of Tree

from which this Corner bears N 43 E, 19.0' Chains.

(Bearing) (Distance)

Section line marker between Secs. 29 and 30 is on

a 12" ASPEN on the OLD TRAIL

(Tree, post etc.) (Name of road, trail, etc.)

located 300' chains 1/4 N, 8' from Sec. Cor.; 1/4 Cor. 1/4 from Cor.

(Cross out nonapplicable)

Give any further facts needed to find Corner again:

I blazed line north to old trail put poster on aspen

South side of trail, Approx

300 FT N. of Cor.

U. S. Department of Agriculture

FOREST SERVICE

Chippewa NATIONAL FOREST

CORNERS OF THE PUBLIC SURVEY

T. 148N. R. 30W. 5th P. Mer.

Section 1 Corner common to Sections

29, 30, 31, and 32

Corner consists of a Cedar Post (~~not~~) in place

State condition Good

Dimensions above ground 50 inches

Sketch grooves, letters, figures, or notches, on proper face or edge.

CARDINAL POSITION

DIAGONAL POSITION

--	--	--	--

N W S E

--	--	--	--

NW SW SE NE

Mound of _____ is located _____

Pits are located _____

Sketch markings of Bearing Trees (or Rocks) in proper box and fill blanks below, giving bearings from Corner to Trees and Distances in Links.

BT 30		Marked New BT S 29	
BT		BT	

Species Cedar Cedar ASPEN Cedar

Diameter 6" 7" 9" 7"

Bearing N. 90° W. N. 32° W. N. 54° E. S. 41° W.

Distance .09 32 42 1.2 links

Do you believe this to be a genuine Land Office Corner? Yes

If not, why? _____

John A. Gielhang

(Signature)

12/9/38
(Date)

Jr. Civil Eng.
(Title)

V-5

Corner again.
Give any further facts which will aid in finding this

chains distant. 0.10

from which this Corner bears ~~N 6° E~~

side of ~~Tree~~

tree 10 inches diameter, on the ~~North~~

Metal Location Poster is on a *Balm of Gilead*

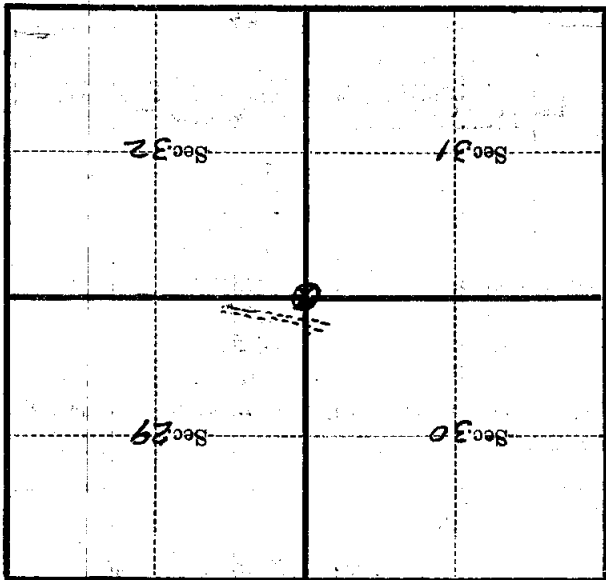

(Make sketch of topography near Corner)

T. 198N. R. 30W. S13 P. Mer.

U. S. Department of Agriculture
FOREST SERVICE

~~Chippewa~~ NATIONAL FOREST

CORNERS OF THE PUBLIC SURVEY

T. 148N R. 30W 5th Mer.

~~Section~~ Corner common to Sections
29, 30, 31, and 32

Corner consists of a 2" PIPE WITH Brass cap (net) in place

State condition NEW

Dimensions above ground 18 inches.

Sketch grooves, letters, figures, or notches, on proper face or edge.

STONE CORNERS

METAL CORNERS

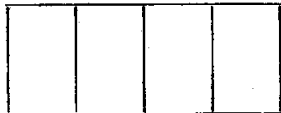

N W S E

Mound of _____ is located _____

Pits are located _____

Sketch markings of Bearing Trees (or Rocks) in proper box and fill blanks below, giving bearings from Corner to Trees and Distances in Links.

S-30

S-29

S-31

S-32

NEW
BT

NEW
BT

NEW
BT

NEW
BT

Species Cedar Cedar Cedar Cedar

Diameter 8" 9" 9" 9"

Bearing N 32 W N 18 E S 63 W S 2 1/2 E

Distance 211' 420' 190' 258'

Do you believe this to be a genuine Land Office Corner? Yes.

If not, why? _____

Joseph L. Lusche
(Signature)

10-23-58
(Date)

Surveyor
(Title)

T. 140N R. 30W Mer. 57

(Make sketch of topography near Corner and show section line markers thus "X")

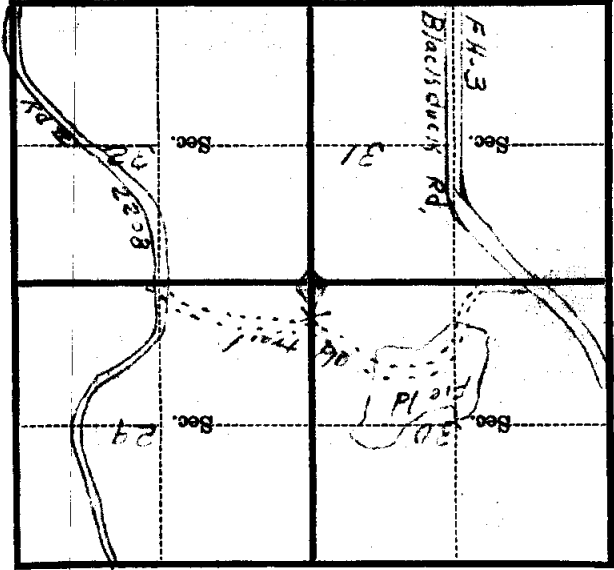

Metal Location Poster is on a cedar tree 9 inches diameter, on the N.E. side of Twp

from which this Corner bears N 63 E, 19.0 chains.

(Bearing) (Distance) Section line marker between Secs. 29 and 30 is on a 12" Aspen on the old trail

(Tree, post, etc.) (Name of road, trail, etc.) located 300 chains N. W. N. S. from Sec. Cor.; 1/4 Cor.; 1/2 Sec. Cor.

(Cross out nonapplicable)

Give any further facts needed to find Corner again:

I blazed line north to old trail put poster on aspen south side of trail, approx 300 ft N. of cor.