

Form 874-9—Revised May, 1918  
 U. S. Department of Agriculture  
 FOREST SERVICE

N5

Chippewa NATIONAL FOREST  
 CORNERS OF THE PUBLIC SURVEY

T. 148 N R. 29 W 5 Mer.  
SECTION Corner common to Sections  
18, 19, 17, and 20

Corner consists of a \_\_\_\_\_ (not) in place  
 State condition \_\_\_\_\_

Dimensions above ground \_\_\_\_\_ inches  
 Sketch grooves, letters, figures, or notches, on proper face or edge.

CARDINAL POSITION

DIAGONAL POSITION

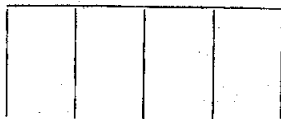
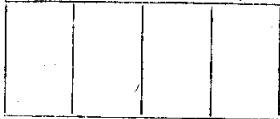

N W S E

NW SW SE NE

Mound of \_\_\_\_\_ is located \_\_\_\_\_

Pits are located \_\_\_\_\_

Sketch markings of Bearing Trees (or Rocks) in proper box and fill blanks below, giving bearings from Corner to Trees and Distances in Links.

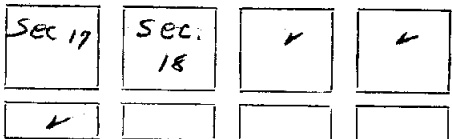

Species BURNED BURNED

Diameter STUMP STUMP

Bearing NORTH WEST

Distance 1 ch. 30 lks.

Do you believe this to be a genuine Land Office Corner? yes

If not, why? \_\_\_\_\_

S. Zimmerman  
 (Signature)

3/2/35  
 (Date)

Estimator  
 (Title)

Corner again.  
 Give any further facts which will aid in finding this  
 30 LINKS chains distant.  
 from which this Corner bears WEST.  
 side of STUMP  
 tree 14 inches diameter, on the S.E.  
 Metal Location Poster is on a STUMP (burned)

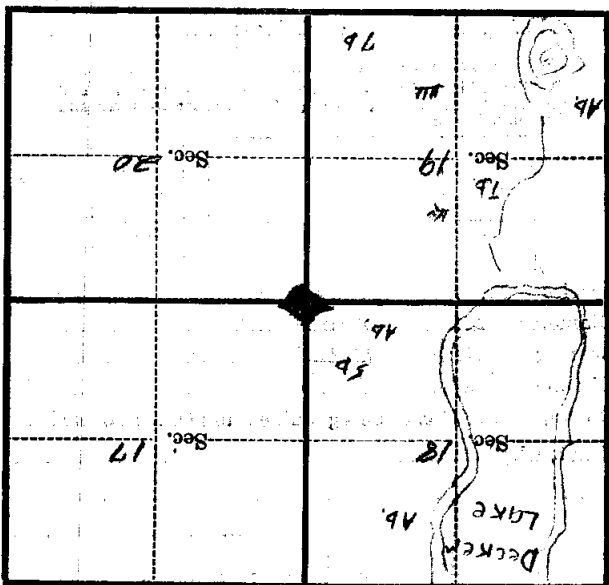

(Make sketch of topography near Corner)

T. 148 R. 29 Mer. 5

## U. S. Department of Agriculture

FOREST SERVICE

N5

Chippewa NATIONAL FOREST

## CORNERS OF THE PUBLIC SURVEY

T. 148 N. R. 29 W. 5th. P. Mer.  
Section Corner common to Sections

17, 18, 19, and 20

Corner consists of a Tam'c. Post ~~rock~~ in place  
State condition Good

Dimensions above ground 40 inches

Sketch grooves, letters, figures, or notches, on proper face or edge.

CARDINAL POSITION

DIAGONAL POSITION

N	W	S	E

NW	SW	SE	NE

Mound of \_\_\_\_\_ is located \_\_\_\_\_

Pits are located \_\_\_\_\_

Sketch markings of Bearing Trees (or Rocks) in proper box and  
fill blanks below, giving bearings from Corner to Trees and  
Distances in Links.

Orig. B. Ts.	
--------------	--

--

Mod. New B.T.
S 19

B.T.
------

B.T.
------

--

B.T.
------

Species N. Pine Stp. N. Pine Stp. Spruce

Diameter 18" 10" 5"

Bearing N. 62° W. N. 2° E. S. 3° W.

Distance 53 156 51

Do you believe this to be a genuine Land Office Corner? Yes

If not, why? \_\_\_\_\_

John A. Gjelhaug

(Signature)

11/29/39

(Date)

Jr. Civil Eng.

(Title)

Corner again.

Give any further facts which will aid in finding this

0.51 chains distant.

from which this Corner bears N. 3° E.

side of tree

tree 5 inches diameter, on the North

Metal Location Poster is on a Spruce

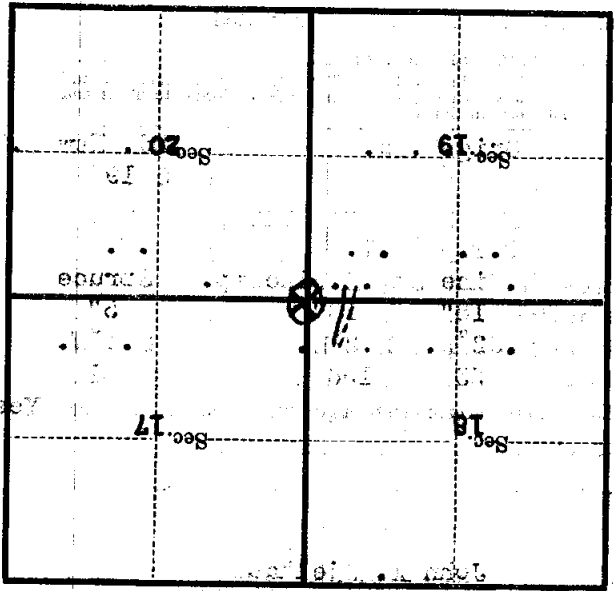

(Make sketch of topography near Corner)

Form 974-9—Revised May, 1918  
 U. S. Department of Agriculture  
 FOREST SERVICE

N 5

Chippewa NATIONAL FOREST

CORNERS OF THE PUBLIC SURVEY

T. 148 N R. 29 W 5 Mer.

SECTION Corner common to Sections  
 18, 19, 17, and 20

Corner consists of a \_\_\_\_\_ (not) in place  
 State condition \_\_\_\_\_

Dimensions above ground \_\_\_\_\_ inches

Sketch grooves, letters, figures, or notches, on proper face or edge.

CARDINAL POSITION

DIAGONAL POSITION

--	--	--	--

N W S E

--	--	--	--

NW SW SE NE

Mound of \_\_\_\_\_ is located \_\_\_\_\_

Pits are located \_\_\_\_\_

Sketch markings of Bearing Trees (or Rocks) in proper box and fill blanks below, giving bearings from Corner to Trees and Distances in Links.

Sec 17	Sec 18	✓	✓
✓			

Species Buried Buried

Diameter STUMP STUMP

Bearing NORTH WEST

Distance 1 ch. 30 lbs.

Do you believe this to be a genuine Land Office Corner? yes

If not, why? \_\_\_\_\_

[Signature]

(Signature)

3/2/35  
 (Date)

[Title]  
 (Title)

Corner again.

Give any further facts which will aid in finding this

30 LINKS chains distant.

from which this Corner bears WEST

side of STUMP

tree 14 inches diameter, on the S.E.

Metal Location Poster is on a Stump (burned)

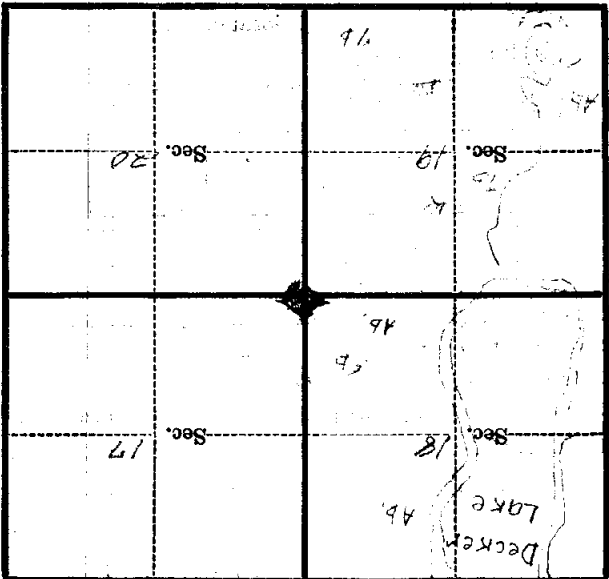

(Make sketch of topography near Corner)