

525

U. S. Department of Agriculture
FOREST SERVICE

posted

Chippewa NATIONAL FOREST

CORNERS OF THE PUBLIC SURVEY

T. 148N R. 28W 5th. Mer.
Section Corner common to Sections

12, 7, 13, and 18

Corner consists of a Cedar Post (not) in place

State condition Placed by lineal crew.

Dimensions above ground 30" inches

Sketch grooves, letters, figures, or notches, on proper face or edge.

CARDINAL POSITION

DIAGONAL POSITION

--	--	--	--

S	40Ch	S	S
12	S to	18	7
	7/4		
	13/18		

N W S E

NW SW SE NE

Mound of _____ is located _____

Pits are located _____

Sketch markings of Bearing Trees (or Rocks) in proper box and fill blanks below, giving bearings from Corner to Trees and Distances in Links.

Illegible		T-148N R-28W S-13	Cut off.
		B.T.	B.T.

Species Tam. Cedar.
 Diameter 6" 4" 6" stump
 Bearing N 42° W S 90° W N 71° W
 Distance 0.20 0.12 0.19 chains

Do you believe this to be a genuine Land Office Corner? Yes
If not, why?

A. H. Jager
(Signature)

Chief of party
(Title)

4/16/35
(Date)

5-25

Metal Location Poster is on a Fence Post
 tree inches diameter, on the South
 side of post
 from which this Corner bears
 S 11° E
 0.15 chains distant.
 Give any further facts which will aid in finding this
 Corner again.
 There is a fence corner 15 links
 North of post.

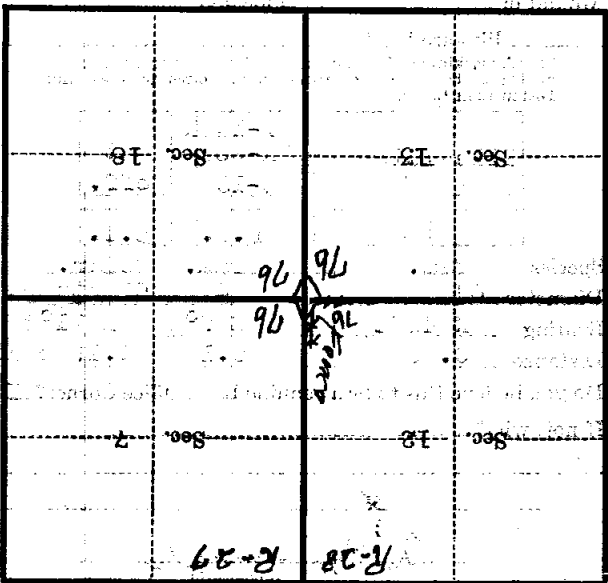

(Make sketch of topography near Corner)

U. S. Department of Agriculture
FOREST SERVICE

J-25

Chippewa National Forest
CORNERS OF THE PUBLIC SURVEY

T. 148 N R. 29 W S 14 Mer.

Section 7 Corner common to Sections
12, 7, 13, and 18

Corner consists of a cedar post (not) in place

State condition Placed by Lincal Crew

Dimensions above ground 30 inches

Sketch grooves, letters, figures, or notches, on proper face or edge.

CARDINAL POSITION

DIAGONAL POSITION

--	--	--	--

N W S E

S 12	40 ch 37 4 1/2	S 13	S 7
---------	-------------------------	---------	--------

NW SW SE NE

Mound of _____ is located _____

Pits are located _____

Sketch markings of Bearing Trees (or Rocks) in proper box and fill blanks below, giving bearings from Corner to Trees and Distances in Links.

illegible

T148N
R29W
S14

Cut
off

B.T.

B.T.

Species Tam. Tam. C.S.H.

Diameter 8" 4" 6"

Bearing N42°W 32°W N71°W

Distance 20 Links 12 Links 19 Links

Do you believe this to be a genuine Land Office Corner? **YES**

If not, why? _____

A. H. Jones (Signature)

4/11/35 (Date)

Forest Party (Title)

Faint, illegible text at the top of the page, possibly bleed-through from the reverse side.

There is a fence corner
15.417ms NORTH OF POST.
Corner again.

Give any further facts which will aid in finding this
15.417ms distant.
from which this Corner bears S 11° E
side of P-1
tree inches diameter, on the S 87° E
Metal Location Poster is on a Fence Post.

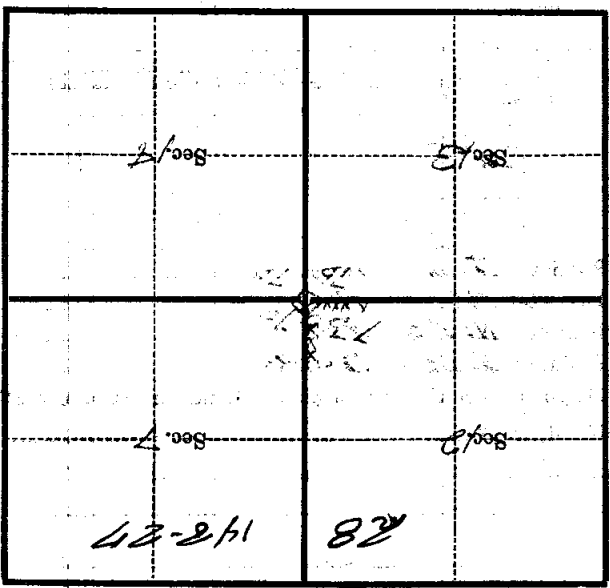

(Make sketch of topography near Corner)

Form 874-9—Revised May, 1918
 U. S. Department of Agriculture
 FOREST SERVICE

J-25

Chippewa NATIONAL FOREST
 CORNERS OF THE PUBLIC SURVEY

T. 148N R. 28W 5th Mer.

Sectional Corner common to Sections
 12, 7, 13, and 18

Corner consists of a Cedar post (not) in place
 State condition new

Dimensions above ground 30 inches

Sketch grooves, letters, figures, or notches, on proper face or edge.

CARDINAL POSITION

DIAGONAL POSITION

--	--	--	--

N W S E

--	--	--	--

NW SW SE NE

Mound of _____ is located _____

Pits are located _____

Sketch markings of Bearing Trees (or Rocks) in proper box and fill blanks below, giving bearings from Corner to Trees and Distances in Links.

	T148 828 513		
	BT	BT	

Species Tan Tan Cedar

Diameter 8" 8" Stump

Bearing N42°W S9°W N71°W

Distance 20 92 19

Do you believe this to be a genuine Land Office Corner? yes

If not, why? _____

4/16/35
 (Date)

(Signature)

(Title)

Faint, illegible text on the top half of the page, possibly bleed-through from the reverse side.

Corner again.
Give any further facts which will aid in finding this
chain distant.
from which this Corner bears
side of
tree inches diameter, on the
Metal Location Poster is on a

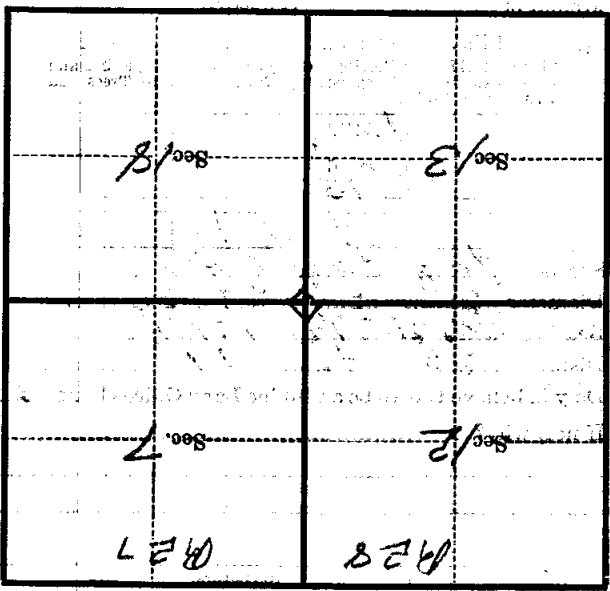

(Make sketch of topography near Corner)

Form 574-0—Revised May, 1915
 U. S. Department of Agriculture
 FOREST SERVICE

J-25

Chippewa NATIONAL FOREST

CORNERS OF THE PUBLIC SURVEY

T. 148N R. 28W 5th Mer.

SECTION Corner common to Sections
 12, 7, 13, and 18

Corner consists of a ~~Cedar post~~ in place
 State condition new

Dimensions above ground 30" inches

Sketch grooves, letters, figures, or notches, on proper face or edge.

CARDINAL POSITION

DIAGONAL POSITION

N	W	S	E

NW	SW	SE	NE

Mound of _____ is located _____

Pits are located _____

Sketch markings of Bearing Trees (or Rocks) in proper box and fill blanks below, giving bearings from Corner to Trees and Distances in Links.

	T148 R28 S13		
	BT	BT	

Species Top Cedar
 Diameter 8 8 5 to mp
 Bearing N42°59'W N71°0'W
 Distance 20 92 19

Do you believe this to be a genuine Land Office Corner? yes
 If not, why? _____

4/16/35
 (Date)

(Signature)

(Title)

Faint, illegible text on the top half of the page, possibly bleed-through from the reverse side.

Corner again.

Give any further facts which will aid in finding this
chain's distant.
from which this Corner bears
side of
tree inches diameter, on the
Metal Location Poster is on a

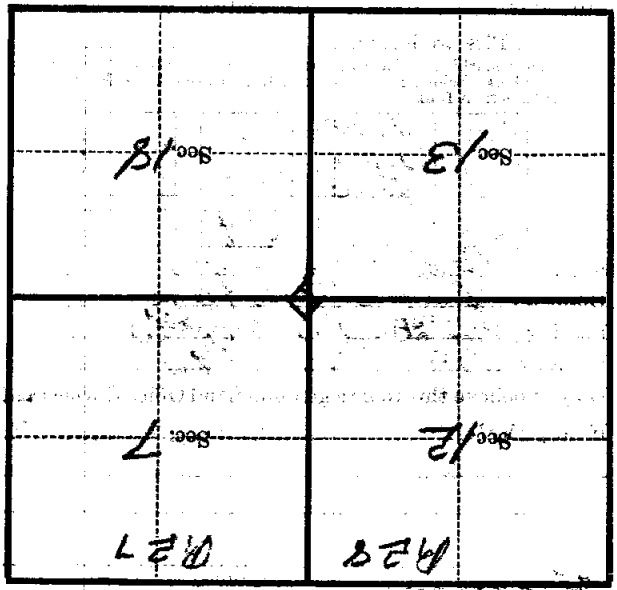

(Large sketch of topography near Corner)