

U. S. Department of Agriculture
FOREST SERVICE

N 13
P.

Chippewa NATIONAL FOREST

CORNERS OF THE PUBLIC SURVEY

T. 148N R. 28W 5th Mer.

Corner common to Sections

16, 15, 21, and 22

Corner consists of a Pine Post (not) in place

State condition Rotted

Dimensions above ground 24" inches

Sketch grooves, letters, figures, or notches, on proper face or edge.

CARDINAL POSITION

DIAGONAL POSITION

--	--	--	--

N W S E

S16	S21	S22	15
-----	-----	-----	----

NW SW SE NE

Mound of _____ is located _____

Pits are located _____

Sketch markings of Bearing Trees (or Rocks) in proper box and fill blanks below, giving bearings from Corner to Trees and Distances in Links.

--	--	--	--

B.T.	B.T.		
------	------	--	--

Species Birch Elm

Diameter 16 17

Bearing N69W N84 E

Distance 30 Lks 60 Lks

Do you believe this to be a genuine Land Office Corner? Yes

If not, why? _____

W. Emmert

(Signature)

6/18/35

Chief of party

(Date)

(Title)

N-13

Corner again.

Give any further facts which will aid in finding this

30 LKS chains distant.

From which this Corner bears

side of

tree 16 inches diameter, on the N. E.

Sketch

Metal Location Poster is on a

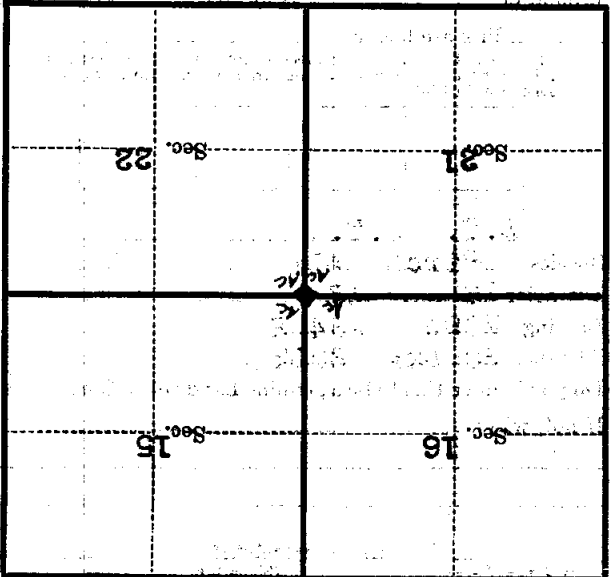

(Make sketch of topography near Corner)

U. S. Department of Agriculture

FOREST SERVICE

N-13

Chippewa NATIONAL FOREST

CORNERS OF THE PUBLIC SURVEY

T. 14 S R. 2 S 5th Mer.

Sec. Corner common to Sections
15, 16, 21, and 22

Corner consists of a Cedar (~~not~~) in place

State condition Old - Rotted

Dimensions above ground 25 inches

Sketch grooves, letters, figures, or notches, on proper face or edge.

CARDINAL POSITION

DIAGONAL POSITION

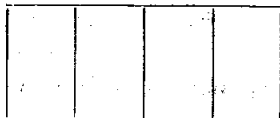

N W S E

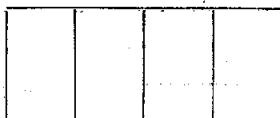

NW SW SE NE

Mound of _____ is located _____

Pits are located _____

Sketch markings of Bearing Trees (or Rocks) in proper box and fill blanks below, giving bearings from Corner to Trees and Distances in Links.



Species Birch Elm Oak

Diameter 12" 10" 8"

Bearing N. 70° W N. 85° W S. 39° W

Distance .31 .60 .43

Do you believe this to be a genuine Land Office Corner? No

If not, why? Corner by County Surveyor

Different B.T.s sketched

Palmer

(Signature)

10/25/36

(Date)

(Title)

63

Corner again.

Give any further facts which will aid in finding this

chains distant.

from which this Corner bears

side of

tree inches diameter, on the

Metal Location Poster is on a

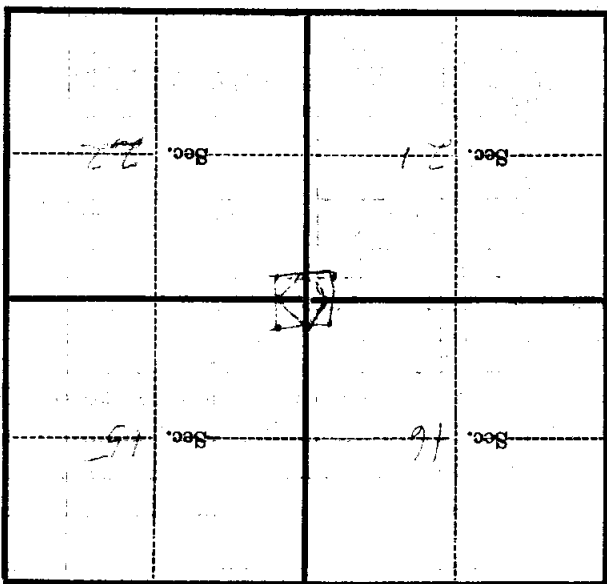

(Make sketch of topography near Corner)

T. 148 R. 28 5th Mer.

U. S. Department of Agriculture

FOREST SERVICE

Chippewa

NATIONAL FOREST

N-13

CORNERS OF THE PUBLIC SURVEY

T. 14 S R. 2 E 5th Mer.

Sec Corner common to Sections 15, 16, 21, and 22.

Corner consists of a Cedar (not) in place

State condition Old Rooted

Dimensions above ground 2 1/2 inches

Sketch grooves, letters, figures, or notches, on proper face or edge.

CARDINAL POSITION

DIAGONAL POSITION

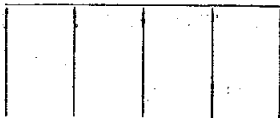

N W S E

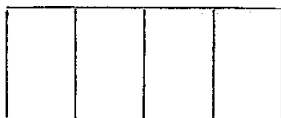

NW SW SE NE

Mound of _____ is located _____

Pits are located _____

Sketch markings of Bearing Trees (or Rocks) in proper box and fill blanks below, giving bearings from Corner to Trees and Distances in Links.



Species Birch Pine Oak

Diameter 12" 10" 8"

Bearing N-70°W N-48°W S-34°W

Distance .31 .60 .43

Do you believe this to be a genuine Land Office Corner? No

If not, why? Corner - Reestablished

by county surveyor -

DIFFERENT B.T.s scribed

(P) alive

(Signature)

Foster

(Date)

(Title)

10/20/30

Corner again.

Give any further facts which will aid in finding this

chains distant.

from which this Corner bears

side of

tree inches diameter, on the

Metal Location Poster is on a

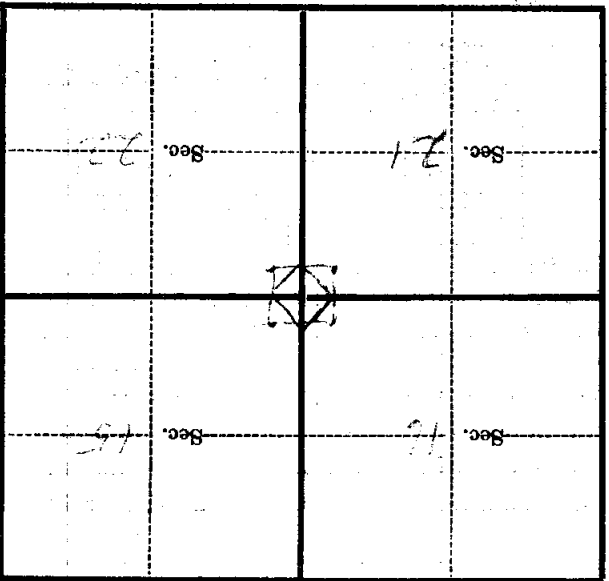

(Make sketch of topography near Corner)

T. 148 R. 29 S. 5 Mer.

U. S. Department of Agriculture

FOREST SERVICE

N-13

Chippewa NATIONAL FOREST

CORNERS OF THE PUBLIC SURVEY

T. 148N R. 28W 5 1/2 Mer.

Section - Corner common to Sections 15, 16, 21, and 22

Corner consists of a Cedar - (now) in place

State condition Old-Rotted

Dimensions above ground 25" inches

Sketch grooves, letters, figures, or notches, on proper face or edge.

CARDINAL POSITION

DIAGONAL POSITION

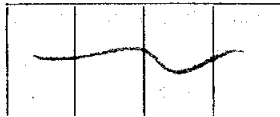

N W S E

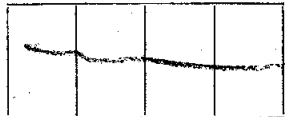

NW SW SE NE

Mound of is located

Pits are located

Sketch markings of Bearing Trees (or Rocks) in proper box and fill blanks below, giving bearings from Corner to Trees and Distances in Links.

S- 16	S- 16	S- 21	
BT	BT	BT	

Species Birch Elm Oak

Diameter 12" 10" 8"

Bearing N70°W N85°W S. 39°W

Distance 131 160 43

Do you believe this to be a genuine Land Office Corner? No

If not, why? Corner is Reestablished by County Surveyor - (Different (BTs scribed))

Bohke

(Signature)

10/25/36

(Date)

Chief of Party

(Title)

63

Corner is located in A. M.
 Typo's 8,250 ft. East of
 Dumber River on Sec line
 Bat. Sec - 16 - 21 -

Corner again.

Give any further facts which will aid in finding this

chains distant.

from which this Corner bears

side of

tree inches diameter, on the

Metal Location Poster is on a

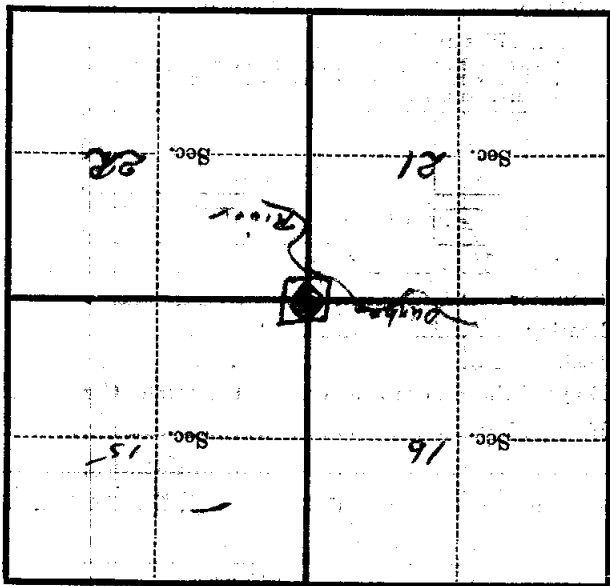

(Make sketch of topography near Corner)

T. T. 148 N. R. 28 W. Mer.