

U. S. Department of Agriculture
FOREST SERVICE

19

Chippewa NATIONAL FOREST

CORNERS OF THE PUBLIC SURVEY

T. 148N R. 28W 5th Mer.

Quarter Corner common to Sections

29, and 28

Corner consists of a post (not) in place

State condition Very Poor.

Dimensions above ground 25" inches

Sketch grooves, letters, figures, or notches, on proper face or edge.

CARDINAL POSITION

DIAGONAL POSITION

1/4/	S	1/4	S
	29		28
N	W	S	E

NW	SW	SE	NE

Mound of is located

Pits are located

Sketch markings of Bearing Trees (or Rocks) in proper box and fill blanks below, giving bearings from Corner to Trees and Distances in Links.

None found.			

Species

Diameter

Bearing

Distance

Do you believe this to be a genuine Land Office Corner? Yes

If not, why?

Ray Nelson
(Signature)

3/27/35
(Date)

Chief of Party.
(Title)

Metal Location Poster is on a tree inches diameter, on the side of from which this Corner bears chains distant.

Give any further facts which will aid in finding this Corner again.

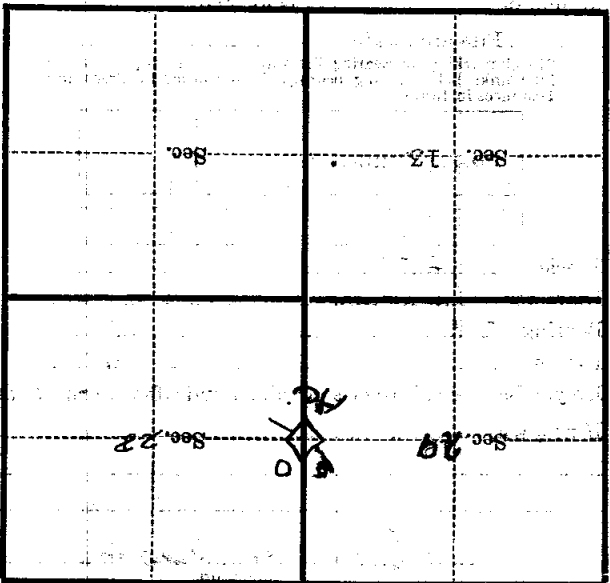

(Make sketch of topography near Corner)

T. 148N R. 28W Sth. Mer.

U. S. Department of Agriculture

FOREST SERVICE

T-9

Chippewa NATIONAL FOREST

CORNERS OF THE PUBLIC SURVEY

T. 145 N. R. 28 W. S. 7 Mer.

Corner common to Sections

29, and 28

Corner consists of a post (not) in place

State condition 300 ft

Dimensions above ground 25 inches

Sketch grooves, letters, figures, or notches, on proper face or edge.

CARDINAL POSITION

DIAGONAL POSITION

1/4	S	1/4	S
29		28	
N	W	S	E

NW	SW	SE	NE

Mound of _____ is located _____

Pits are located _____

Sketch markings of Bearing Trees (or Rocks) in proper box and fill blanks below, giving bearings from Corner to Trees and Distances in Links.

	NONE		

Species _____

Diameter _____

Bearing _____

Distance _____

Do you believe this to be a genuine Land Office Corner? *Yes*

If not, why? _____

(Signature)

(Date)

(Title)

107

Corner again.

Give any further facts which will aid in finding this

chains distant.

from which this Corner bears

side of

tree. inches diameter, on the

Metal Location Poster is on a

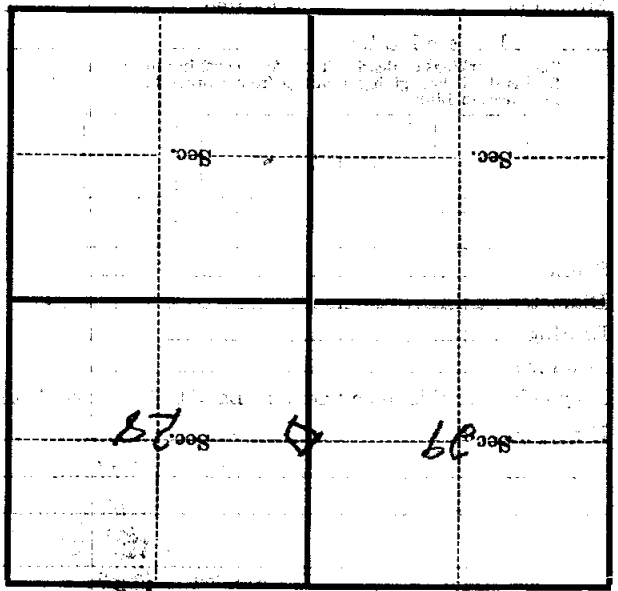

(Make sketch of topography near Corner)

T. L. VAN R. #280 5th Mer.

Form 874-9—Revised May, 1918
 U. S. Department of Agriculture
 FOREST SERVICE

T-9

Chippewa NATIONAL FOREST

CORNERS OF THE PUBLIC SURVEY

T. 146 N. R. 28 W. 5th Mer.

Corner common to Sections 29, and 28

Corner consists of a post (not) in place

State condition poor

Dimensions above ground 25" inches

Sketch grooves, letters, figures, or notches, on proper face or edge.

CARDINAL POSITION

DIAGONAL POSITION

1/4	S	1/4	S
29		28	
N	W	S	E

NW	SW	SE	NE

Mound of _____ is located _____

Pits are located _____

Sketch markings of Bearing Trees (or Rocks) in proper box and fill blanks below, giving bearings from Corner to Trees and Distances in Links.

	None		

Species _____

Diameter _____

Bearing _____

Distance _____

Do you believe this to be a genuine Land Office Corner? *Yes*

If not, why? _____

(Signature)

(Date)

(Title)

[Faint, illegible text on ruled lines]

Corner again.

Give any further facts which will aid in finding this
chain's distant
from which this Corner bears
side of
tree inches diameter, on the
Metal Location Poster is on a

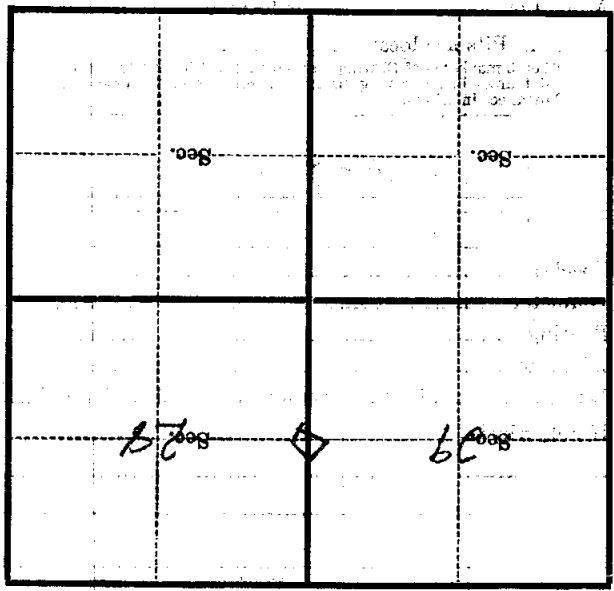

(Make sketch of topography near Corner)

T. L. H. N. R. P. 280 5th Mer.

U. S. Department of Agriculture

FOREST SERVICE

7-9

Chippewa NATIONAL FOREST

CORNERS OF THE PUBLIC SURVEY

T. 148N R. 20W S. 5 Mer.

Quarter 27 Corner common to Sections

29, and 28

Corner consists of a POST in place

State condition Very poor

Dimensions above ground 25 inches

Sketch grooves, letters, figures, or notches, on proper face or edge.

CARDINAL POSITION

DIAGONAL POSITION

$\frac{1}{4}$	S	$\frac{1}{4}$	S
29		28	
N	W	S	E

NW	SW	SE	NE

Mound of _____ is located _____

Pits are located _____

Sketch markings of Bearing Trees (or Rocks) in proper box and fill blanks below, giving bearings from Corner to Trees and Distances in Links.

	<i>alone</i>		

Species _____

Diameter _____

Bearing _____

Distance _____

Do you believe this to be a genuine Land Office Corner? Y

If not, why? _____

Ray Nelson (Signature)

3/27/35 (Date) _____ (Title)

Metal Location Poster is on a tree inches diameter, on the side of from which this Corner bears chains distant. Give any further facts which will aid in finding this Corner again.

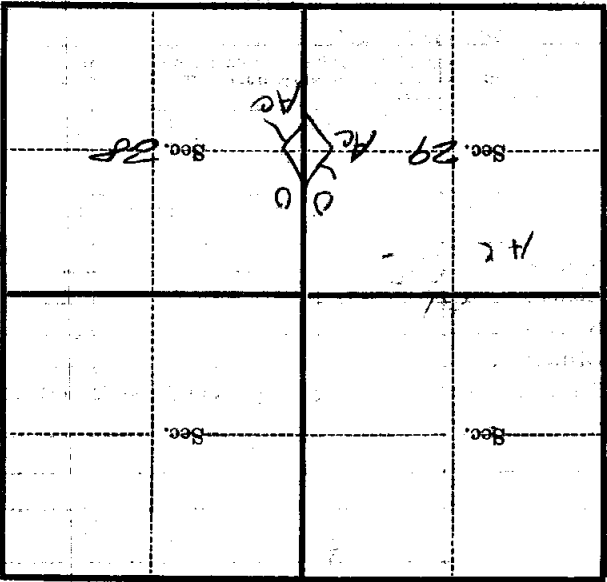

(Make sketch of topography near Corner)

T. 148N R. 23W 5 Mer.