

U. S. Department of Agriculture

FOREST SERVICE

N25  
P.

Chippewa

NATIONAL FOREST

CORNERS OF THE PUBLIC SURVEY

T. 148<sup>th</sup> Section R. 26<sup>th</sup> 5th Mer.

Corner common to Sections 13, 18, 24, and 19

Corner consists of a Wood post (not) in place

State condition Good

Dimensions above ground 36 inches

Sketch grooves, letters, figures, or notches, on proper face or edge.

CARDINAL POSITION

DIAGONAL POSITION



N W S E

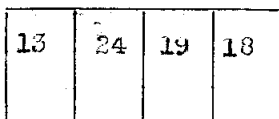

NW SW SE NE

Mound of \_\_\_\_\_ is located \_\_\_\_\_

Pits are located \_\_\_\_\_

Sketch markings of Bearing Trees (or Rocks) in proper box and fill blanks below, giving bearings from Corner to Trees and Distances in Links.

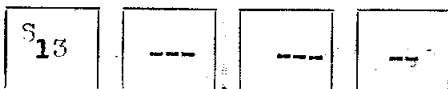

B. T.	B. T.	B. T.	B. T.
-------	-------	-------	-------

Species	Asp.	Balsam	Spruce	Sp. Spr.
Diameter	5"	7"	14"	5"
Bearing	S 24° W	S 22° E	N 41° W	N 21° W
Distance	.56	.72	1.66	.77 ch.

Do you believe this to be a genuine Land Office Corner? Yes.

If not, why? \_\_\_\_\_

*[Signature]*

(Signature)

Chief of party

(Title)

6/4/35

(Date)

-----

-----

-----

-----

-----

-----

-----

-----

-----

-----

Corner again.

Give any further facts which will aid in finding this

chains distant.

from which this Corner bears 1.66

side of Sec. 13

tree 14 inches diameter, on the

Metal Location Poster is on a

Spr. B. W.

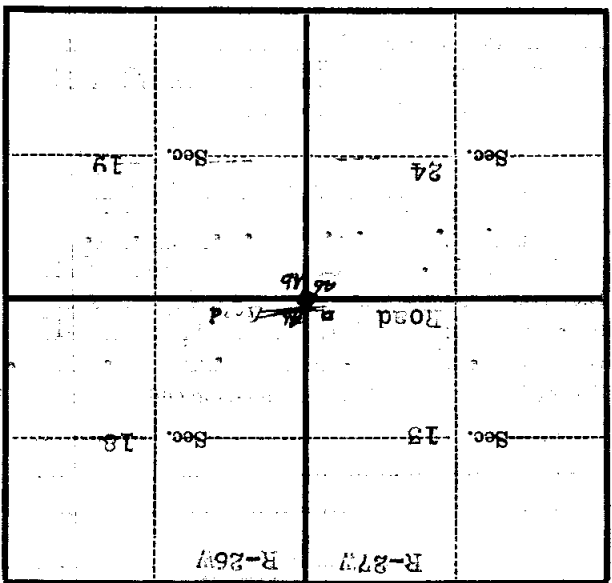

(Make sketch of topography near Corner)

U. S. Department of Agriculture

FOREST SERVICE

N-25

Chippewa

NATIONAL FOREST

CORNERS OF THE PUBLIC SURVEY

T. 148N R. 27W 5th Mer.

Sec.

Corner common to Sections

13, 18, 24, and 19

Corner consists of a Wood Post (not) in place

State condition

Good

Dimensions above ground 36 inches

Sketch grooves, letters, figures, or notches, on proper face or edge.

CARDINAL POSITION

DIAGONAL POSITION

--	--	--	--

13	24	19	18
----	----	----	----

N W S E

NW SW SE NE

Mound of \_\_\_\_\_ is located \_\_\_\_\_

Pits are located \_\_\_\_\_

Sketch markings of Bearing Trees (or Rocks) in proper box and fill blanks below, giving bearings from Corner to Trees and Distances in Links.

S 13	-	-	-
---------	---	---	---

BT	BT	BT	BT
----	----	----	----

Species Asp Bal Spr Asp

Diameter 5" 7" 14" 5"

Bearing S24°W S22E N41W N21E

Distance .56 .72 1.66 .72

Do you believe this to be a genuine Land Office Corner? Yes

If not, why? \_\_\_\_\_

D. Rger

(Signature)

Chief of Party

(Title)

6-4-35

(Date)

Blank lined writing area at the top of the page.

Corner again.

Give any further facts which will aid in finding this  
Metal Location Poster is on a  
tree 1/4" inches diameter, on the  
side of  
Sec 13  
from which this Corner bears  
1.66 chains distant.  
N 41° W  
S pr B.T.

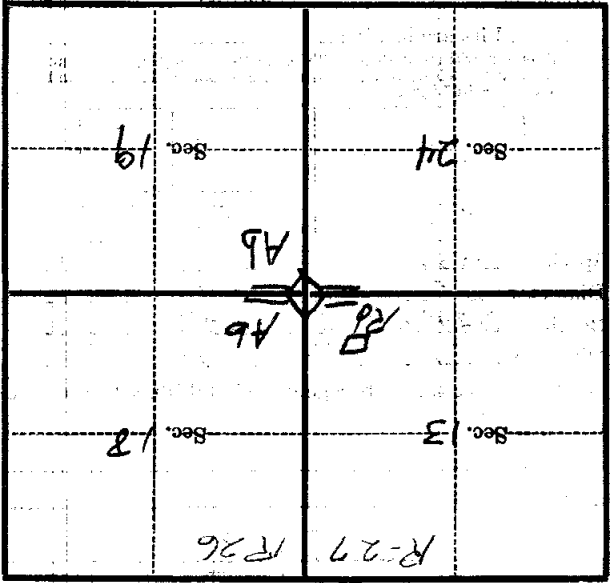

(Make sketch of topography near Corner)