

Form 874-9—Revised May, 1918  
U. S. Department of Agriculture  
FOREST SERVICE

0-25

Chippewa NATIONAL FOREST

CORNERS OF THE PUBLIC SURVEY

T. 148 R. 27 5th Mer.  
1/16#14

Corner common to Sections  
24, and

Corner consists of a Iron pipe (not) in place  
State condition

Dimensions above ground inches  
Sketch grooves, letters, figures, or notches, on proper face or edge.

CARDINAL POSITION

DIAGONAL POSITION

--	--	--	--

N W S E

--	--	--	--

NW SW SE NE

Mound of is located

Pits are located

Sketch markings of Bearing Trees (or Rocks) in proper box and fill blanks below, giving bearings from Corner to Trees and Distances in Links.

1/16 S24	1/16 S19		
-------------	-------------	--	--

BT	BT		
----	----	--	--

Species Cedar Tam

Diameter 12" 6"

Bearing S18<sup>N</sup> N19<sup>E</sup>

Distance .27 .20

Do you believe this to be a genuine Land Office Corner? No

If not, why? County Corner

Walter Haberle

(Signature)

12/9/39

(Date)

Leader

(Title)

93a

Metal Location Poster is on a *The cedar berrying* tree *tree.* inches diameter, on the side of from which this Corner bears chains distant. Give any further facts which will aid in finding this Corner again.

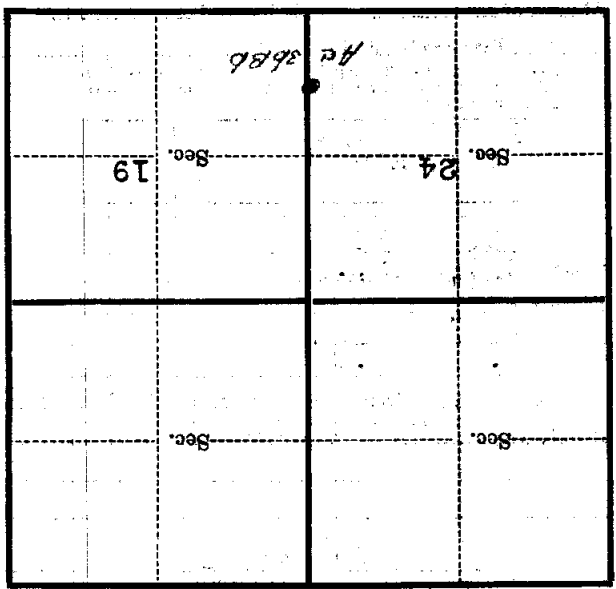

(Make sketch of topography near Corner)