

Form 874-0—Revised May, 1918
U. S. Department of Agriculture
FOREST SERVICE

J-21

Chippewa NATIONAL FOREST

CORNERS OF THE PUBLIC SURVEY

T. 148 N R. 26 W 5th Mer.

Section Corner common to Sections

11, 12, 13, and 14

Corner consists of a white location ^{Post} (not) in place

State condition

Dimensions above ground 5" x 5" x 48" inches

Sketch grooves, letters, figures, or notches, on proper face or edge.

CARDINAL POSITION

DIAGONAL POSITION

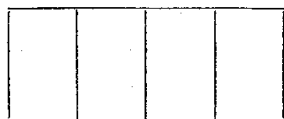
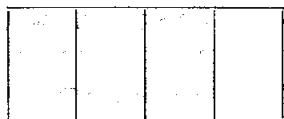

N W S E

NW SW SE NE

Mound of is located

Pits are located

Sketch markings of Bearing Trees (or Rocks) in proper box and fill blanks below, giving bearings from Corner to Trees and Distances in Links.



B.T. B.T. B.T. B.T.

Species N. Pine W. Pine

Diameter 18" 24"

Bearing N56°W S33°E

Distance 1.04 chs. 1.10 chs.

Do you believe this to be a genuine Land Office Corner? Yes.

~~Not~~, why? Old B.T.'s are Old

G.L.O. B.T.'s Exact location

of corner from B.T. is

questionable.

Herbert Gorman

(Signature)

Jan 7, 1935
(Date)

Tech. Foreman
(Title)

U. S. GOVERNMENT PRINTING OFFICE: 1964 O-7834

3--7834

Corner again.

Give any further facts which will aid in finding this

chains distant.

From which this Corner bears

side of

~~the~~ Post inches diameter, on the

Metal Location Poster is on a ~~white~~ location

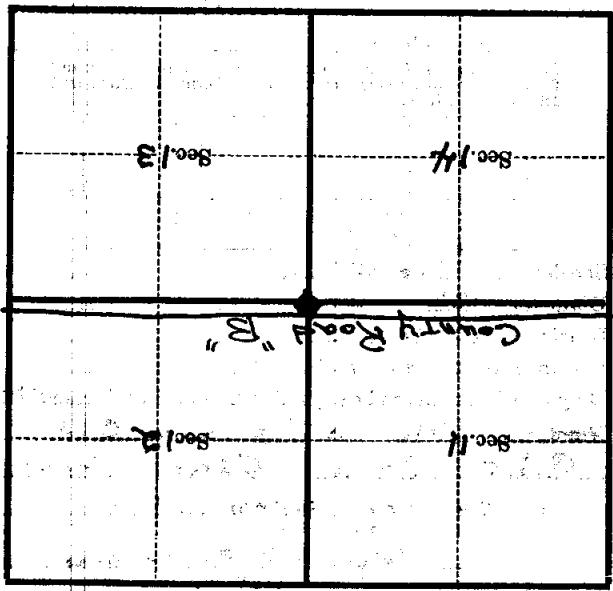

(Make sketch of topography near Corner)

U. S. Department of Agriculture
FOREST SERVICE

J-21

Diippe wa NATIONAL FOREST

CORNERS OF THE PUBLIC SURVEY

T. 148N R. 26W 5th Mer.

Section Corner common to Sections

11, 12, 13, and 14 part ?

Corner consists of a white location post (not) in place

State condition

Dimensions above ground 5" x 5" x 48" inches

Sketch grooves, letters, figures, or notches, on proper face or edge.

CARDINAL POSITION

DIAGONAL POSITION

N W S E

NW SW SE NE

Mound of is located

Pits are located

Sketch markings of Bearing Trees (or Rocks) in proper box and fill blanks below, giving bearings from Corner to Trees and Distances in Links.

<u>BT</u>	<u>BT</u>		

Species 1x Pine W. Pine

Diameter 18" 24"

Bearing 56°W 53°E

Distance 1.04 ch. 1.10 ch.

Do you believe this to be a genuine Land Office Corner? Yes

If not, why? Old B.T.'s are old

G.L.O. B.T.'s Exact location of
corner from B.T.'s is questionable.

Herbert Norman

(Signature)

Jan 7, 1935

(Date)

Techn. Foreman

(Title)

Metal Location Poster is on a *white location* ^{post} inches diameter, on the side of from which this Corner bears chains distant.

Give any further facts which will aid in finding this Corner again.

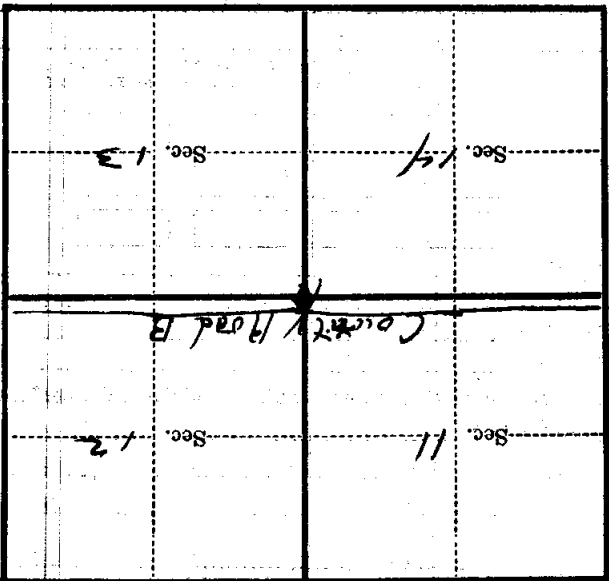

(Make sketch of topography near Corner)

T. 14 N. R. 26 W. 5th Mer. 5-21