

U. S. Department of Agriculture

FOREST SERVICE

*Chippewa* NATIONAL FOREST *2-25*

CORNERS OF THE PUBLIC SURVEY

T. *148+49* R. *25* Mer. *5*

Corner common to Sections

*1, 2, 3, 4*, and

Corner consists of a *Old Post* (not) in place

State condition *None*

Dimensions above ground \_\_\_\_\_ inches.

Sketch grooves, letters, figures, or notches, on proper face or edge.

CARDINAL POSITION

DIAGONAL POSITION

N	W	S	E

NW	SW	SE	NE

Mound of \_\_\_\_\_ is located \_\_\_\_\_

Pits are located \_\_\_\_\_

Sketch markings of Bearing Trees (or Rocks) in proper box and fill blanks below, giving bearings from Corner to Trees and Distances in Links.

<i>B</i>			

Species *A.P. Shag*

Diameter *14*

Bearing *E 30 S*

Distance \_\_\_\_\_

Do you believe this to be a genuine Land Office Corner? \_\_\_\_\_

If not, why? \_\_\_\_\_

*Wm. J. ...*

(Signature)

(Date)

(Title)

Metal Location Poster is on a tree \_\_\_\_\_ inches diameter, on the side of \_\_\_\_\_ from which this Corner bears \_\_\_\_\_ chains distant.

Give any further facts which will aid in finding this Corner again.

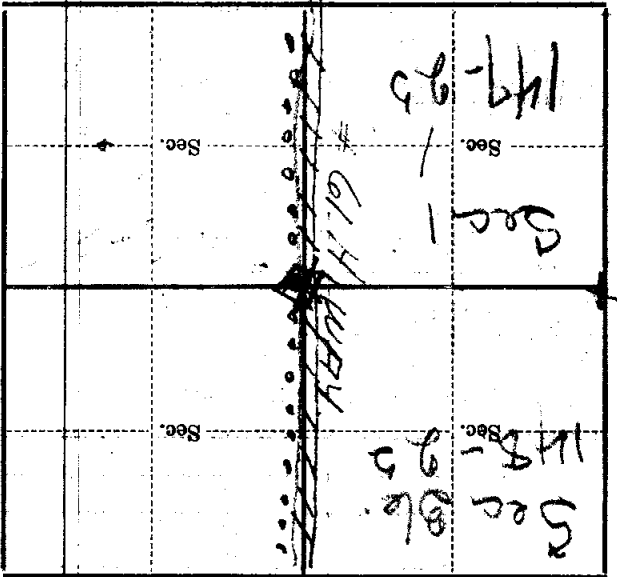

(Make sketch of topography near Corner)

T. 148 N. R. 25