

U. S. Department of Agriculture
FOREST SERVICE

Patented N1

CHIPPEWA NATIONAL FOREST

CORNERS OF THE PUBLIC SURVEY

T. 148N R. 25-26W 5 Mer.

S Corner common to Sections

13, 18, 19, and 24

Corner consists of a _____ (not) in place

State condition _____

Dimensions above ground _____ inches

Sketch grooves, letters, figures, or notches, on proper face or edge.

CARDINAL POSITION

DIAGONAL POSITION

--	--	--	--

N W S E

--	--	--	--

NW SW SE NE

Mound of _____ is located _____

Pits are located _____

Sketch markings of Bearing Trees (or Rocks) in proper box and fill blanks below, giving bearings from Corner to Trees and Distances in Links.

T148N R26W 813

T148N R25W 818

--

--

BT

BT

--

--

Species Tam Tam

Diameter 5" 4"

Bearing N31W S69E

Distance 0.59 0.06

Do you believe this to be a genuine Land Office Corner? Yes

If not, why? _____

Paul Nelson

(Signature)

CCC Enrollee

(Title)

1-18-35

(Date)

Corner again.

Give any further facts which will aid in finding this

chains distant.

0.25

S591

from which this Corner bears

side of

Tree

tree 6 inches diameter, on the SE

Metal Location Poster is on a

dam

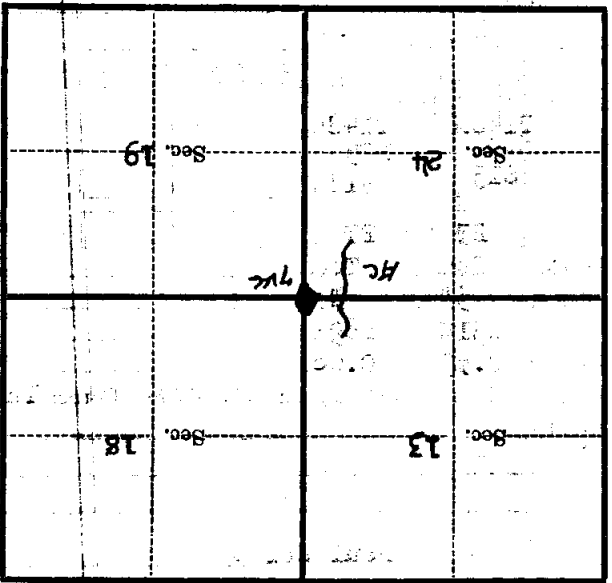

(Make sketch of topography near Corner)

U. S. Department of Agriculture

FOREST SERVICE

Chippewa NATIONAL FOREST

N-1

CORNERS OF THE PUBLIC SURVEY

T. 148 N R. 25-26 W S Mer.

S Corner common to Sections

13, 18, 19, and 22

Corner consists of a _____ (not) in place

State condition _____

Dimensions above ground _____ inches

Sketch grooves, letters, figures, or notches, on proper face or edge.

CARDINAL POSITION

DIAGONAL POSITION

--	--	--	--

N W S E

--	--	--	--

NW SW SE NE

Mound of _____ is located _____

Pits are located _____

Sketch markings of Bearing Trees (or Rocks) in proper box and fill blanks below, giving bearings from Corner to Trees and Distances in Links.

T 148 N
R 26 W
S 13

T 148 N
R 25 W
S 18

--

--

BT

BT

--

--

Species Tam TamDiameter 5" 4"Bearing N31W S69EDistance 0.59 0.06Do you believe this to be a genuine Land Office Corner? Yes

If not, why? _____

Paul Nelson

(Signature)

1-18-35

(Date)

CCC Enrollee

(Title)

Metal Location Poster is on a *10m.* tree 6 inches diameter, on the *SE* side of *Tree* from which this Corner bears *559E* 0.25 chains distant.

Give any further facts which will aid in finding this Corner again.

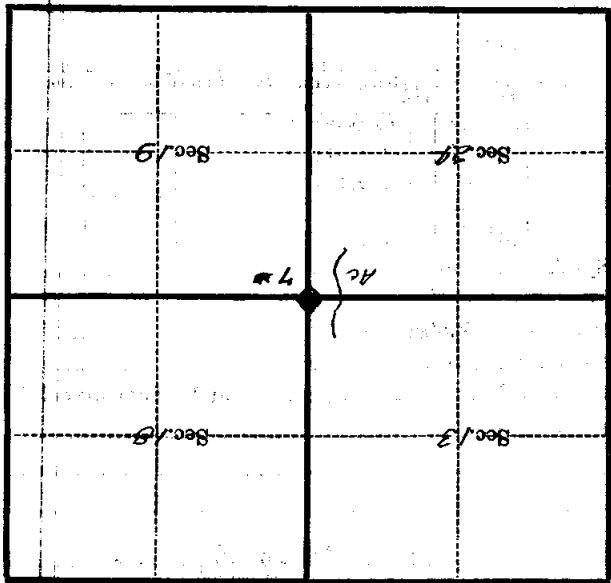

(Make sketch of topography near Corner)

T. 148N. R. 25-26W. S. 5 Mer.

Form 874-6--Revised May, 1918
U. S. Department of Agriculture
FOREST SERVICE

N-1
R-25

~~CHL...~~ NATIONAL FOREST
CORNERS OF THE PUBLIC SURVEY

T. ~~1422~~ R. ~~15-267~~ 5 Mer.

Corner common to Sections

~~13~~, ~~14~~, ~~19~~, and ~~21~~

Corner consists of a _____ (not) in place

State condition _____

Dimensions above ground _____ inches

Sketch grooves, letters, figures, or notches, on proper face or edge.

CARBINAL POSITION

DIAGONAL POSITION

--	--	--	--

N W S E

--	--	--	--

NW SW SE NE

Mound of _____ is located _____

Pits are located _____

Sketch markings of Bearing Trees (or Rocks) in proper box and fill blanks below, giving bearings from Corner to Trees and Distances in Links.

2142 2257 833

2142 2257 814

--

--

--

--

--

--

Species ~~2222~~ ~~2222~~ _____

Diameter ~~50~~ ~~42~~ _____

Bearing ~~8517~~ ~~8695~~ _____

Distance ~~0.59~~ ~~0.06~~ _____

Do you believe this to be a genuine Land Office Corner? ~~Yes~~

If not, why? _____

~~Paul Nelson~~
(Signature)

~~1-14-15~~
(Date)

~~U.S. Forester~~
(Title)

Dotted lines for writing notes.

Corner again.

Give any further facts which will aid in finding this

chain distant.

from which this Corner bears

side of

tree 6 inches diameter, on the

Metal Location Poster is on a

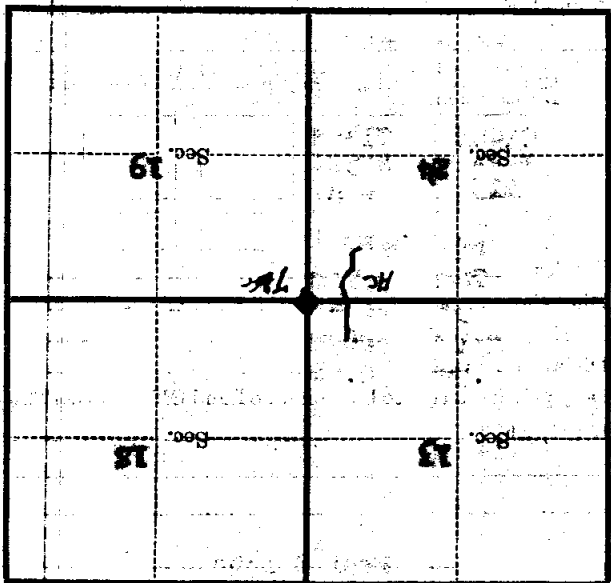

(Make sketch of topography near Corner)