

UNITED STATES DEPARTMENT OF THE INTERIOR

BUREAU OF LAND MANAGEMENT

WATER RIGHTS DIVISION

The site being for a location
tag fastened to tree about
16' south of
Corner again.

Give any further facts which will aid in finding this
chains distant.
from which this Corner bears
side of
tree inches diameter, on the
Metal Location Poster is on a

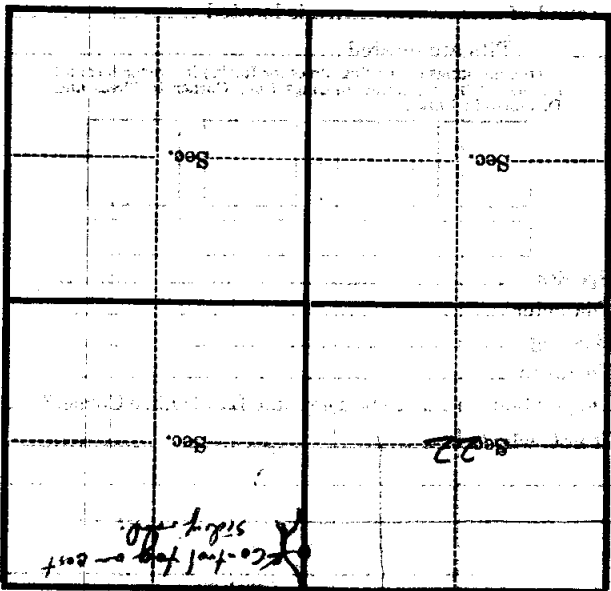

(Make sketch of topography near Corner)

Form 874-9—Revised May, 1918
U. S. Department of Agriculture
FOREST SERVICE

017

NATIONAL FOREST

CORNERS OF THE PUBLIC SURVEY

T. 147 R. 31 Mer.

Corner common to Sections
22, 23, _____, and _____

Corner consists of a Iron Pipe - stamped cap (not) in place

State condition good

Dimensions above ground 8" inches

Sketch grooves, letters, figures, or notches, on proper face or edge.

CARDINAL POSITION

DIAGONAL POSITION

--	--	--	--

N W S E

--	--	--	--

NW SW SE NE

Mound of _____ is located _____

Pits are located _____

Sketch markings of Bearing Trees (or Rocks) in proper box and fill blanks below, giving bearings from Corner to Trees and Distances in Links.

<u>None</u>			

Species _____

Diameter _____

Bearing _____

Distance _____

Do you believe this to be a genuine Land Office Corner? _____

If not, why? Cap stamped G.L.O.

Ralph W. Christopher

(Signature)

R. F. R.

(Title)

9-8-33

(Date)