

Corner again.

Give any further facts which will aid in finding this

0.217 chains distant.

from which this Corner bears S. 81° W.

side of Tree

tree 5 inches diameter, on the West

Metal Location Poster is on a Aspen

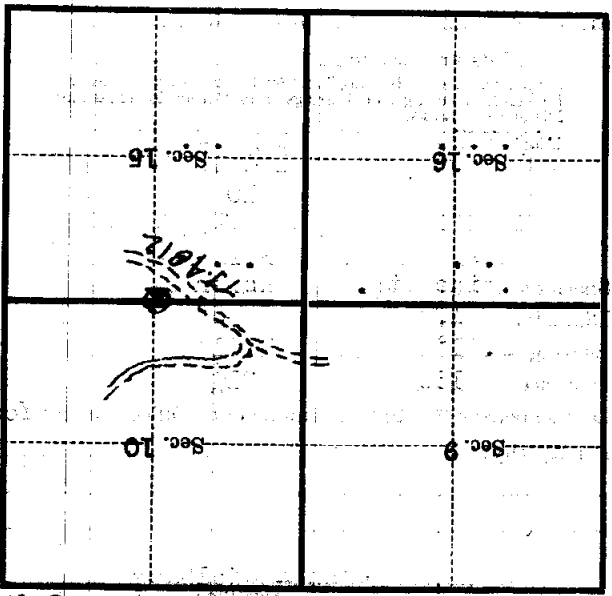

(Make sketch of topography near Corner)

T. 147 N. R. 31 W. 5th P. Mer. J-15

U. S. Department of Agriculture

FOREST SERVICE

J-15

J 15

Chippewa NATIONAL FOREST

CORNERS OF THE PUBLIC SURVEY

T. 147 N. R. 31 W. 5th P. Mer.

Quarter Corner common to Sections
10, and 15

Corner consists of a Aspen Post (not) in place

State condition Good

Dimensions above ground 48 inches

Sketch grooves, letters, figures, or notches, on proper face or edge.

CARDINAL POSITION

DIAGONAL POSITION

--	--	--	--

N W S E

--	--	--	--

NW SW SE NE

Mound of _____ is located _____

Pits are located _____

Sketch markings of Bearing Trees (or Rocks) in proper box and fill blanks below, giving bearings from Corner to Trees and Distances in Links.

Orig. B.T.		New B.T.	
		1/4 S 10	
B.T.		B.T.	

Species J. pine Stp. Aspen

Diameter 10" 5"

Bearing S. 11° W. N. 81° E.

Distance 156 21 1/2

Do you believe this to be a genuine Land Office Corner? Yes

If not, why? _____

John A. Gjelhaug

(Signature)

Jr. Civil Engineer

11-1-38

(Date)

(Title)

J-15