

Corner again.

Give any further facts which will aid in finding this

0.50 chains distant.

from which this Corner bears South

side of Post

tree 6 inches diameter, on the South

Metal Location Poster is on a Sec. Line Post

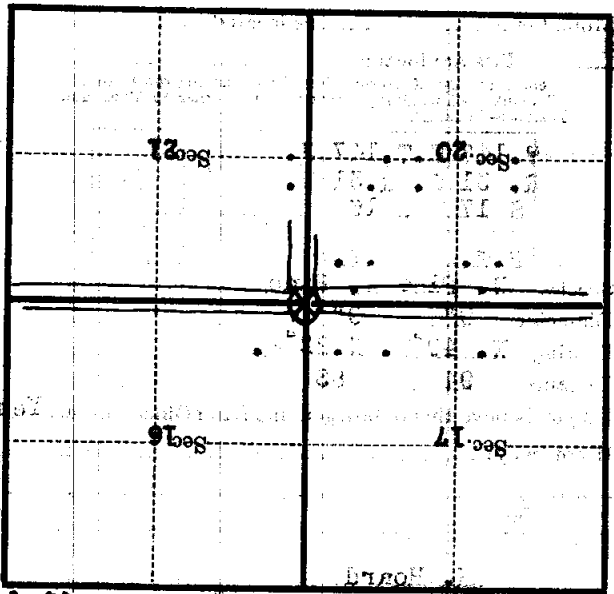

(Make sketch of topography near Corner)

T 142 N. R. 31 W. 5th. P. Mer. N-9

U. S. Department of Agriculture

FOREST SERVICE

N-9

N9
Chippewa..... NATIONAL FOREST

CORNERS OF THE PUBLIC SURVEY

T. 147 N. R. 31 W. 5th. P. Mer.

Section..... Corner common to Sections

16, 17, 20, and 21

Corner consists of a In center of Road (not) in place

State condition

Dimensions above ground..... inches

Sketch grooves, letters, figures, or notches, on proper face or edge.

CARDINAL POSITION

DIAGONAL POSITION

--	--	--	--

N W S E

--	--	--	--

NW SW SE NE

Mound of..... is located

Pits are located

Sketch markings of Bearing Trees (or Rocks) in proper box and fill blanks below, giving bearings from Corner to Trees and Distances in Links.

T. 147 N.	T. 147 N.		
R. 31 W.	R. 31 W.		
S 17	S 16		
B.T.	B.T.		

Species N. Pine N. Pine.....Diameter 9" 9".....Bearing N. 49° W. N. 22° E......Distance 84 83.....Do you believe this to be a genuine Land Office Corner? Yes

If not, why?

H. Hoard

(Signature)

10/6/39

(Date)

Compass Man.

(Title)

N-9