

Corner again.

Give any further facts which will aid in finding this

chains distant.

0.69

from which this Corner bears $S. 23^{\circ} W.$

side of Tree

tree 8 inches diameter, on the S.M.

Metal Location Poster is on a J. Pine

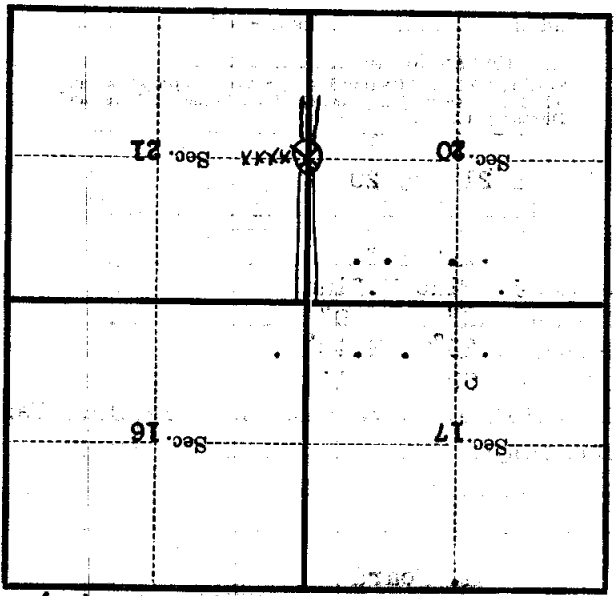

(Make sketch of topography near Corner)

U. S. Department of Agriculture

FOREST SERVICE

P-9

89

Chippewa NATIONAL FOREST

CORNERS OF THE PUBLIC SURVEY

T. 147 N. R. 31 W. 5th. P. Mer. Quarter

Corner common to Sections 20, and 21

Corner consists of a Br. Cap Iron Pipe (not) in place

State condition Good in center of road.

Dimensions above ground 2" under ground inches

Sketch grooves, letters, figures, or notches, on proper face or edge.

CARDINAL POSITION

DIAGONAL POSITION

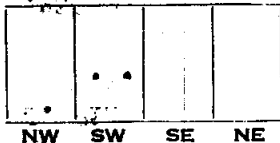
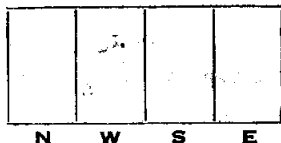

Mound of is located

Pits are located

Sketch markings of Bearing Trees (or Rocks) in proper box and fill blanks below, giving bearings from Corner to Trees and Distances in Links.

$\frac{1}{4}$
S 21

$\frac{1}{4}$
S 20

B.T.

B.T.

Species J. Pine N. Pine

Diameter 8" 9"

Bearing N. 23° E. N. 40° W.

Distance 69 110

Do you believe this to be a genuine Land Office Corner? Yes

If not, why?

H. Hoard

(Signature)

10/6/39
(Date)

Compass Man
(Title)

P-9

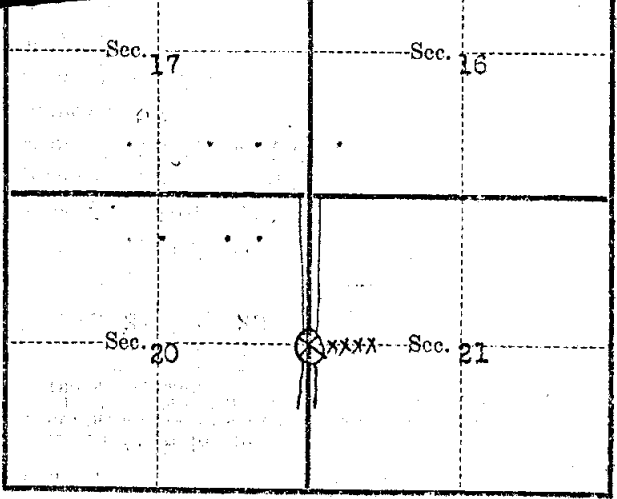

Metal Location Poster is on a J. Pine
 tree 8 inches diameter, on the S.W.
 side of Tree
 from which this Corner bears S. 23° W.
 0.69 chains distant.

Give any further facts which will aid in finding this
 Corner again.

.....

.....

.....

.....

.....

.....

.....

.....

.....

.....

U. S. Department of Agriculture
FOREST SERVICE

89

Chippewa NATIONAL FOREST

CORNERS OF THE PUBLIC SURVEY

147 N. R. 31 W. 5th. P. Mer.

Quarter Corner common to Sections
20, and 21

Corner consists of a Br. Cap Iron Pipe (not) in place
in good condition Good in center of road.

Dimensions above ground 2" under ground inches

Sketch grooves, letters, figures, or notches, on proper face or edge.

CARDINAL POSITION

DIAGONAL POSITION

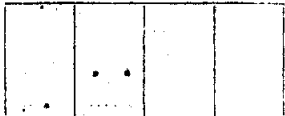

N W S E NW SW SE NE

Bound of is located

Pits are located

Sketch markings of Bearing Trees (or Rocks) in proper box and fill blanks below, giving bearings from Corner to Trees and Distances in Links.

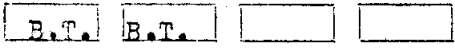
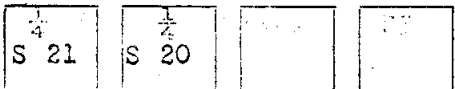

Species J. Pine N. Pine

Diameter 8" 9"

Bearing N. 23° E. N. 40° W.

Distance 69 110

Do you believe this to be a genuine Land Office Corner? Yes

Not, why?

H. Hoard

(Signature)

3/6/39

Compass Man