

U. S. Department of Agriculture

FOREST SERVICE

already posted

C-2

Chippewa NATIONAL FOREST

CORNERS OF THE PUBLIC SURVEY

T. 147 N. R. 30 W. 5 th P. Mer.

Quarter Corner common to Sections

1, and 2

Corner consists of a Aspen Post (60%) in place

State condition Good

Dimensions above ground 36 inches

Sketch grooves, letters, figures, or notches, on proper face or edge.

CARDINAL POSITION

DIAGONAL POSITION

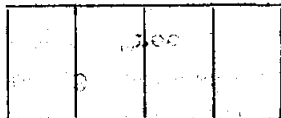

Mound of is located

Pits are located

Sketch markings of Bearing Trees (or Rocks) in proper box and fill blanks below, giving bearings from Corner to Trees and Distances in Links.

County E. T.

1/4 S. 1

B. T.

Species Aspen

Diameter 8"

Bearing S. 54° 45' E.

Distance 129

Do you believe this to be a genuine Land Office Corner? Yes

If not, why? S * I

K.V. Styler

(Signature)

3/24/38

(Date)

Leader

(Title)

CHAINS

CORNERS OF THE POSTER

1934

POSTER

1934

Corner again.

Give any further facts which will aid in finding this

chains distant.

from which this Corner bears N. 64.45. W.

side of Tree

tree 8 inches diameter, on the N.W.

Metal Location Poster is on an Aspen

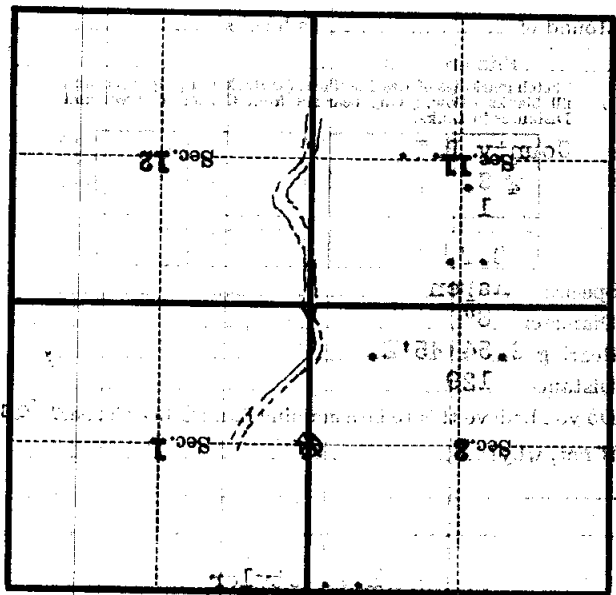

(Make sketch of topography near Corner)

T. 147 N. R. 30 W. S. 4th P. Mer.