

U. S. Department of Agriculture
FOREST SERVICE

E-13

Chippewa NATIONAL FOREST

CORNERS OF THE PUBLIC SURVEY

T. 147 N. R. 30 W. 5th. P. Mer.

Section Corner common to Sections
3, 4, 9, and 10.

Corner consists of a Cedar Post (not) in place

State condition Good

Dimensions above ground 40 inches

Sketch grooves, letters, figures, or notches, on proper face or edge.

CARDINAL POSITION

DIAGONAL POSITION

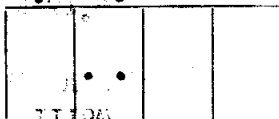

Mound of is located

Pits are located

Sketch markings of Bearing Trees (or Rocks) in proper box and fill blanks below, giving bearings from Corner to Trees and Distances in Links.

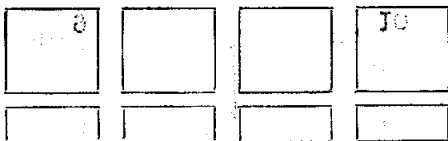

Species

Diameter

Bearing

Distance

Do you believe this to be a genuine Land Office Corner? Yes

If not, why? Found orig. scribed post in orig. place. Old Line trees in line East and South.

John A. Gjelhaug

(Signature)

11/2/39 (Date)

Jr. Civil Eng. (Title)

Set new Cedar post by old post.

Corner again.

Give any further facts which will aid in finding this

On 18 chains distant.

from which this Corner bears N. 31° W.

side of Tree

tree 5 inches diameter, on the N.W.

Metal Location Poster is on a Willow

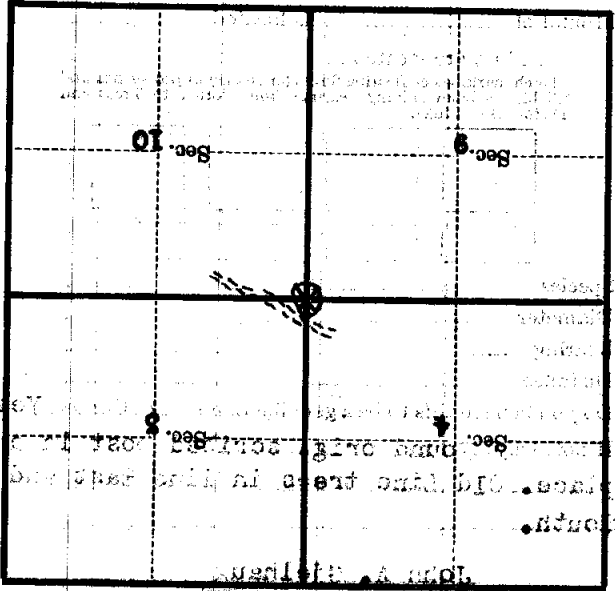

(Make sketch of topography near Corner)

T. 27 N. R. 30 W. 5th P. Mer.