

A-5

U. S. Department of Agriculture
FOREST SERVICE

Chippewa NATIONAL FOREST

CORNERS OF THE PUBLIC SURVEY

T. 147-148 R. 30 5-th Mer.

~~1st~~ Section Corner common to Sections
5, 6, 31, and 32

Corner consists of a Cement post (not) in place
State condition Good

Dimensions above ground Underground inches
Sketch grooves, letters, figures, or notches, on proper face or edge.

CARDINAL POSITION

DIAGONAL POSITION

--	--	--	--

N W S E

--	--	--	--

NW SW SE NE

Mound of _____ is located _____

Pits are located _____

Sketch markings of Bearing Trees (or Rocks) in proper box and fill blanks below, giving bearings from Corner to Trees and Distances in Links.

Species Aspen

Diameter 12"

Bearing S60 W

Distance 1ch

Do you believe this to be a genuine Land Office Corner? Yes

If not, why? _____

Handlson
(Signature)

11/8/34
(Date)

(Title)

Corner again.

Give any further facts which will aid in finding this

chains distant.

from which this Corner bears

side of

tree 10 inches diameter, on the

Metal Location Poster is on a

from post

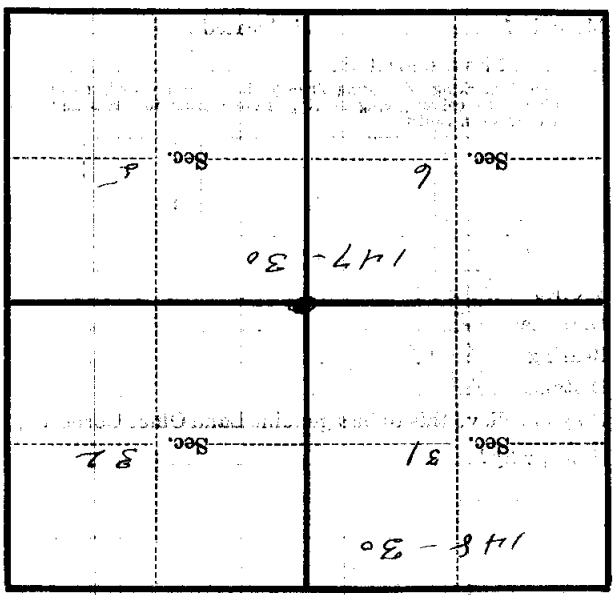

(Make sketch of topography near Corner)

T. 147-48 R 30 Mer.