

U. S. Department of Agriculture
FOREST SERVICE

N-5

Chippewa NATIONAL FOREST
CORNERS OF THE PUBLIC SURVEY

T. 147N R. 28W Mer.

Section Corner common to Sections
17, 18, 19, and 20

Corner consists of a old Pipe in ground (not) in place
State condition May have been G.L.O. size cap broken off

Dimensions above ground _____ inches
Sketch grooves, letters, figures, or notches, on proper face or edge.

CARDINAL POSITION

DIAGONAL POSITION

--	--	--	--

--	--	--	--

N W S E

NW SW SE NE

Mound of _____ is located _____

Pits are located _____

Sketch markings of Bearing Trees (or Rocks) in proper box and fill blanks below, giving bearings from Corner to Trees and Distances in Links.

Sec 18	Sec 17	Sec 19	
NE	NE	SW	

Species Spruce Cedar Tam.

Diameter 8" (40#H) 8" (35#H) 7" (40#H)

Bearing N-37°E N 25°E S-75°W

Distance 4.8 links 6.0 links

Do you believe this to be a genuine Land Office Corner? Yes

If not, why? _____

W Banks

(Signature)

10/10/34
(Date)

Tech. Foreman

(Title)

69

Corner again.
located in a spruce-tamarack swamp
(Poles), Cox About 1/2 mi. NE of
Third River Road.

Metal Location Poster is on a
tree inches diameter, on the
side of
from which this Corner bears
chains distant.
Give any further facts which will aid in finding this

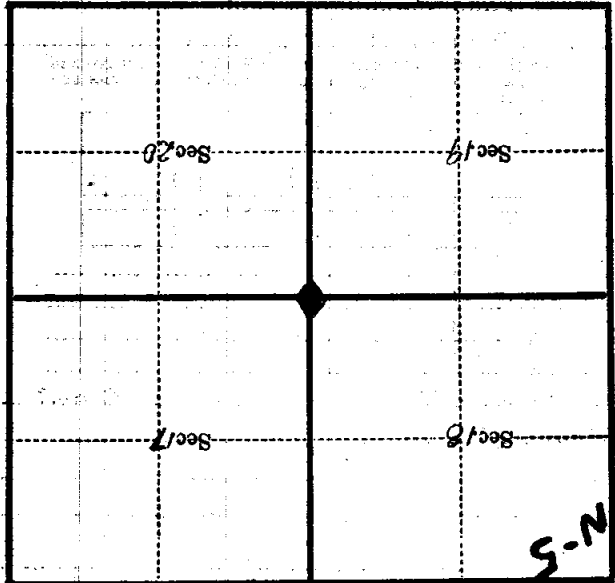

(Make sketch of topography near Corner)

T. 147 R. 28 Mer. 5 25

U. S. Department of Agriculture
FOREST SERVICE

N-5

Chippewa NATIONAL FOREST

CORNERS OF THE PUBLIC SURVEY

T. 147N R. 28W 5 Mer.

SECTION Corner common to Sections
17, 18, 19, and 20

Corner consists of a stone (not) in place

State condition good

Dimensions above ground _____ inches

Sketch grooves, letters, figures, or notches, on proper face or edge.

CARDINAL POSITION

DIAGONAL POSITION

N W S E

NW SW SE NE

Mound of _____ is located _____

Pits are located _____

Sketch markings of Bearing Trees (or Rocks) in proper box and fill blanks below, giving bearings from Corner to Trees and Distances in Links.

S 18	S 17	S 17	
NE	RT	SW	

Species Spice Cedar

Diameter 8" 8" 7"

Bearing N37°E N25°E S75°W

Distance 48 60

Do you believe this to be a genuine Land Office Corner? yes

If not, why? _____

(Signature)

10/10/30

(Date)

(Title)

69

CORNER OF THE PUBLIC SQUARE

Corner again. Give any further facts which will aid in finding this

chain distant.

from which this Corner bears

side of

feet inches diameter, on the

Metal Location Poster is on a

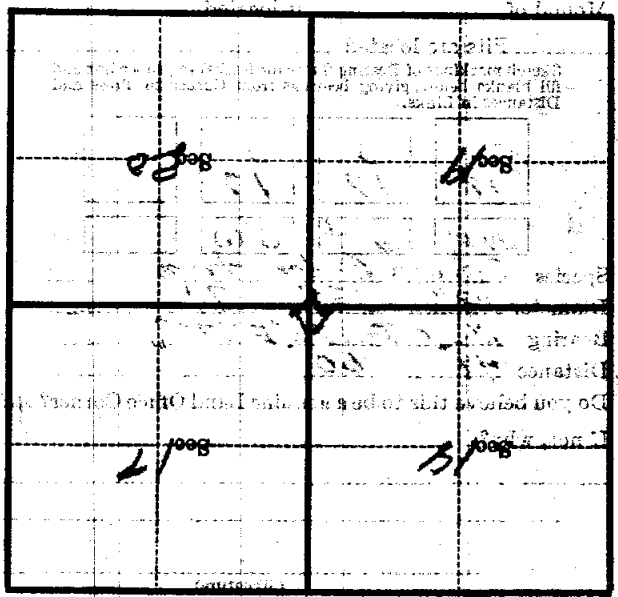

(Make sketch of topography near Corner)

U. S. Department of Agriculture
FOREST SERVICE

N-5

Chippewa NATIONAL FOREST
CORNERS OF THE PUBLIC SURVEY

T. 147 N R. 28 W 6th Mer.
SECTION Corner common to Sections
17, 18, 19, and 20

Corner consists of a pipe (not) in place
State condition good

Dimensions above ground inches
Sketch grooves, letters, figures, or notches, on proper face or edge.

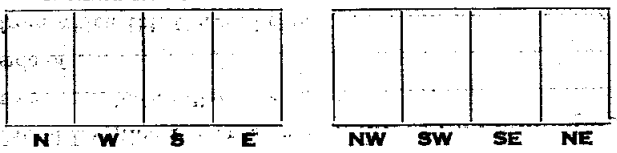

Mound of _____ is located _____

Pits are located _____

Sketch markings of Bearing Trees (or Rocks) in proper box and fill blanks below, giving bearings from Corner to Trees and Distances in Links.

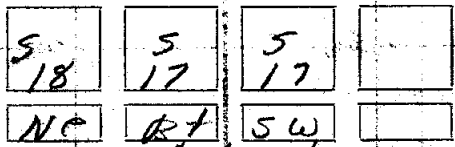

Species Spruce Cedar Fir
Diameter 9" 8" 7"
Bearing N37°E N25°E S75°W
Distance 48 60

Do you believe this to be a genuine Land Office Corner? *yes*
If not, why? _____

10/10/34
(Date)

(Signature)

(Title)

67

COUNTY OF [unclear] STATE OF [unclear]
 [unclear]
 [unclear]
 [unclear]

Corner again.

Give any further facts which will aid in finding this
 chains distant.
 from which this Corner bears
 side of
 tree inches diameter, on the
 Metal Location Poster is on a

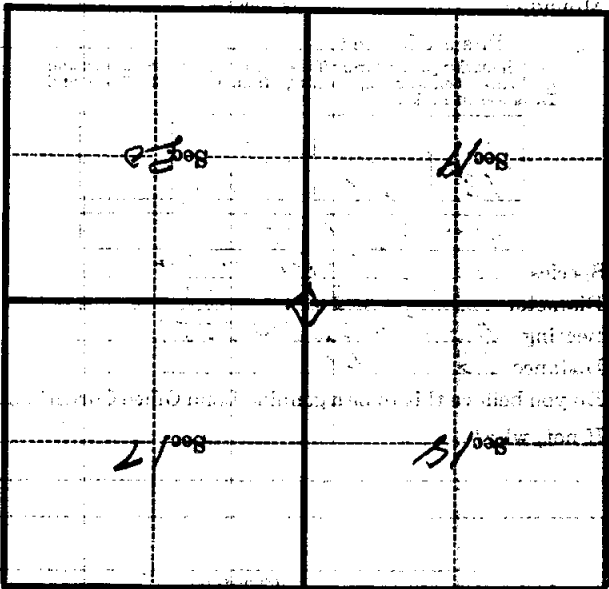

(Make sketch of topography near Corner)

Form 974-9—Revised May, 1918
U. S. DEPARTMENT OF AGRICULTURE
FOREST SERVICE

N5
 Posted

Chippewa NATIONAL FOREST

CORNERS OF THE PUBLIC SURVEY

T. 147 N R. 28 W S. 4 P Mer.

Corner common to Sections
17, 18, 19, and 20

Corner consists of a square stake in place
 State condition Good

Dimensions above ground 2 1/2 x 2 1/2 inches.
 Sketch grooves, letters, figures, or notches, on proper face or edge.

CARDINAL POSITION

DIAGONAL POSITION

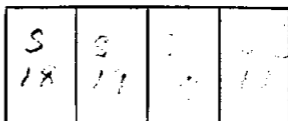
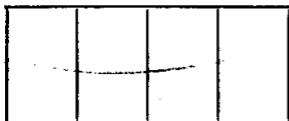

N W S E

NW SW SE NE

Mound of ✓ is located ✓

✓ Pits are located ✓

Sketch markings of Bearing Trees (or Rocks) in proper box and fill blanks below, giving bearings from Corner to Trees and Distances in Links.

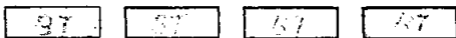
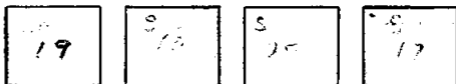

Species	<u>T</u>	<u>S. Pine</u>	<u>T. Pine</u>	<u>C. Pine</u>
Diameter	<u>9"</u>	<u>11"</u>	<u>11"</u>	<u>4"</u>
Bearing	<u>S 61 W</u>	<u>N 41 W</u>	<u>S 33 E</u>	<u>N 72 E</u>
Distance	<u>14'</u>	<u>24</u>	<u>21.65</u>	<u>24</u>

Do you believe this to be a genuine Land Office Corner? Yes

If not, why? ✓

Signature.

Date.

Title.

*Corner again.
Doubtful James
1137 Ave. E. on 70 E.
W. Ave. on 214 E.*

Give any further facts which will aid in finding this
chains distant

from which this Corner bears
side of
tree
inches diameter, on the

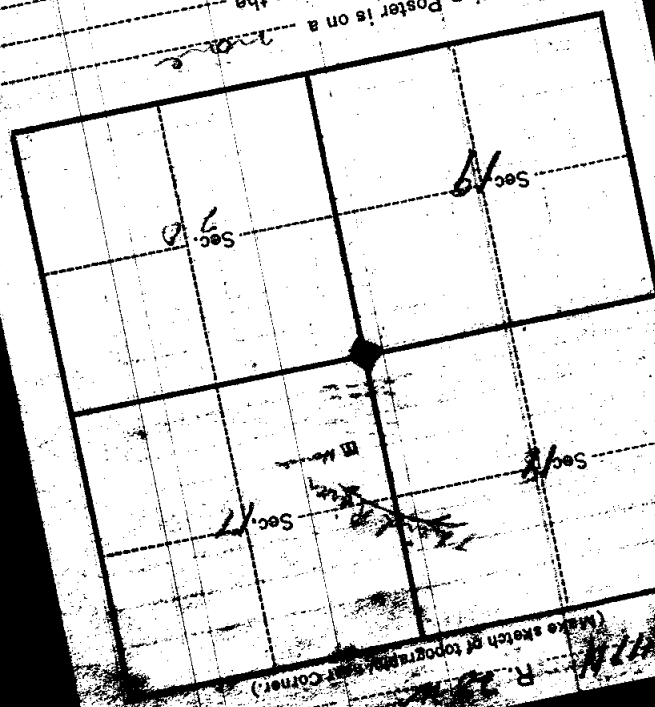

U. S. DEPARTMENT OF AGRICULTURE
FOREST SERVICE

N5
Posted

Chippewa NATIONAL FOREST

CORNERS OF THE PUBLIC SURVEY

T. 147 N R. 22 W S. 1 P Mer.

Corner common to Sections
17, 18, 19 and 20

Corner consists of a squared stake in place
State condition Good

Dimensions above ground 2 1/2 x 2 1/4 inches.

Sketch grooves, letters, figures, or notches, on proper face or edge.

CARDINAL POSITION

DIAGONAL POSITION

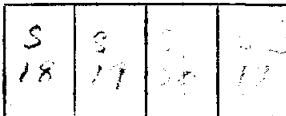

N W S E NW SW SE NE

Mound of ✓ is located ✓

✓ Pits are located ✓

Sketch markings of Bearing Trees (or Rocks) in proper box and fill blanks below, giving bearings from Corner to Trees and Distances in Links.

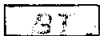
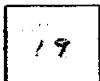

Species T S. pine T. pine C. torreyana

Diameter 9" 11" 11" 4"

Bearing S 64 W N 11 W S 32 E N 71 E

Distance 14' 24' 21 1/2' 26'

Do you believe this to be a genuine Land Office Corner? ✓

If not, why? ✓

Signature

Date

Title

Corner again.
 121 km on 2 1/2 E
 N 87 km on 2 1/2 E
 121 km on 2 1/2 E

Give any further facts which will aid in finding this
 chains distant.
 from which this Corner bears
 side of
 tree inches diameter, on the
 Metal Location Poster is on a

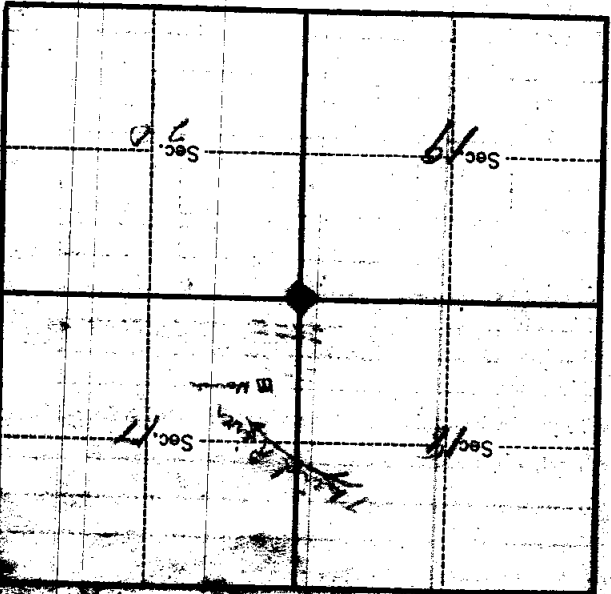

(Make sketch of topography near Corner.)