

Form 874-6—Revised May, 1918
U. S. Department of Agriculture
FOREST SERVICE

R1
K

Chippewa NATIONAL FOREST
CORNERS OF THE PUBLIC SURVEY

T. 147N R. 28W 572 Mer.

Section Corner common to Sections
19, 30, 34, and 25

Corner consists of a 6" galv pipe (not) in place
State condition good

Dimensions above ground _____ inches
Sketch grooves, letters, figures, or notches, on proper face or edge.

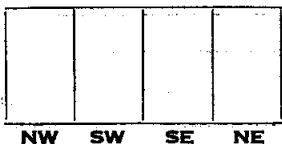
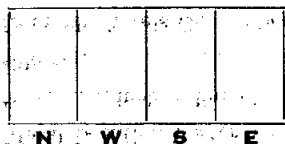

Mound of _____ is located _____

Pits are located _____

Sketch markings of Bearing Trees (or Rocks) in proper box and fill blanks below, giving bearings from Corner to Trees and Distances in Links.

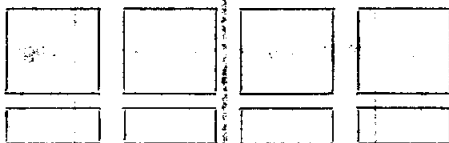

Species _____

Diameter _____

Bearing _____

Distance _____

Do you believe this to be a genuine Land Office Corner? yes

If not, why? _____

(Signature)

(Date)

(Title)

WATER RESOURCES DIVISION

FIELD NOTES

CORNERS OF THE TUNING SQUARE

tree inches diameter, on the side of from which this Corner bears

Checking distant

Give any further facts which will aid in finding this Corner again.

Metal Location Poster is on a tree inches diameter, on the side of from which this Corner bears

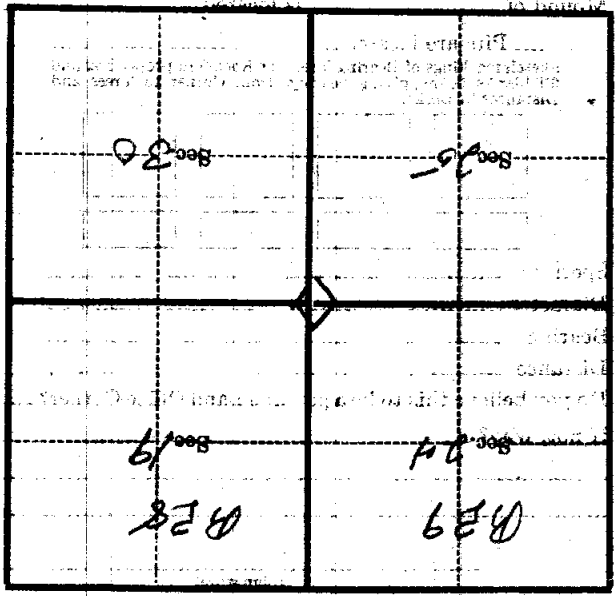

(Make sketch of topography near Corner)

U. S. Department of Agriculture
FOREST SERVICE

R-1

Chippewa..... NATIONAL FOREST

CORNERS OF THE PUBLIC SURVEY

T. 147 N R. 28 W 5th Mer.

Section..... Corner common to Sections

19, 30, 24, and 25 - Range 24

Corner consists of a G.L.O. PIPE (not) in place

State condition Good

Dimensions above ground..... inches

Sketch grooves, letters, figures, or notches, on proper face or edge.

CARDINAL POSITION

DIAGONAL POSITION

--	--	--	--

--	--	--	--

N W S E

NW SW SE NE

Mound of..... is located.....

Pits are located.....

Sketch markings of Bearing Trees (or Rocks) in proper box and fill blanks below, giving bearings from Corner to Trees and Distances in Links.

Species.....

Diameter.....

Bearing.....

Distance.....

Do you believe this to be a genuine Land Office Corner? yes

If not, why?.....

S. Rudser

(Signature)

Oct-8-1934

(Date)

Tech. Foreman

(Title)

75

.....
.....
.....
.....
.....

Corner again.
Located near 4-sided stake. No sampling-
River 2 chains NW of corner.
Corner in meadow.

Metal Location Poster is on a tree..... inches diameter, on the side of from which this Corner bears chains distant.
Give any further facts which will aid in finding this

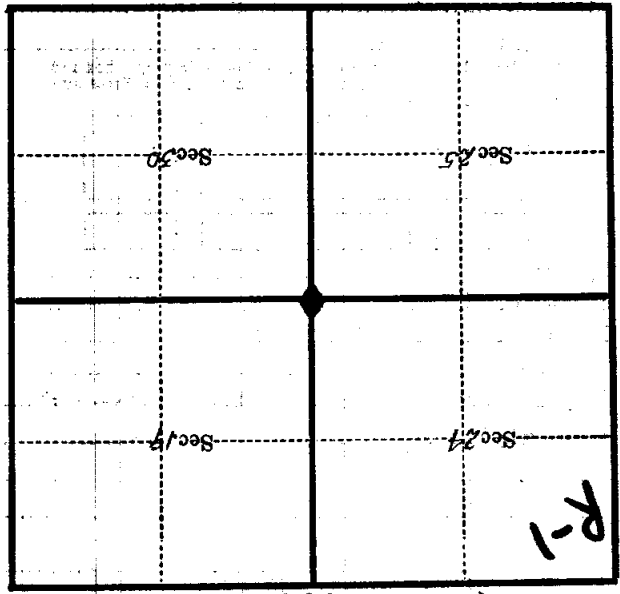

(Make sketch of topography near Corner)

U. S. Department of Agriculture
FOREST SERVICE

R-1

Chippewa NATIONAL FOREST

CORNERS OF THE PUBLIC SURVEY

T. 147N R. 28W 5th Mer.

Section

Corner common to Sections

19, 30, 34, and 35

Corner consists of a Glo pipe (not) in place

State condition good

Dimensions above ground _____ inches

Sketch grooves, letters, figures, or notches, on proper face or edge.

CARDINAL POSITION

DIAGONAL POSITION

--	--	--	--

N W S E

--	--	--	--

NW SW SE NE

Mound of _____ is located _____

Pits are located _____

Sketch markings of Bearing Trees (or Rocks) in proper box and fill blanks below, giving bearings from Corner to Trees and Distances in Links.

--

✓

✓

✓

--

--

--

--

Species _____

Diameter _____

Bearing _____

Distance _____

Do you believe this to be a genuine Land Office Corner? Yes

If not, why? _____

(Signature)

(Date)

(Title)

75

CORNER OF

Corner again
Give any further facts which will aid in finding this

Point distant

from which this Corner bears

side of

tree inches diameter, on the

Metal Location Poster is on a

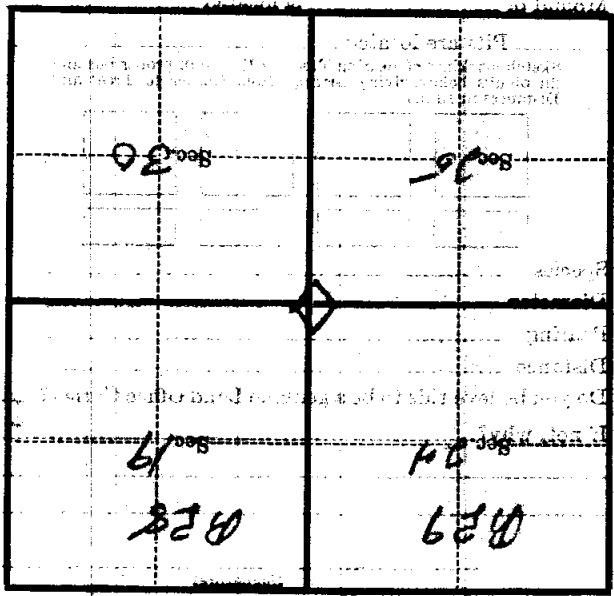

(Make sketch of topography near Corner)