

U. S. Department of Agriculture

FOREST SERVICE

B-14-15

NATIONAL FOREST

CORNERS OF THE PUBLIC SURVEY

T. 147N R. 27W 5th Mer.

Meander - Corner common to Sections

22, and 27

Corner consists of a Brass cap on ~~rod~~ in place

State condition good.

Dimensions above ground 12" 0000 inches

Sketch grooves, letters, figures, or notches, on proper face or edge.

CARDINAL POSITION

DIAGONAL POSITION

N W S E

NW SW SE NE

Mound of is located

Pits are located

Sketch markings of Bearing Trees (or Rocks) in proper box and fill blanks below, giving bearings from Corner to Trees and Distances in Links.

Species Oak N. Pine

Diameter 8" 10"

Bearing N48W S58W

Distance 81 ch. 75 ch.

Do you believe this to be a genuine Land Office Corner? Yes

If not, why?

June 12, 1918 J. J. [Signature]

(Date)

(Title)

85b

Faint, illegible text at the top of the page, possibly bleed-through from the reverse side.

Corner again.

Give any further facts which will aid in finding this

chains distant.

from which this Corner bears

side of

tree inches diameter, on the

Metal Location Poster is on a

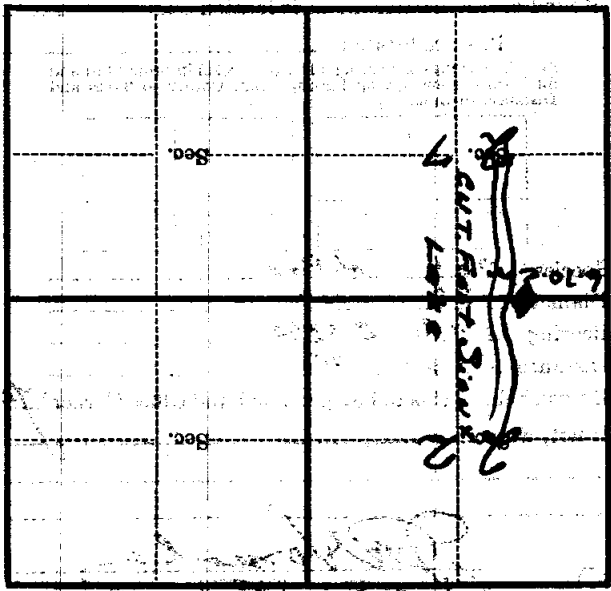

(Make sketch of topography near Corner)