

U. S. Department of Agriculture
FOREST SERVICE

P. N. 21

CHIPPewa NATIONAL FOREST

CORNERS OF THE PUBLIC SURVEY

T. 147 N R. 27 W 5th Mer.

Section Corner common to Sections

14, 13, 23, and 24

Corner consists of a stake (not) in place

State condition fair

Dimensions above ground 36"

Sketch grooves, letters, figures, or notches, on proper face or edge.

CARDINAL POSITION DIAGONAL POSITION

How high the corner post					
edge of					
face					

Position of corner on NW SW SE NE

Mound of is located

Pits are located

Sketch markings of Bearing Trees (or Rocks) in proper box and fill blanks below, giving bearings from Corner to Trees and Distances in Links.

260'		260'	

Species N. P. stump

Diameter

Bearing S 30° E

Distance 36 chs.

Do you believe this to be a genuine Land Office Corner? Yes

If not, why?

[Handwritten Signature]

(Signature)

[Handwritten Name]
(Date) (Title)

Metal Location Poster is on a tree inches diameter, on the side of from which this Corner bears chains distant. Give any further facts which will aid in finding this Corner again.

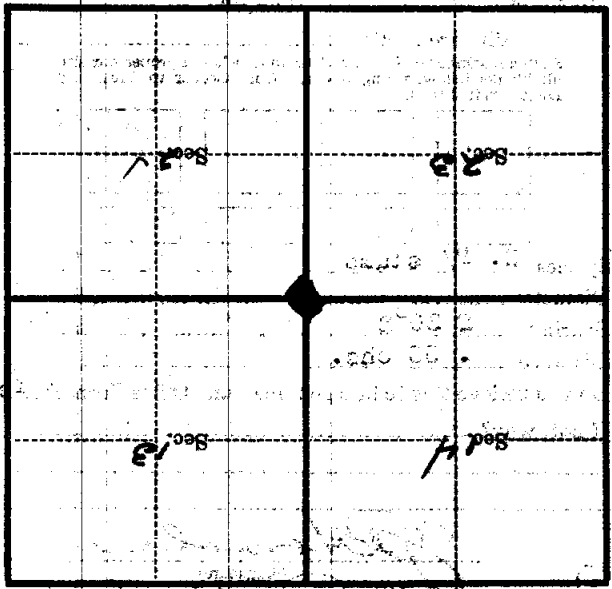

(Make sketch of topography near Corner)

U. S. Department of Agriculture
FOREST SERVICE

N-21

Chippewa NATIONAL FOREST

CORNERS OF THE PUBLIC SURVEY

T. 147 N R. 27 W 5th Mer.

Section 14, 13, 23, and 24
Corner common to Sections

Corner consists of a Concrete Mon in place
State condition just Erected

Dimensions above ground 6"-24"-20" inches
Sketch grooves, letters, figures, or notches, on proper face or edge.

CARDINAL POSITION

DIAGONAL POSITION

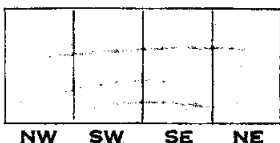
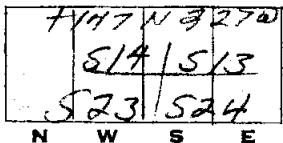

Mound of _____ is located _____

Pits are located _____

Sketch markings of Bearing Trees (or Rocks) in proper box and fill blanks below, giving bearings from Corner to Trees and Distances in Links.

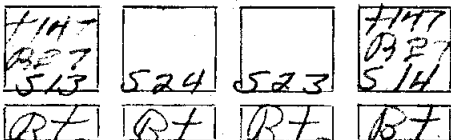

Species	NP	NP	NP	NP
Diameter	17"	5"	5"	26"
Bearing	N44°E	S31°E	S21½°W	N83½°W
Distance	67	13	24	145

Do you believe this to be a genuine Land Office Corner? yes
If not, why? _____

(Signature)

1936
(Date)

(Title)

Corner again.

Give any further facts which will aid in finding this

chains distant.

from which this Corner bears

side of

tree inches diameter, on the

Metal Location Poster is on a

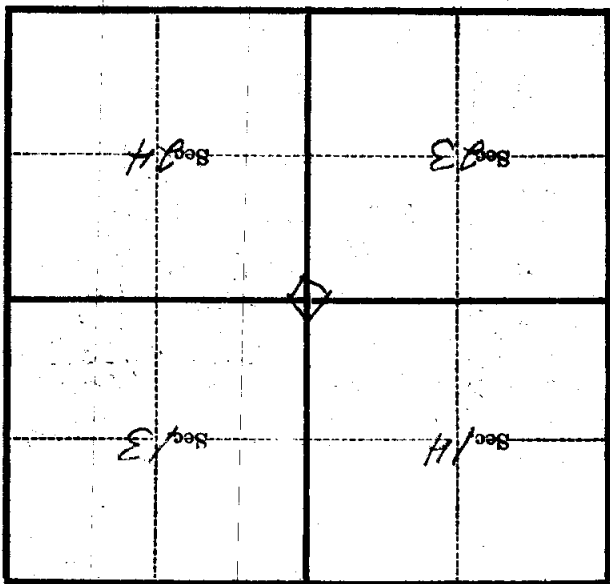

(Make sketch of topography near Corner)

T. 147 N. R. 13 E. T. 5 Mer.

Form 874-9—Revised May, 1918
 U. S. Department of Agriculture
 FOREST SERVICE

N-21

Chippewa NATIONAL FOREST
 CORNERS OF THE PUBLIC SURVEY

T. 147 N R. 27 W 5th Mer.
 Section Corner common to Sections
 14, 13, 23, and 24

Corner consists of a Concrete Iron (not) in place
 State condition just Erected

Dimensions above ground 6"-24"-20" inches
 Sketch grooves, letters, figures, or notches, on proper face or edge.

CARDINAL POSITION

DIAGONAL POSITION

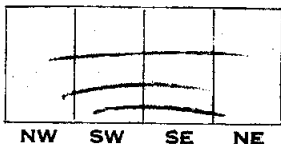
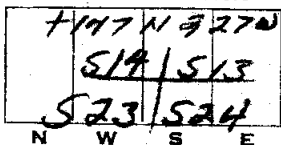

Mound of _____ is located _____

Pits are located _____

Sketch markings of Bearing Trees (or Rocks) in proper box and fill blanks below, giving bearings from Corner to Trees and Distances in Links.

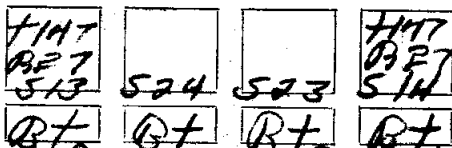

Species	NO.	NO.	JR.	NO.
Diameter	1 7/8"	5"	5"	2 6/8"
Bearing	N 4 1/2° E	S 31° E	S 21 1/2° W	N 63 1/2° W
Distance	67	13	24	143

Do you believe this to be a genuine Land Office Corner? yes

If not, why? _____

(Signature)

1936
 (Date)

(Title)

Metal Location Poster is on a tree inches diameter, on the side of from which this Corner bears chains distant. Give any further facts which will aid in finding this Corner again.

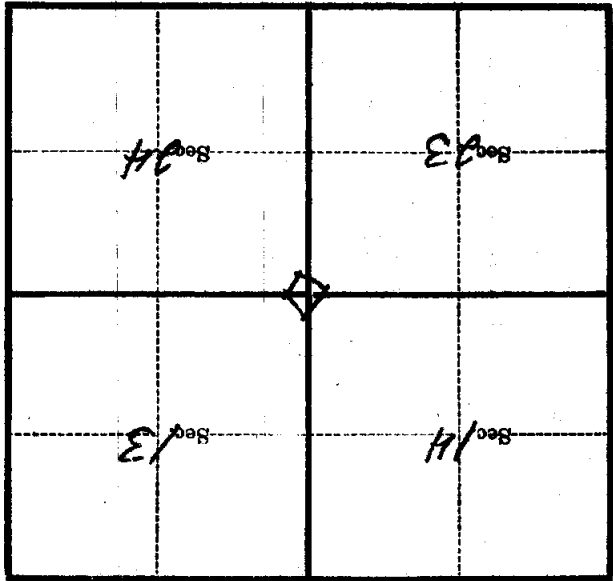

(Make sketch of topography near Corner)

T. 147 N. R. 32 W. 6th Mer.

U. S. Department of Agriculture
FOREST SERVICE

Chippewa NATIONAL FOREST N-21

CORNERS OF THE PUBLIC SURVEY

T. 147N R. 22W 5th Mer.

Section Corner common to Sections 14, 13, 23, and 24

Corner consists of a Con. Iron in place
State condition

Dimensions above ground 6x24x20 inches

Sketch grooves, letters, figures, or notches, on proper face or edge.

CARDINAL POSITION

DIAGONAL POSITION

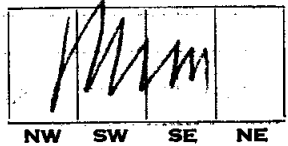
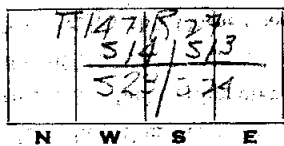

Mound of _____ is located _____

Pits are located _____

Sketch markings of Bearing Trees (or Rocks) in proper box and fill blanks below, giving bearings from Corner to Trees and Distances in Links.

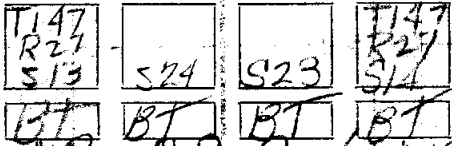

Species	NP	NP	Jack	NP
Diameter	17"	5"	5"	26"
Bearing	N4 1/2° E	S31°	S21 1/2° W	N83 1/2° W
Distance	67	13	24	145

Do you believe this to be a genuine Land Office Corner? Yes

If not, why? _____

(Signature)

(Date)

(Title)

CORNER OF THE PUBLIC SURVEY

Corner again

Chain distant

from which this Corner bears

side of

tree inches diameter, on the

Metal Location Poster is on a

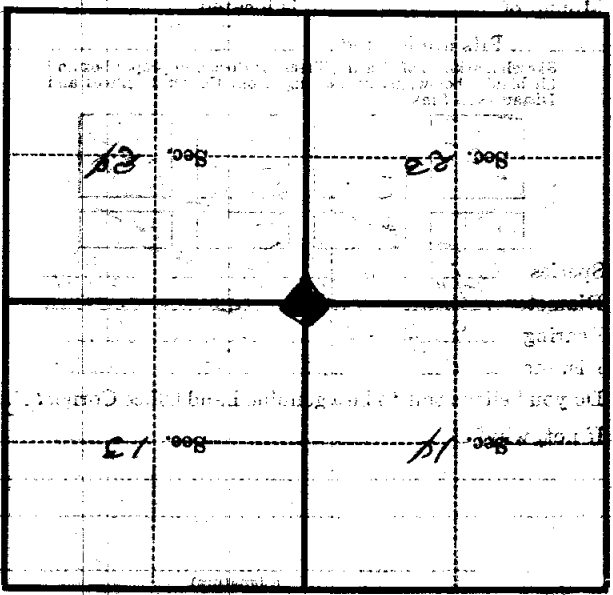

(Make sketch of topography near Corner)

Form 874-9—Revised May, 1918
 U. S. Department of Agriculture
 FOREST SERVICE

*Copied
 Packed
 57
 36.*

N-21

----- NATIONAL FOREST

CORNERS OF THE PUBLIC SURVEY

T. 147 R. 27 5 Mer.

----- Corner common to Sections
13, 16, 23, and 24

Corner consists of a J P post (not) in place
 State condition -----

Dimensions above ground ----- inches

Sketch grooves, letters, figures, or notches, on proper face or edge.

CARDINAL POSITION

DIAGONAL POSITION

--	--	--	--

--	--	--	--

N W S E

NW SW SE NE

Mound of ----- is located -----

----- Pits are located -----

Sketch markings of Bearing Trees (or Rocks) in proper box and fill blanks below, giving bearings from Corner to Trees and Distances in Links.

Species -----

Diameter -----

Bearing -----

Distance -----

Do you believe this to be a genuine Land Office Corner? -----

If not, why? -----

(Signature)

(Date)

(Title)

CORNER TO THE S.W. CORNER

20" Norway pine 15' S E of corner
21" Norway pine 30' N W of corner

Corner again.

Give any further facts which will aid in finding this

change distance

from which this Corner bears

side of

tree inches diameter, on the

Metal Location Poster is on a

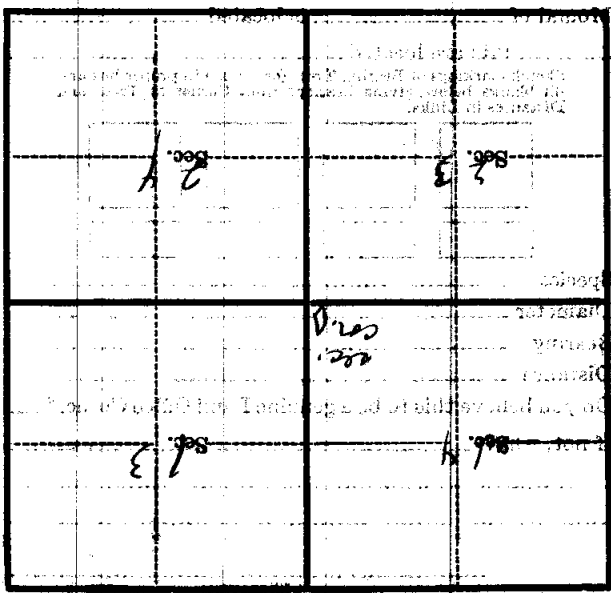

(Make sketch of topography near Corner)