

U. S. Department of Agriculture
FOREST SERVICE

R-21

Chippewa NATIONAL FOREST

CORNERS OF THE PUBLIC SURVEY

T. 142N R. 27W 5th Mer.

Section Corner common to Sections
23, 24, 26, and 25

Corner consists of a con. iron (net) in place

State condition new

Dimensions above ground 6" x 24" x 20" inches

Sketch grooves, letters, figures, or notches, on proper face or edge.

CARDINAL POSITION

DIAGONAL POSITION

142	23	24	
523	524		
524	525		

N W S E

NW SW SE NE

Mound of _____ is located _____

Pits are located _____

Sketch markings of Bearing Trees (or Rocks) in proper box and fill blanks below, giving bearings from Corner to Trees and Distances in Links.

142
23
524

142
24
525

BT

BT

--

--

Species NO NO

Diameter 8 5

Bearing N65E N80E

Distance 36 24

Do you believe this to be a genuine Land Office Corner? Yes

If not, why? _____

(Signature)

(Date)

(Title)

89

Corner again.

Give any further facts which will aid in finding this

chains distant.

from which this Corner bears

side of

tree inches diameter, on the

Metal Location Poster is on a

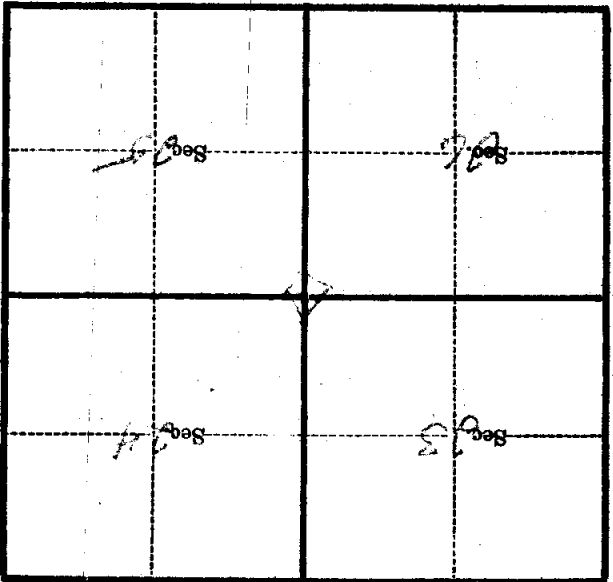

(Make sketch of topography near Corner)

T. 142 N. R. 27 W. Mer. 5 7 4

U. S. Department of Agriculture
FOREST SERVICE

R21 X

Chippewa NATIONAL FOREST

CORNERS OF THE PUBLIC SURVEY

T. 147N R. 27W 5th Mer.

SECTION 11 Corner common to Sections
23, 24, 26, and 25

Corner consists of a Coz, Iron (not) in place

State condition new

Dimensions above ground 6'-24"-20" inches

Sketch grooves, letters, figures, or notches, on proper face or edge.

CARDINAL POSITION

DIAGONAL POSITION

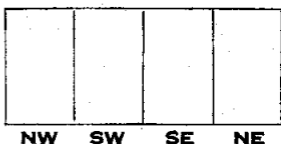
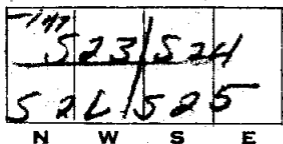

Mound of _____ is located _____

Pits are located _____

Sketch markings of Bearing Trees (or Rocks) in proper box and fill blanks below, giving bearings from Corner to Trees and Distances in Links.

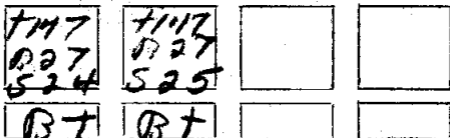

Species NP NP

Diameter 8 5

Bearing N65E N80E

Distance 136 124

Do you believe this to be a genuine Land Office Corner? Yes

If not, why? _____

(Signature)

(Date)

(Title)

89

Metal Location Poster is on a tree inches diameter, on the side of from which this Corner bears chains distant. Give any further facts which will aid in finding this Corner again.

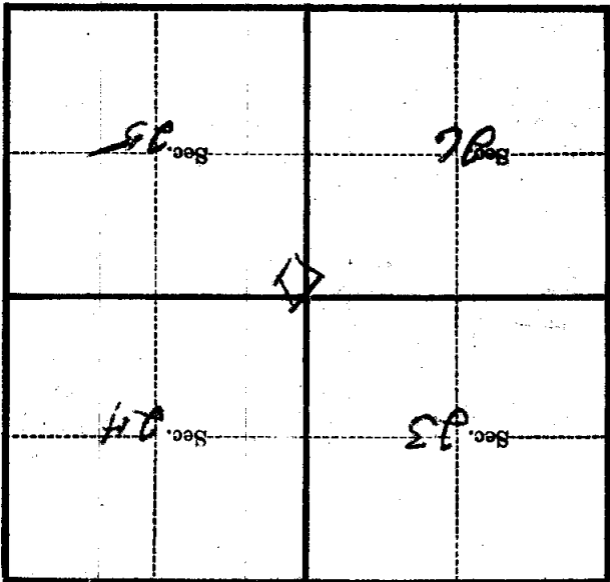

(Make sketch of topography near Corner)

T. 142 N. R. 27 E. 5th Mer.

U. S. Department of Agriculture

FOREST SERVICE

Chippewa

NATIONAL FOREST

B-21

CORNERS OF THE PUBLIC SURVEY

T. 147N. R. R7W 5th - Mer.

Section Corner common to Sections 23, 24, 25, and 26

Corner consists of a ~~stone~~ (not) in place State condition

Dimensions above ground 6' X 24' 1/2 inches Sketch grooves, letters, figures, or notches, on proper face or edge. CARDINAL POSITION DIAGONAL POSITION

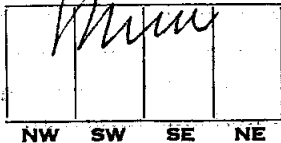
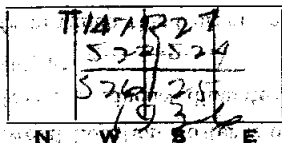

Mound of is located

Pits are located

Sketch markings of Bearing Trees (or Rocks) in proper box and fill blanks below, giving bearings from Corner to Trees and Distances in Links.



Species N.P. N.P.

Diameter 8" 5"

Bearing N65°E N80°E

Distance 136 124

Do you believe this to be a genuine Land Office Corner?

If not, why?

(Signature)

(Date)

(Title)

U.S. DEPARTMENT OF AGRICULTURE

FOREST SERVICE

UNITED STATES FOREST SERVICE

CORNERS OF THE PUBLIC SURVEY

Persons are further advised which will aid in finding the

corners distant.

from which this corner bears

side of

tree inches diameter, on the

Metal Location Poster is on a

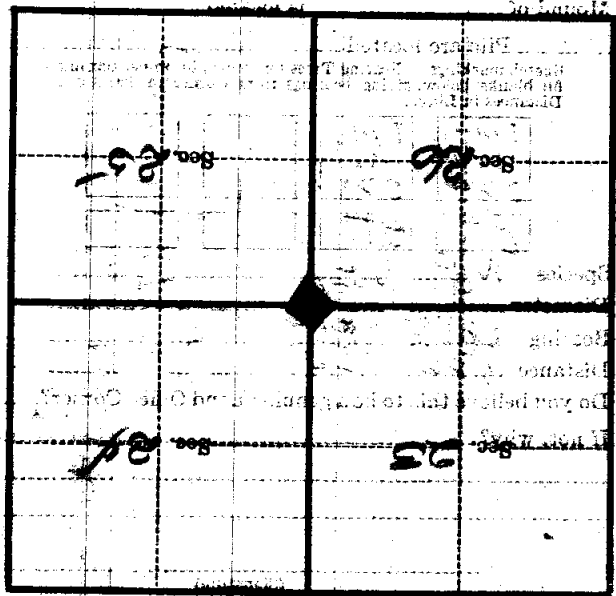

(Make sketch of topography near corner)