

Form 874-9—Revised May, 1918
 U. S. Department of Agriculture
 FOREST SERVICE

A19
 P

Chippewa NATIONAL FOREST
 CORNERS OF THE PUBLIC SURVEY

T. *147N* R. *27W* *5th* Mer.
1/4 Corner common to Sections
35, and *-2*

Corner consists of a *iron pipe* (see) in place
 State condition *just created*

Dimensions above ground *2" - 28"* inches
 Sketch grooves, letters, figures, or notches, on proper face or edge.

CARDINAL POSITION

DIAGONAL POSITION

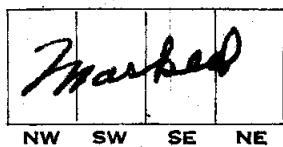
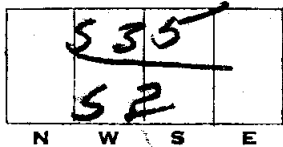

Mound of _____ is located _____

Pits are located _____

Sketch markings of Bearing Trees (or Rocks) in proper box and fill blanks below, giving bearings from Corner to Trees and Distances in Links.

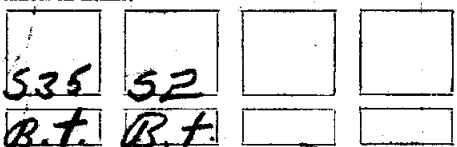

Species *W.P. J.P.*
 Diameter *1 1/2" 8"*
 Bearing *N 20 1/4 E S 55 1/2 W*
 Distance *173 51*

Do you believe this to be a genuine Land Office Corner?
 If not, why? *yes*

(Signature)

(Date)

(Title)

Metal Location Poster is on a tree _____ inches diameter, on the _____ side of _____ from which this Corner bears _____ chains distant.

Give any further facts which will aid in finding this Corner again.

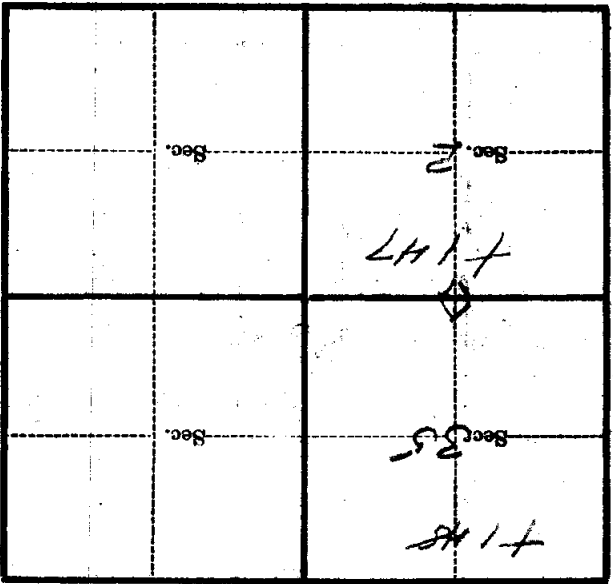

(Make sketch of topography near Corner)

T. 147 R. 22 S. 7 T. Mer.

Form 574-B—Revised May, 1918
 U. S. Department of Agriculture
 FOREST SERVICE

Chippewa NATIONAL FOREST A-19
 CORNERS OF THE PUBLIC SURVEY

T. 147N R. E7W 574-Mer.

1/4 Corner Corner common to Sections
35, and 2

Corner consists of a Iron Post in place
 State condition Just Center

Dimensions above ground 2" - 20" inches

Sketch grooves, letters, figures, or notches, on proper face or edge.
 CARDINAL POSITION

S	32		
S	2		
	1936		
N	W	S	E

DIAGONAL POSITION

<u>Marked</u>			
NW	SW	SE	NE

Mound of _____ is located _____

Pits are located _____

Sketch markings of Bearing Trees (or Rocks) in proper box and fill blanks below, giving bearings from Corner to Trees and Distances in Links.

<u>535</u>	<u>S 2</u>		
<u>BT</u>	<u>BT</u>		

Species W Pine 1 Pine

Diameter 16" 8"

Bearing N 20 1/2 E S 55 1/2 W

Distance 173 51

Do you believe this to be a genuine Land Office Corner Yes

If not, why? _____

(Signature)

(Date)

(Title)

U.S. DEPARTMENT OF AGRICULTURE
BUREAU OF LAND MANAGEMENT
CORNER OF THE QUARTER

CORNER OF THE QUARTER

Corner again.

Give any further facts which will aid in finding this

chain distant

from which this Corner bears

side of

tree inches diameter, on the

Metal Location Poster is on a

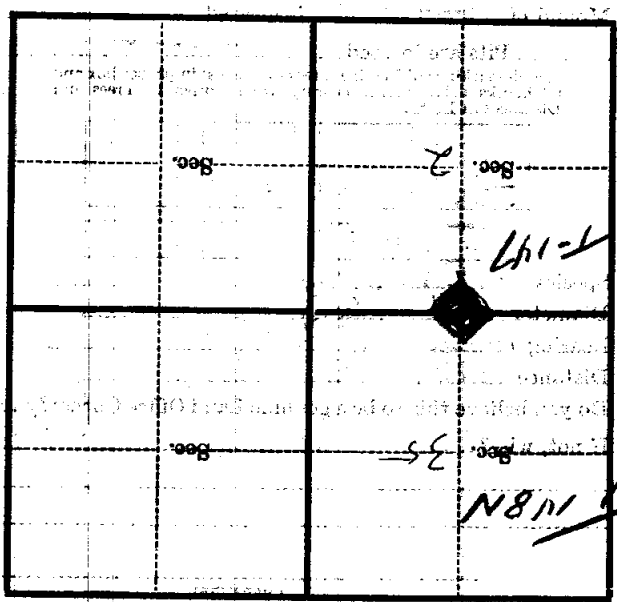

(Make sketch of topography near Corner)

Mer.

T. 147 R. 27

U. S. Department of Agriculture
FOREST SERVICE

A-19

Chippewa NATIONAL FOREST

CORNERS OF THE PUBLIC SURVEY

T. 147^N R. 27^W 5th Mer.

$\frac{1}{4}$ Corner common to Sections
35, and -2

Corner consists of a mound (see) in place
State condition just erected

Dimensions above ground 2" — 28" inches

Sketch grooves, letters, figures, or notches, on proper face or edge.

CARDINAL POSITION

DIAGONAL POSITION

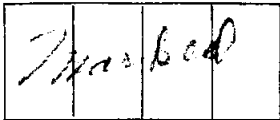
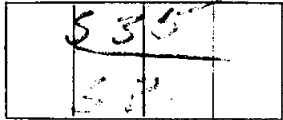

N W S E

NW SW SE NE

Mound of _____ is located _____

Pits are located _____

Sketch markings of Bearing Trees (or Rocks) in proper box and fill blanks below, giving bearings from Corner to Trees and Distances in Links.

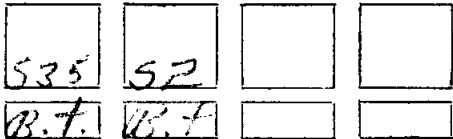

Species W.P. J.P.

Diameter 12" 8"

Bearing N20 1/2 E S45 1/2 W

Distance 123 51

Do you believe this to be a genuine Land Office Corner? yes

If not, why? _____

(Signature)

(Date)

(Title)

Metal Location Poster is on a _____ inches diameter, on the _____ side of _____ from which this Corner bears _____ chains distant.

Give any further facts which will aid in finding this Corner again.

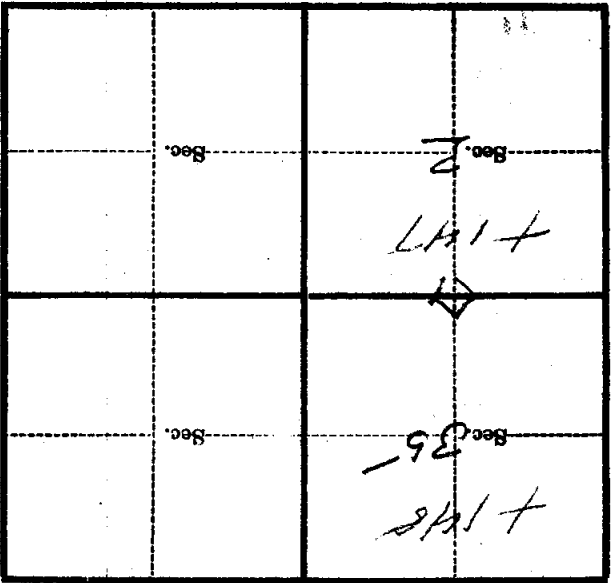

(Make sketch of topography near Corner)

T. 147 R. 27 5th Mer.