

Form 874-9—Revised May, 1918
 U. S. Department of Agriculture
 FOREST SERVICE

A-17

Chippewa NATIONAL FOREST

CORNERS OF THE PUBLIC SURVEY

T. 147N R. 27W 5th Mer.

Section Corner common to Sections 34, 35, 3, and 2

Corner consists of a CON. Mon. in place

State condition Just Erected

Dimensions above ground 6'-24"-20" inches

Sketch grooves, letters, figures, or notches, on proper face or edge.

CARDINAL POSITION

DIAGONAL POSITION

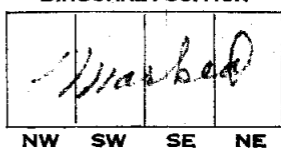
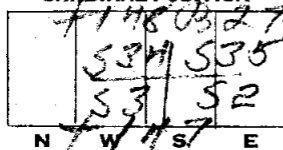

Mound of _____ is located _____

Pits are located _____

Sketch markings of Bearing Trees (or Rocks) in proper box and fill blanks below, giving bearings from Corner to Trees and Distances in Links.

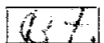
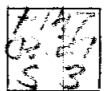
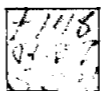
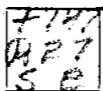
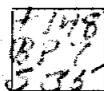

Species NP. NP. NP. NP.
 Diameter 14" 16" 12" 14"
 Bearing N72°E N53°E N43°E S36°W
 Distance 40 37 45 36

Do you believe this to be a genuine Land Office Corner? Yes

If not, why? _____

(Signature)

(Date)

(Title)

10

Metal Location Poster is on a _____ inches diameter, on the _____ side of _____ from which this Corner bears _____ chains distant.
 Give any further facts which will aid in finding this Corner again.

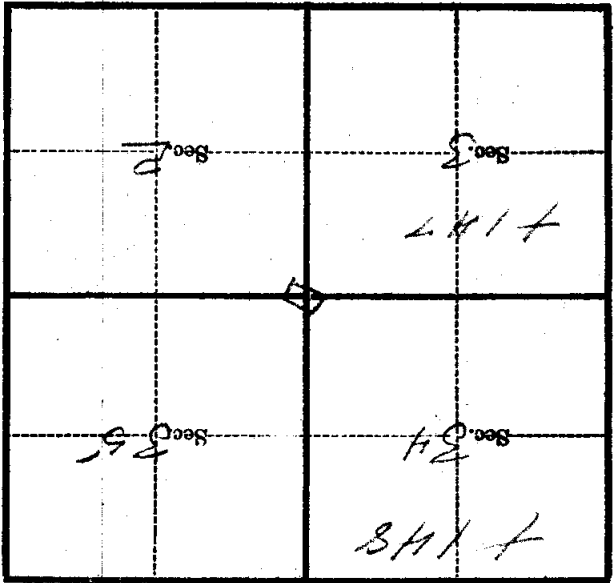

(Make sketch of topography near Corner)

T. 17 N. R. 27 E. Mer. 5th
 A-17

Form 874-9—Revised May, 1918
 U. S. Department of Agriculture
 FOREST SERVICE

AD
 AIT

Chippewa NATIONAL FOREST

CORNERS OF THE PUBLIC SURVEY

T. 147N R. 27W 5th Mer.

Section 10N Corner common to Sections 34, 35, 3, and 2

Corner consists of a Cen. Mon. in place

State condition just erected

Dimensions above ground 6'-24"-20" inches

Sketch grooves, letters, figures, or notches, on proper face or edge.

CARDINAL POSITION

DIAGONAL POSITION

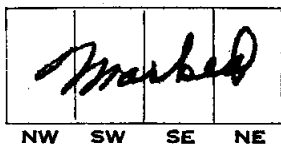
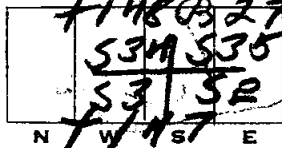

Mound of _____ is located _____

Pits are located _____

Sketch markings of Bearing Trees (or Rocks) in proper box and fill blanks below, giving bearings from Corner to Trees and Distances in Links.

F148 R27 S35	F147 R27 S2	F148 R27 S34	F147 R27 S3
B.T.	B.T.	B.T.	B.T.

Species	NP.	NP.	NP.	NP.
Diameter	17"	16"	12"	14"
Bearing	N72°E	S13°E	N43°E	S36°W
Distance	40	37	15	36

Do you believe this to be a genuine Land Office Corner? *yes*

If not, why? _____

(Signature)

(Date)

(Title)

10

(Make sketch of topography near Corner)

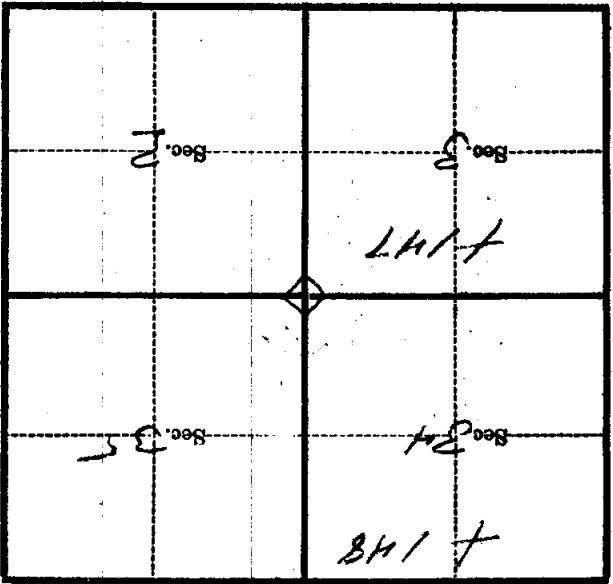

Metal Location Poster is on a tree inches diameter, on the side of from which this Corner bears chains distant. Give any further facts which will aid in finding this Corner again.

T. 147 R. 27 S. 46 Mer.

U. S. Department of Agriculture
FOREST SERVICE

Chippewa NATIONAL FOREST

A-17

CORNERS OF THE PUBLIC SURVEY

T. 147N R. R2W S74-Mer.

Section 34, 35, 3, and 2
Corner common to Sections

Corner consists of Con. Mon (not) in place
State condition Just @

Dimensions above ground 6x24-20 inches

Sketch grooves, letters, figures, or notches, on proper face or edge.

CARDINAL POSITION

DIAGONAL POSITION

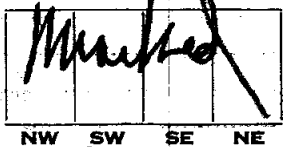
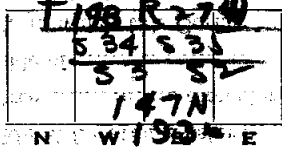

Mound of _____ is located _____

Pits are located _____

Sketch markings of Bearing Trees (or Rocks) in proper box and fill blanks below, giving bearings from Corner to Trees and Distances in Links.

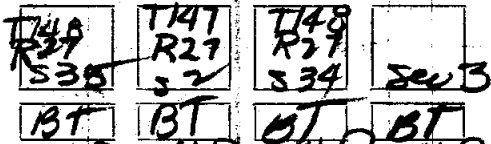

Species	NP	NP	NP	NP
Diameter	14"	16"	17"	14"
Bearing	N 72° E	S 13° E	N 16° W	S 36° W
Distance	40	57	45	36

Do you believe this to be a genuine Land Office Corner? Yes

If not, why? _____

(Signature)

(Date)

(Title)

CORNERS OF THE PUBLIC SURVEY

Corner signs:

Give any further facts which will aid in finding the
chain distant.

From which this Corner bears

side of

tree inches diameter, on the

Metal Location Poster is on a

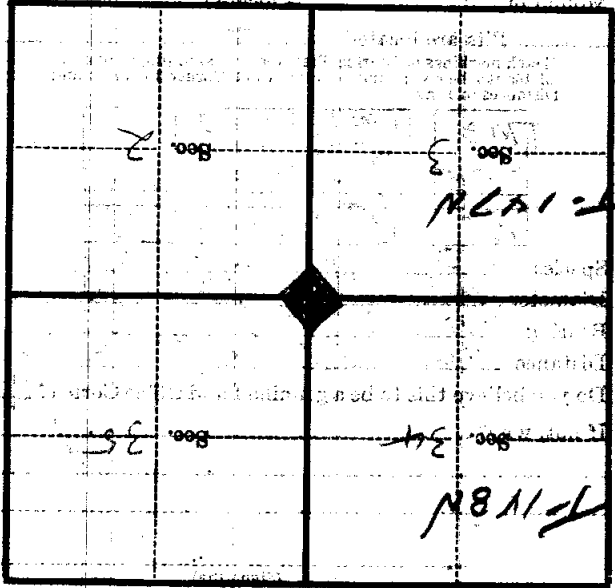

(Make sketch of topography near Corner)

U. S. Department of Agriculture
FOREST SERVICE

A-17

NATIONAL FOREST

CORNERS OF THE PUBLIC SURVEY

T. ^{14⁸} 7⁸ N R. 27 W 5th Mer.

Section Corner common to Sections
2, 3, 34, and 35

Corner consists of a Wood Stake in place
State condition POOR

Dimensions above ground 3" x 3" x 3.2 inches
Sketch grooves, letters, figures, or notches, on proper face or edge.
CARDINAL POSITION DIAGONAL POSITION

				T. 14 ⁸ N R. 27 W S. 34	S 3	T. 14 ⁸ N R. 27 W S. 2	S 35
N	W	S	E	NW	SW	SE	NE

Mound of _____ is located _____

Pits are located _____

Sketch markings of Bearing Trees (or Rocks) in proper box and fill blanks below, giving bearings from Corner to Trees and Distances in Links.

Scrubbed but can't be used.	T. 14 ⁸ N R. 27 W		

Species J.P. J.P.
Diameter 6" 8"
Bearing N. 29° E N. 38° W
Distance 0.13 ch. 0.34

Do you believe this to be a genuine Land Office Corner? Yes

If not, why? _____

H. Norman
(Signature)

Feb. 21, 1935
(Date)

Tech. Foreman
(Title)
Field Man: J. Hanson (Entire)

[Faint, illegible text on ruled lines]

Corner again.

Give any further facts which will aid in finding this

..... chains distant.

from which this Corner bears *N 81° E*

side of *tree*

tree *6"* inches diameter, on the

Metal Location Poster is on a *Spencer*

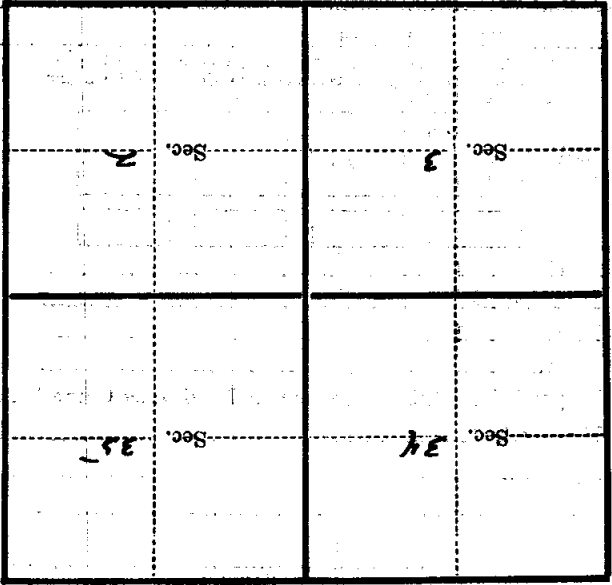

(Make sketch of topography near Corner)

T. 147 N. R. 27 W. S. 1/4 Mer.