

U. S. Department of Agriculture
FOREST SERVICE

LTA

Chippewa NATIONAL FOREST

CORNERS OF THE PUBLIC SURVEY

T. 147N R. 27W 5th Mer.

1/4

Corner common to Sections

15, and 14

Corner consists of a ~~Iron Pipe~~ (not) in place

State condition just erected

Dimensions above ground 1" - - 28" inches

Sketch grooves, letters, figures, or notches, on proper face or edge.

CARDINAL POSITION

DIAGONAL POSITION

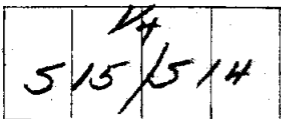

N W S E



NW SW SE NE

Mound of _____ is located _____

Pits are located _____

Sketch markings of Bearing Trees (or Rocks) in proper box and fill blanks below, giving bearings from Corner to Trees and Distances in Links.

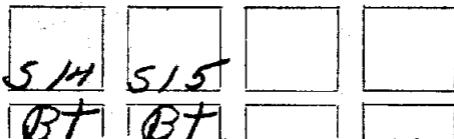

Species NP NP

Diameter 12" 14"

Bearing N 11 1/2° E N 78° W

Distance 4 29

Do you believe this to be a genuine Land Office Corner? yes

If not, why? _____

(Signature)

(Date)

(Title)

Metal Location Poster is on a tree _____ inches diameter, on the _____ side of _____ from which this Corner bears _____ chains distant.

Give any further facts which will aid in finding this Corner again.

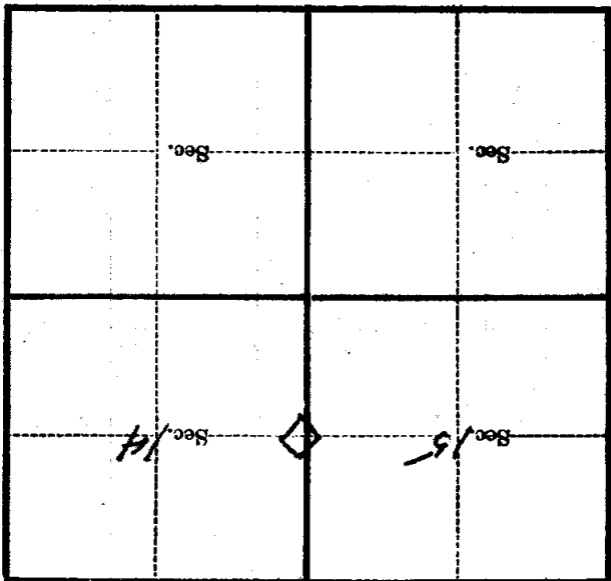

(Make sketch of topography near Corner)

T. 142N R. 27W 5th Mer.

U. S. Department of Agriculture
FOREST SERVICE

L-17

Chippewa NATIONAL FOREST

CORNERS OF THE PUBLIC SURVEY

T. 147N R. 27W 5th—Mer.

14 Corner common to Sections
15, and 14

Corner consists of a Iron Pipe (net) in place
State condition

Dimensions above ground 1" 28 inches
Sketch grooves, letters, figures, or notches, on proper face or edge.

CARDINAL POSITION

DIAGONAL POSITION

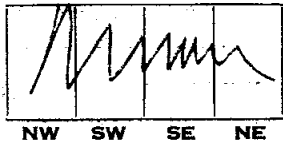
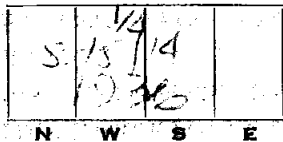

Mound of _____ is located _____

Pits are located _____

Sketch markings of Bearing Trees (or Rocks) in proper box and fill blanks below, giving bearings from Corner to Trees and Distances in Links.

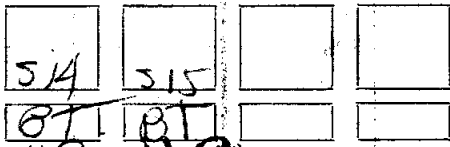

Species NP NP
Diameter 12 14"
Bearing N 1/2 W N 70 W
Distance 4 22

Do you believe this to be a genuine Land Office Corner? Yes
If not, why? _____

(Signature)

(Date)

(Title)

61

Section 15

Section 14

Give any further facts which will aid in finding this corner again.

Metal Location Poster is on a tree inches diameter, on the side of from which this Corner bears chains distant.

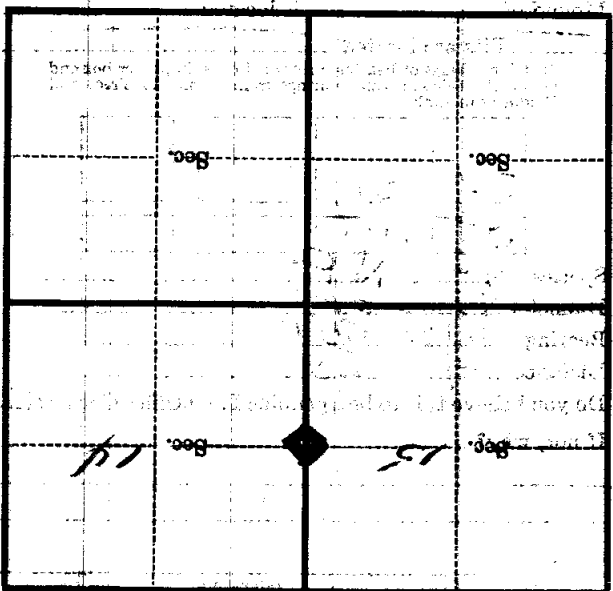

(Make sketch of topography near Corner)

U. S. Department of Agriculture
FOREST SERVICE

L-17

Chippewa NATIONAL FOREST
CORNERS OF THE PUBLIC SURVEY

T. 147N R. 27W 5th Mer.

1/4 Corner common to Sections
15, and 14

Corner consists of a ~~Iron Pipe~~ (not) in place

State condition just Erected

Dimensions above ground 1" - - 28" inches

Sketch grooves, letters, figures, or notches, on proper face or edge.

CARDINAL POSITION

DIAGONAL POSITION

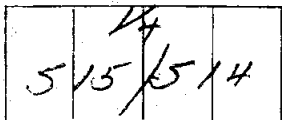

N W S E

NW SW SE NE

Mound of _____ is located _____

Pits are located _____

Sketch markings of Bearing Trees (or Rocks) in proper box and fill blanks below, giving bearings from Corner to Trees and Distances in Links.

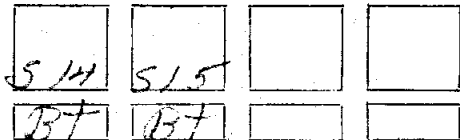

Species NP NP

Diameter 12" 14"

Bearing N 11 1/2° E N 78 1/2° W

Distance 4 29

Do you believe this to be a genuine Land Office Corner? yes

If not, why? _____

(Signature)

(Date)

(Title)

61

T. 142N R. 27W
6-4h Mer.

(Make sketch of topography near Corner)

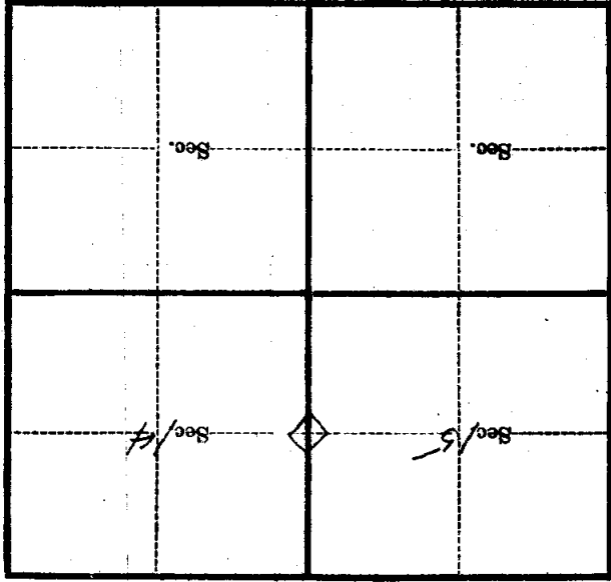

Metal Location Poster is on a

tree inches diameter, on the

side of

from which this Corner bears

chains distant.

Give any further facts which will aid in finding this

Corner again.