

Form 874-9—Revised May, 1918
U. S. Department of Agriculture
FOREST SERVICE

CHIPPEWA NATIONAL FOREST

CORNERS OF THE PUBLIC SURVEY

T. 147 N R. 27 W Mer.

Corner common to Sections

27, and 26
Corner consists of a brass cap pipe (not) in place

State condition good

Dimensions above ground 18 inches

Sketch grooves, letters, figures, or notches, on proper face or edge.

CARDINAL POSITION

DIAGONAL POSITION

--	--	--	--

N W S E

--	--	--	--

NW SW SE NE

Mound of is located

Pits are located

Sketch markings of Bearing Trees (or Rocks) in proper box and fill blanks below, giving bearings from Corner to Trees and Distances in Links.

SW			

Species N. Pine

Diameter 12"

Bearing S 83° W

Distance .50 chs.

Do you believe this to be a genuine Land Office Corner? Yes

If not, why?

J. Nomala
(Signature)
June 1, 1935
(Date)
J. H. [unclear]
(Title)

Corner again.

Give any further facts which will aid in finding this

chains distant.

from which this Corner bears

side of

tree inches diameter, on the

Metal Location Poster is on a

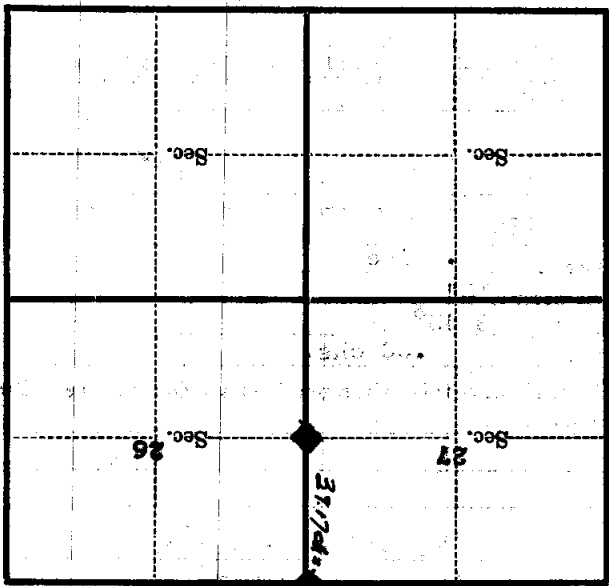

(Make sketch of topography near Corner)

T. 147 N R. 27 W 5th Mer.