

U. S. Department of Agriculture
FOREST SERVICE

E-13

Chippewa NATIONAL FOREST

CORNERS OF THE PUBLIC SURVEY

T. 147^N R. 21^W 5th Mer.

Section N Corner common to Sections
4, 3, 9, and 10

Corner consists of a con. tree (not) in place

State condition just existed

Dimensions above ground 6-24-20 inches

Sketch grooves, letters, figures, or notches, on proper face or edge.

CARDINAL POSITION

DIAGONAL POSITION

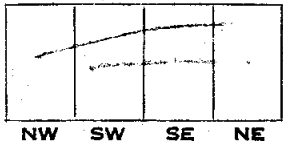
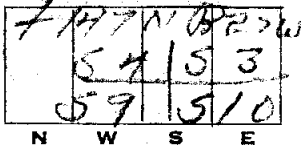

Mound of _____ is located _____

Pits are located _____

Sketch markings of Bearing Trees (or Rocks) in proper box and fill blanks below, giving bearings from Corner to Trees and Distances in Links.

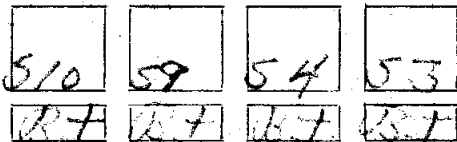

Species	<u>J.P.</u>	<u>J.P.</u>	<u>J.P.</u>	<u>J.P.</u>
Diameter	<u>10"</u>	<u>18"</u>	<u>12"</u>	<u>7 1/2"</u>
Bearing	<u>S 27° E</u>	<u>S 30° W</u>	<u>N 64 1/2° W</u>	<u>S 80° W</u>
Distance	<u>38</u>	<u>38</u>	<u>30</u>	<u>14</u>

Do you believe this to be a genuine Land Office Corner? yes

If not, why? _____

(Signature)

(Date)

(Title)

Corner again.

Give any further facts which will aid in finding this

chains distant.

from which this Corner bears

side of

tree inches diameter, on the

Metal Location Poster is on a

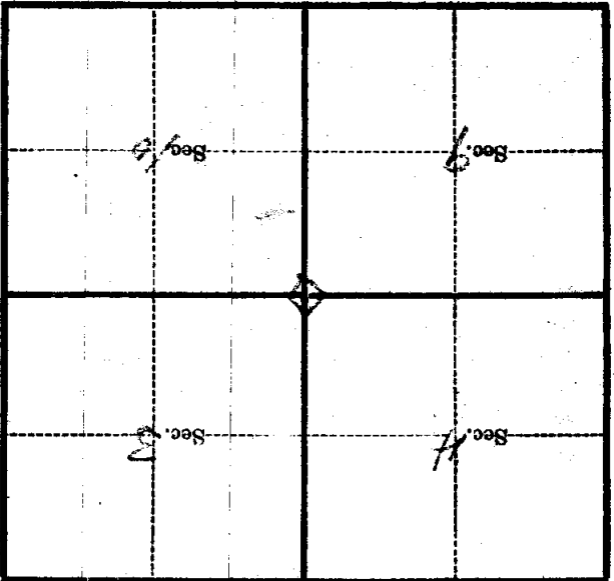

(Make sketch of topography near Corner)

T. 147N R. 27W 5th Mer.

Form 874-9—Revised May, 1918
 U. S. Department of Agriculture
 FOREST SERVICE

EB
 P

Chippewa NATIONAL FOREST

CORNERS OF THE PUBLIC SURVEY

T. 147^N R. 27^W 5th Mer.

SECTION Corner common to Sections
 4, 3, 9, and 10

Corner consists of a Con. Mon in place
 State condition just erected

Dimensions above ground 6-24-20 inches

Sketch grooves, letters, figures, or notches, on proper face or edge.

CARDINAL POSITION

DIAGONAL POSITION

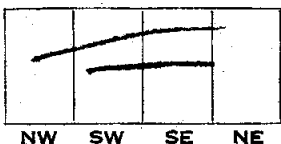
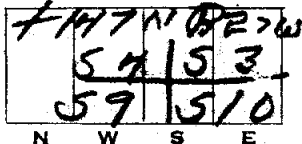

Mound of _____ is located _____

Pits are located _____

Sketch markings of Bearing Trees (or Rocks) in proper box and fill blanks below, giving bearings from Corner to Trees and Distances in Links.

510	59	54	53
B.T.	B.T.	B.T.	B.T.

Species: J.P. J.P. J.P. J.P.
 Diameter: 10" 10" 12" 12"
 Bearing: S 20° E S 30° W N 64 1/2° W S 80° W
 Distance: 38 38 30 14

Do you believe this to be a genuine Land Office Corner? yes

If not, why? _____

(Signature)

(Date)

(Title)

(Make sketch of topography near Corner)

T. 1 N 71 W R. 27 S
5-74 Mer.

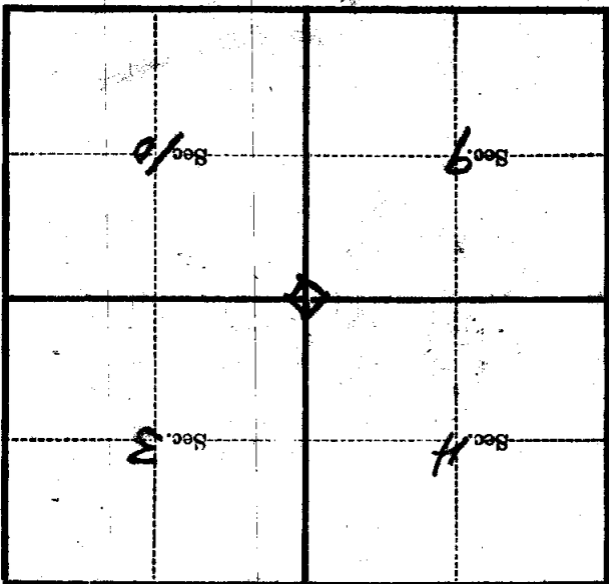

Metal Location Poster is on a

tree inches diameter, on the

side of

from which this Corner bears

chains distant.

Give any further facts which will aid in finding this

Corner again.

U. S. Department of Agriculture
FOREST SERVICE

Chippewa NATIONAL FOREST

E-13

CORNERS OF THE PUBLIC SURVEY

T. 142N R. E7W S. 574 Mer.

Section 4, 3, 9, and 10
Corner common to Sections

Corner consists of a Con m in place
State condition JE

Dimensions above ground 6x24x20 inches

Sketch grooves, letters, figures, or notches, on proper face or edge.

CARDINAL POSITION

DIAGONAL POSITION

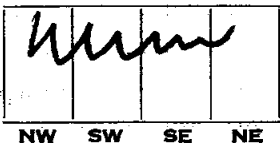
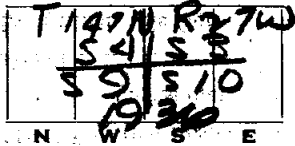

Mound of _____ is located _____

Pits are located _____

Sketch markings of Bearing Trees (or Rocks) in proper box and fill blanks below, giving bearings from Corner to Trees and Distances in Links.

<u>S10</u>	<u>S9</u>	<u>S4</u>	<u>S5</u>
<u>BT</u>	<u>BT</u>	<u>BT</u>	<u>BT</u>

Species	<u>JP</u>	<u>JP</u>	<u>JP</u>	<u>JP</u>
Diameter	<u>10"</u>	<u>10"</u>	<u>12"</u>	<u>12"</u>
Bearing	<u>S27E</u>	<u>S30W</u>	<u>N64W</u>	<u>S80W</u>
Distance	<u>38</u>	<u>38</u>	<u>30</u>	<u>14</u>

Do you believe this to be a genuine Land Office Corner?

If not, why? Yes

(Signature)

(Date)

(Title)

U.S. GEOLOGICAL SURVEY

Corner again.

Give any further facts which will aid in finding this
 chains distant.

from which this Corner bears

side of

tree inches diameter, on the

Metal Location Poster is on a

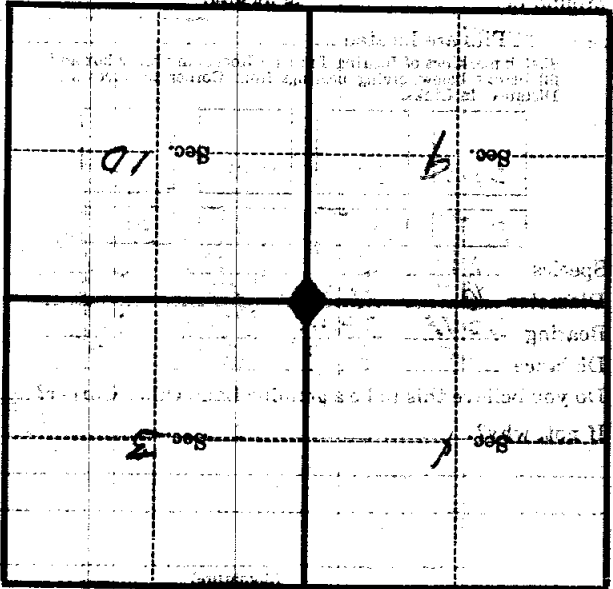

(Make sketch of topography near Corner)

T. 192N R. 27W 57A-Mer.