

U. S. Department of Agriculture
FOREST SERVICE

A-11

Chippewa NATIONAL FOREST

CORNERS OF THE PUBLIC SURVEY

T. *107N* R. *27W* *5th* Mer.

1/4 Corner common to Sections

33, and *4*

Corner consists of a *iron pipe* in place

State condition *just erected*

Dimensions above ground *2" 28"* inches

Sketch grooves, letters, figures, or notches, on proper face or edge.

CARDINAL POSITION

DIAGONAL POSITION

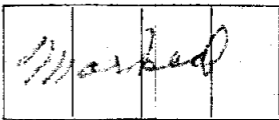
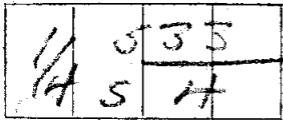

N W S E

NW SW SE NE

Mound of _____ is located _____

Pits are located _____

Sketch markings of Bearing Trees (or Rocks) in proper box and fill blanks below, giving bearings from Corner to Trees and Distances in Links.

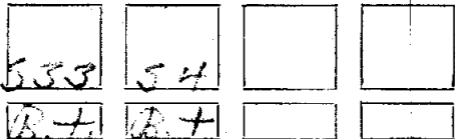

Species *Burch tree*

Diameter *4" 10"*

Bearing *N 83 1/2 W S 14 1/2 W*

Distance *112 160*

Do you believe this to be a genuine Land Office Corner? *Yes*

If not, why? _____

(Signature)

1936
(Date)

(Title)

Metal Location. Pester is on a tree _____ inches diameter, on the side of _____ from which this Corner bears _____ chains distant.

Give any further facts which will aid in finding this Corner again.

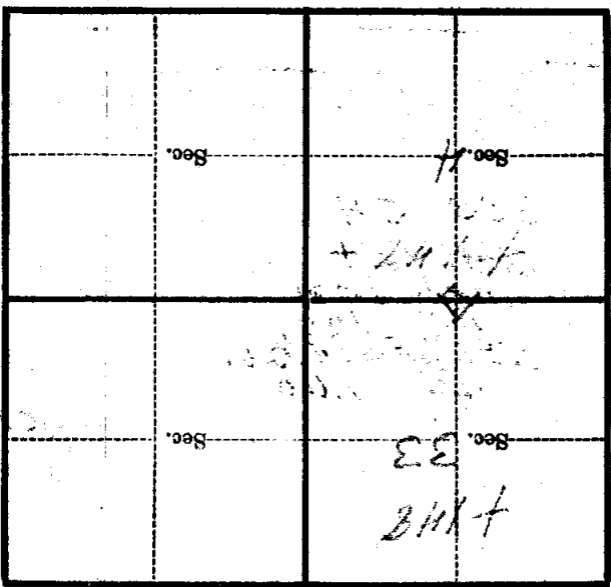

(Make sketch of topography near Corner)

T. 14 N. R. 27 Mer.

U. S. Department of Agriculture
FOREST SERVICE

A-11

Chippewa NATIONAL FOREST

CORNERS OF THE PUBLIC SURVEY

T. 147N R. 27W 5th Mer.

1/4 Corner common to Sections 33, and 4

Corner consists of a Iron Pipe in place

State condition just erected

Dimensions above ground 2" 28" inches

Sketch grooves, letters, figures, or notches, on proper face or edge.

CARDINAL POSITION

DIAGONAL POSITION

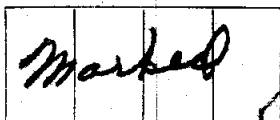
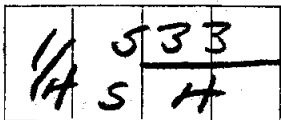

N W S E

NW SW SE NE

Mound of _____ is located _____

Pits are located _____

Sketch markings of Bearing Trees (or Rocks) in proper box and fill blanks below, giving bearings from Corner to Trees and Distances in Links.

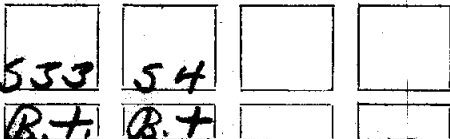

Species Birch 70m.

Diameter 4 1/2"

Bearing N 23 1/4 E 59 1/2 W

Distance 12 1.60

Do you believe this to be a genuine Land Office Corner? yes

If not, why?

1936
(Date)

(Signature)

(Title)

Metal Location Poster is on a tree inches diameter, on the side of from which this Corner bears chains distant. Give any further facts which will aid in finding this Corner again.

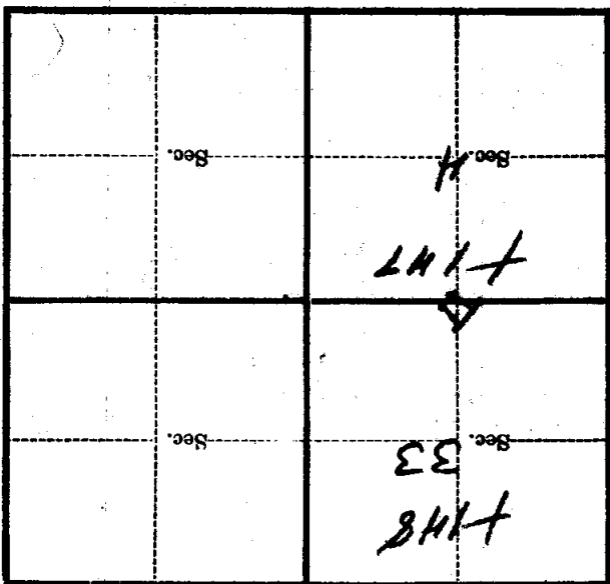

(Make sketch of topography near Corner)

T. 147 R. 27 Mer. 5th

FORM 574-C—Revised May, 1918
 U. S. Department of Agriculture
 FOREST SERVICE

Chippewa NATIONAL FOREST *A-11*
 CORNERS OF THE PUBLIC SURVEY

T. *147N* R. *R7W* *5th*—Mer.

1/4 Corner common to Sections
33, and *4*

Corner consists of a *Iron post* (set) in place
 State condition *just better*

Dimensions above ground *2"* *28* inches

Sketch grooves, letters, figures, or notches, on proper face or edge.
 CARDINAL POSITION DIAGONAL POSITION

<i>1/4</i>	<i>S</i>	<i>33</i>	
	<i>54</i>		
	<i>936</i>		
N	W	S	E

<i>Marked</i>			
NW	SW	SE	NE

Mound of _____ is located _____

Pits are located _____

Sketch markings of Bearing Trees (or Rocks) in proper box and fill blanks below, giving bearings from Corner to Trees and Distances in Links.

<i>S33</i>	<i>SA</i>		
<i>BT</i>	<i>BT</i>		

Species *Sp. T. Gray*

Diameter *10"*

Bearing *N 28° E S 4 1/2 W*

Distance *42* *1.60*

Do you believe this to be a genuine Land Office Corner? *Yes*

If not, why? _____

(Signature)

(Date)

(Title)

2049

U.S. DEPARTMENT OF AGRICULTURE

Form 1-30-1914

COMPARISON OF THE TWO CORNERS

Give any further facts which will aid in finding this

corner distant.

from which this corner bears

side of

tree inches diameter, on the

Metal Location Poster is on a

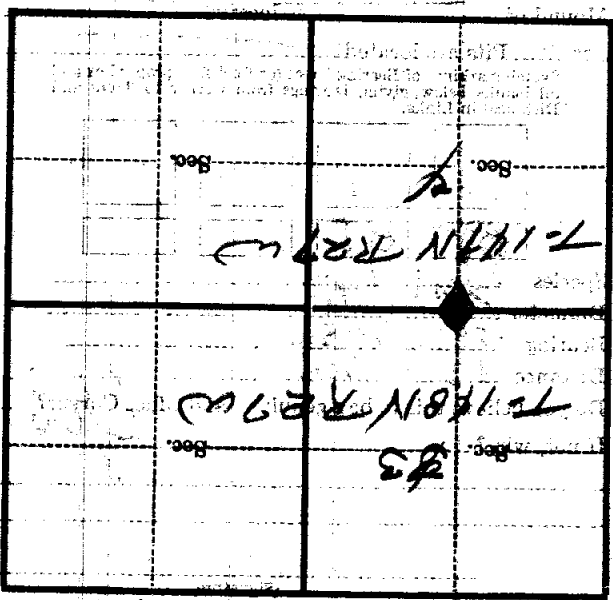

(Make sketch of topography near Corner)

T. 147N R. 27W 5th Mer.

Form 874-9—Revised May, 1918
U. S. Department of Agriculture
FOREST SERVICE

All
Noted

Chippewa NATIONAL FOREST

CORNERS OF THE PUBLIC SURVEY

T. 147N R. 27W 5 Mer.

N 1/4 Cor. Sec. 4 Corner common to Sections
SW SW NE
Sec. 33, Sec. 33, and Sec. 4

Corner consists of a Wooden post (not) in place

State condition Good

Dimensions above ground 36" inches

Sketch grooves, letters, figures, or notches, on proper face or edge.

CARDINAL POSITION

DIAGONAL POSITION

SE	SW	NE	NW
SW	SE	NW	NE
Sec. 33	Sec. 33	Sec. 4	Sec. 4

N W S E

NW SW SE NE

Mound of None is located

Pits are located None

Sketch markings of Bearing Trees (or Rocks) in proper box and fill blanks below, giving bearings from Corner to Trees and Distances in Links.

N	O	N	E

Species _____

Diameter _____

Bearing _____

Distance _____

Do you believe this to be a genuine Land Office Corner? No

If not, why? No bearing trees

3/27/35

(Date)

John M. Stephens
(Signature)
Check Corner
(Title)

18 chs. West of Highway # 16

Corner again.

Give any further facts which will aid in finding this
 . 5 chains distant.

from which this Corner bears $N 90^{\circ} W$

side of Tree

tree 14 inches diameter, on the West

Metal Location Poster is on a Aspen

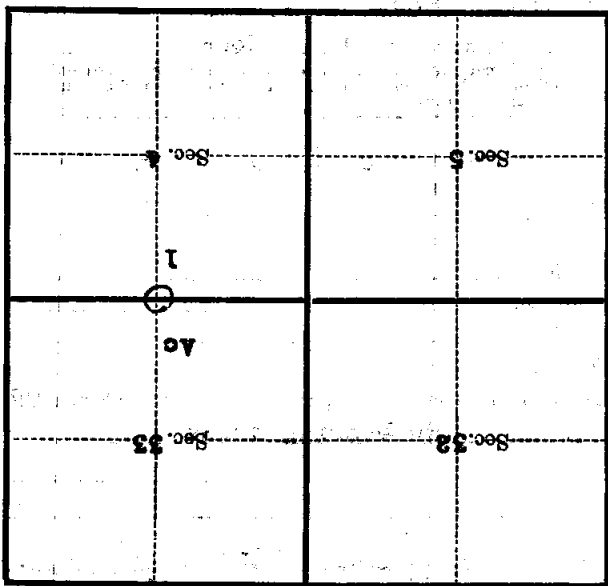

(Make sketch of topography near Corner)