

Form 874-9—Revised May, 1918  
U. S. Department of Agriculture  
FOREST SERVICE

J5  
Posted

Chippewa NATIONAL FOREST  
CORNERS OF THE PUBLIC SURVEY

T. 147N R. 27W Mer.

Section 7 Corner common to Sections  
7, 8, 17, and 10

Corner consists of a scribed state (~~not~~) in place  
State condition Very decayed

Dimensions above ground 36" high inches  
Sketch grooves, letters, figures, or notches, on proper face or edge.

CARDINAL POSITION

DIAGONAL POSITION

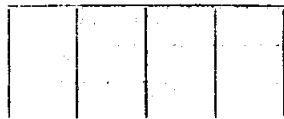

N W S E



NW SW SE NE

Mound of \_\_\_\_\_ is located \_\_\_\_\_

Pits are located \_\_\_\_\_

Sketch markings of Bearing Trees (or Rocks) in proper box and fill blanks below, giving bearings from Corner to Trees and Distances in Links.

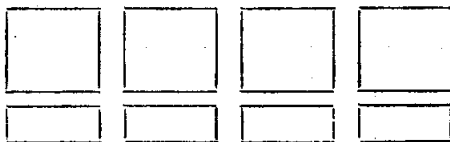

Species Aspen blue metal poster on 6" Ash

Diameter 9" tree 19 links N 90° W

Bearing S 59° W

Distance 11 1/2 links

Do you believe this to be a genuine Land Office Corner? Yes

If not, why? \_\_\_\_\_

W. Banks

(Signature)

9/15/34

(Date)

Tech. foreman

(Title)

-----

-----

-----

-----

-----

-----

-----

-----

-----

-----

Corner again.

Give any further facts which will aid in finding this

..... chains distant. *.19*

from which this Corner bears *N 70° W*

side of

tree *.6* inches diameter, on the

*81-* Metal Location Poster is on a *W. A. & B.*

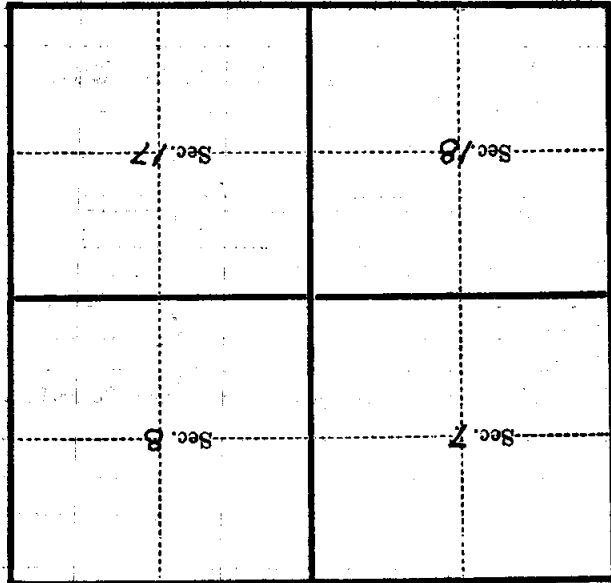

(Make sketch of topography near Corner)

*T. 147N. R. 22W. Mer.*

Form 874-9—Revised May, 1918  
 U. S. Department of Agriculture  
 FOREST SERVICE

*Copied  
 Pasted  
 JAS 3/6*

..... NATIONAL FOREST

**CORNERS OF THE PUBLIC SURVEY**

T. 147 R. 27 5 Mer.

..... Corner common to Sections

8, 17, ....., and .....

Corner consists of a ~~poplar post now~~ (not) in place

State condition .....

Dimensions above ground ..... inches

Sketch grooves, letters, figures, or notches, on proper face or edge.

CARDINAL POSITION

DIAGONAL POSITION

--	--	--	--

N W S E

--	--	--	--

NW SW SE NE

Mound of ..... is located .....

..... Pits are located .....

Sketch markings of Bearing Trees (or Rocks) in proper box and fill blanks below, giving bearings from Corner to Trees and Distances in Links.

Species .....

Diameter .....

Bearing .....

Distance .....

Do you believe this to be a genuine Land Office Corner? .....

If not, why? .....

.....

.....

..... (Signature)

..... (Date)

..... (Title)

NATIONAL FOREST

CORNER OF THE PUBLIC BURNING

17  
15. A 1/2 one chain S of corner of se  
Corner again.

Give any further facts which will aid in finding this  
chains distat.  
from which this Corner bears  
side of  
tree inches diameter, on the  
Metal Location Poster is on a

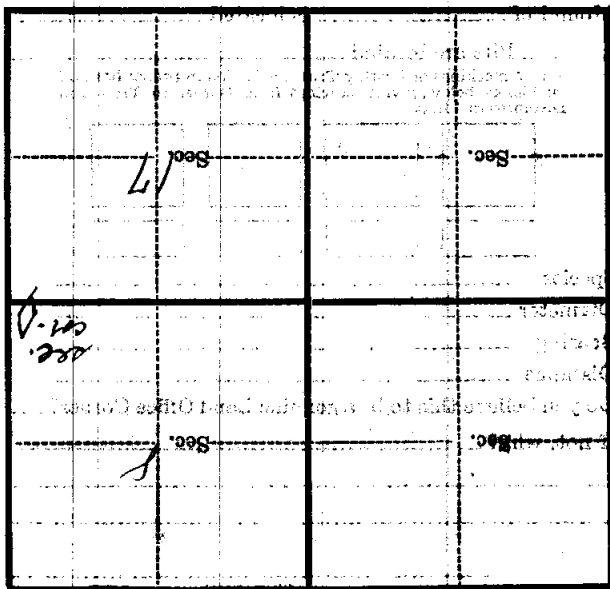

(Make sketch of topography near Corner)

Mer.

R.

T.

U. S. Department of Agriculture

FOREST SERVICE

J.S

Chippewa NATIONAL FOREST

CORNERS OF THE PUBLIC SURVEY

T. 147N R. 27W 54- Mer.

Section Corner common to Sections 7, 8, 18, and 17

Corner consists of a Con. Stone (not) in place

State condition just located

Dimensions above ground 6 x 12 x 20 inches

Sketch grooves, letters, figures, or notches, on proper face or edge.

CARDINAL POSITION

DIAGONAL POSITION

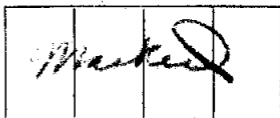
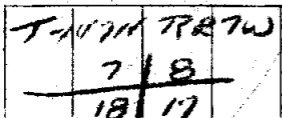

N

W

S

E

NW

SW

SE

NE

Mound of \_\_\_\_\_ is located \_\_\_\_\_

Pits are located \_\_\_\_\_

Sketch markings of Bearing Trees (or Rocks) in proper box and fill blanks below, giving bearings from Corner to Trees and Distances in Links.

S-8	S-19	S-18	S-7
BT	BT	BT	BT

Species Ash Ash Ash Ash

Diameter 5" 4" 6" 7"

Bearing N. 54 1/2° E S. 30° E S. 12° E N. 74° W

Distance 19 44 40 146

Do you believe this to be a genuine Land Office Corner? Yes

If not, why? \_\_\_\_\_

(Signature)

1934 (Date)

(Title)

Metal Location Poster is on a \_\_\_\_\_  
 tree \_\_\_\_\_ inches diameter, on the \_\_\_\_\_  
 side of \_\_\_\_\_  
 from which this Corner bears \_\_\_\_\_  
 chains distant.

Give any further facts which will aid in finding this  
 Corner again.

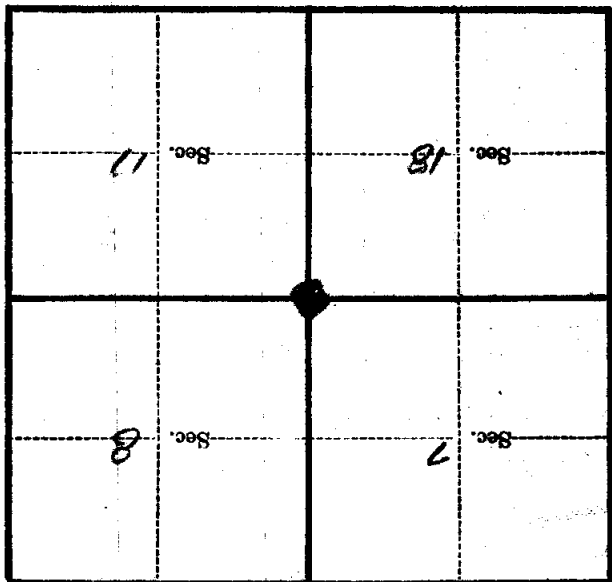

(Make sketch of topography near Corner)

T. 111N R. 27W S. 7N-Mer.

Form 874-0—Revised May, 1918  
 U. S. Department of Agriculture  
 FOREST SERVICE

J. 5

Chippewa NATIONAL FOREST  
 CORNERS OF THE PUBLIC SURVEY

T. 147N R. 27W 5th Mer.

Section Corner common to Sections  
 7, 8, 18, and 17

Corner consists of a concrete (iron) in place  
 State condition good

Dimensions above ground 6 X 24 X 20 inches  
 Sketch grooves, letters, figures, or notches, on proper face or edge.

CARDINAL POSITION

DIAGONAL POSITION

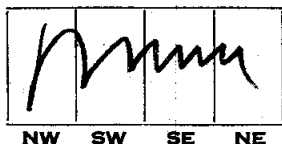
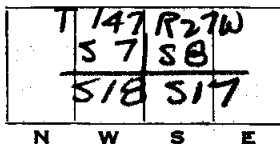

Mound of \_\_\_\_\_ is located \_\_\_\_\_

Pits are located \_\_\_\_\_

Sketch markings of Bearing Trees (or Rocks) in proper box and fill blanks below, giving bearings from Corner to Trees and Distances in Links.

[ ]	[ ]	[ ]	[ ]
S 8	S 17	S 18	S 7
BT	BT	BT	BT

Species ash ash ash ash  
 Diameter 3" 4" 5 7  
 Bearing N54 1/2 E S30 E S17 W N74 W  
 Distance 19 44 40 16

Do you believe this to be a genuine Land Office Corner?  
 If not, why? Yes

(Signature)

(Date)

(Title)

-----

-----

-----

-----

-----

-----

-----

-----

-----

-----

Corner again.

Give any further facts which will aid in finding this  
 ----- chains distant.  
 ----- from which this Corner bears  
 ----- side of  
 ----- tree ----- inches diameter, on the  
 ----- Metal Location Poster is on a

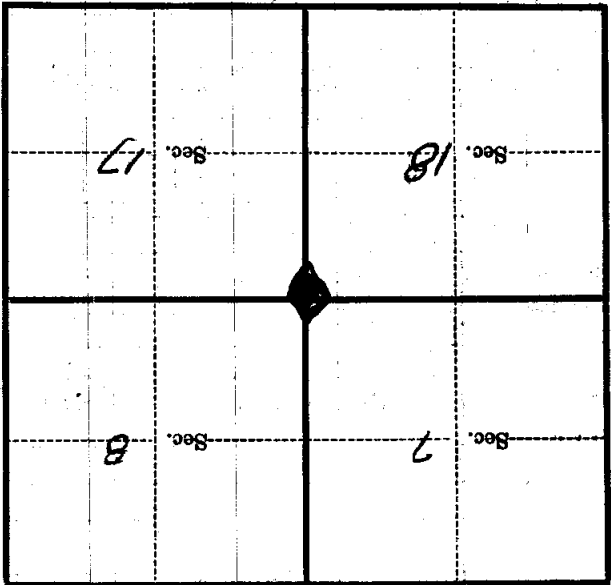

(Make sketch of topography near Corner)



U. S. Department of Agriculture  
FOREST SERVICE

Chippewa NATIONAL FOREST

J-5

CORNERS OF THE PUBLIC SURVEY

T. 147N R. 27W 54- Mer.

Section Corner common to Sections  
7, 8, 18, and 17

Corner consists of a Co. 7 - Mount (not) in place  
State condition just erected

Dimensions above ground 6 x 12 x 20 inches

Sketch grooves, letters, figures, or notches, on proper face or edge.

CARDINAL POSITION

DIAGONAL POSITION

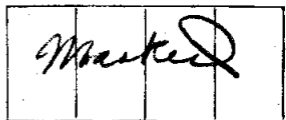
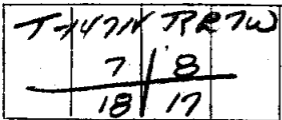

N W S E NW SW SE NE

Mound of \_\_\_\_\_ is located \_\_\_\_\_

Pits are located \_\_\_\_\_

Sketch markings of Bearing Trees (or Rocks) in proper box and fill blanks below, giving bearings from Corner to Trees and Distances in Links.

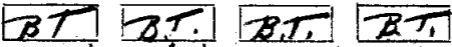
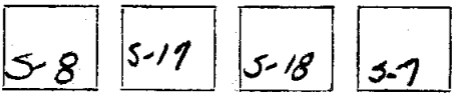

Species Ash Ash Ash Ash  
 Diameter 5" 4" 5" 7"  
 Bearing N-54 1/2° E S-30° E S-18° E N-74° W  
 Distance 19 44 40 16 Lks.

Do you believe this to be a genuine Land Office Corner? Yes

If not, why? \_\_\_\_\_

(Signature)

1936  
(Date)

(Title)

Metal Location Poster is on a tree inches diameter, on the side of from which this Corner bears chains distant. Give any further facts which will aid in finding this Corner again.

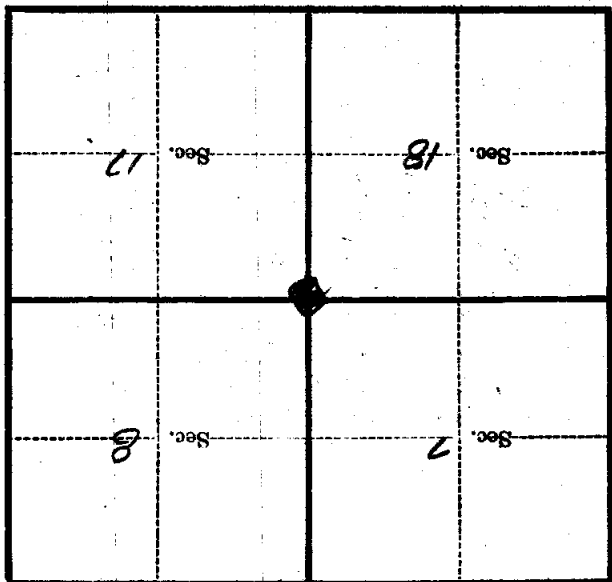

(Make sketch of topography near Corner)

T. 147N R. 27W S.M.-Mer.