

U. S. Department of Agriculture
FOREST SERVICE

Chippewa NATIONAL FOREST L-5

CORNERS OF THE PUBLIC SURVEY

T. 142N R. R2W 514 Mer.

1/4 Corner common to Sections 18 and 17

Corner consists of a TOP (24) in place
State condition

Dimensions above ground 28 inches

Sketch grooves, letters, figures, or notches, on proper face or edge.

CARDINAL POSITION

DIAGONAL POSITION

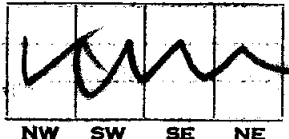
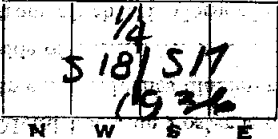

Mound of ~~is located~~

Pits are located

Sketch markings of Bearing Trees (or Rocks) in proper box and fill blanks below, giving bearings from Corner to Trees and Distances in Links.

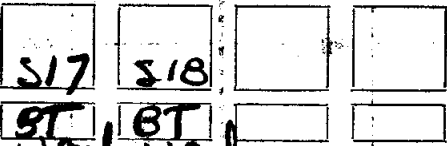

Species White Oak

Diameter 4

Bearing N 62 1/2 E N 27 W

Distance 47 17

Do you believe this to be a genuine Land Office Corner?

If not, why?

[Handwritten signature]

(Signature)

(Date)

(TIME)

Handwritten notes on a grid background, including the words "MOUNTAIN" and "CANYON".

Corner again.

Give any further facts which will aid in finding this

chains distant.

from which this Corner bears

side of

tree inches diameter, on the

Metal Location Poster is on a

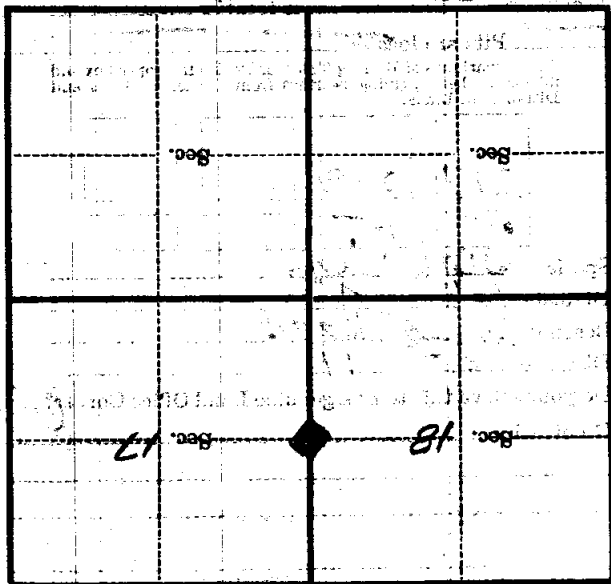

(Make sketch of topography near Corner)

U. S. Department of Agriculture
FOREST SERVICE

LS
R

Chippewa NATIONAL FOREST

CORNERS OF THE PUBLIC SURVEY

T. 147N R. 27W 57th Mer.

1/4 Corner common to Sections

18, and 17

Corner consists of a Iron Pipe (not) in place

State condition new

Dimensions above ground 1" - 28" inches

Sketch grooves, letters, figures, or notches, on proper face or edge.

CARDINAL POSITION

DIAGONAL POSITION

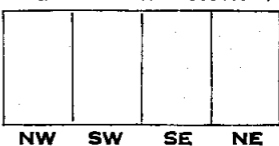
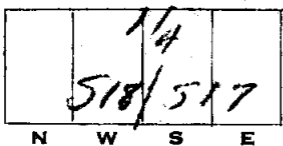

Mound of _____ is located _____

Pits are located _____

Sketch markings of Bearing Trees (or Rocks) in proper box and fill blanks below, giving bearings from Corner to Trees and Distances in Links.

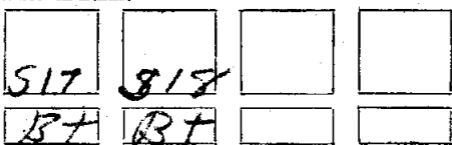

Species W OAK W OAK

Diameter 6 4

Bearing N 62 1/2 E 112 7° W

Distance 47 11

Do you believe this to be a genuine Land Office Corner? yes

If not, why? _____

(Signature)

(Date)

(Title)

70

Corner again.

Give any further facts which will aid in finding this

chains distant.

from which this Corner bears

side of

tree inches diameter, on the

Metal Location Poster is on a

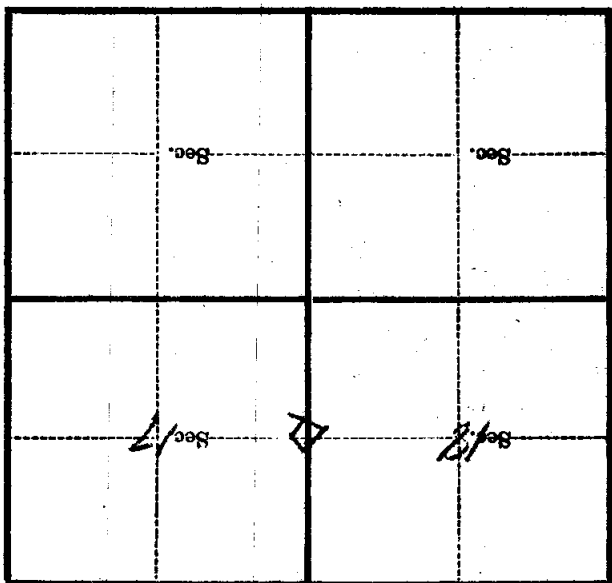

(Make sketch of topography near Corner)

T. 142N R. 27W 5TH Mer.

U. S. Department of Agriculture
FOREST SERVICE

L-5

Chippewa NATIONAL FOREST

CORNERS OF THE PUBLIC SURVEY

T. 147N R. 27W 5th Mer.

1/4 Corner common to Sections

18, and 17
Corner consists of a Iron Pipe (not) in place

State condition good

Dimensions above ground 1" - 28" inches

Sketch grooves, letters, figures, or notches, on proper face or edge.

CARDINAL POSITION

DIAGONAL POSITION

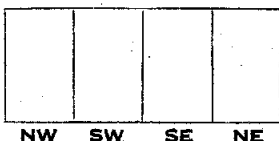
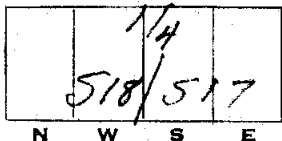

Mound of _____ is located _____

Pits are located _____

Sketch markings of Bearing Trees (or Rocks) in proper box and fill blanks below, giving bearings from Corner to Trees and Distances in Links.

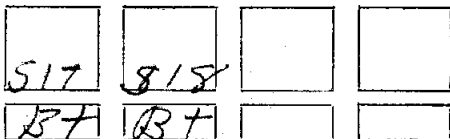

Species W. OAK W. OAK

Diameter 6 4

Bearing N 62 1/2 E N 67 W

Distance 47 11

Do you believe this to be a genuine Land Office Corner? yes
If not, why? _____

(Signature)

(Date)

(Title)

70

Corner again.

Give any further facts which will aid in finding this

chains distant.

from which this Corner bears

side of

tree inches diameter, on the

Metal Location Poster is on a

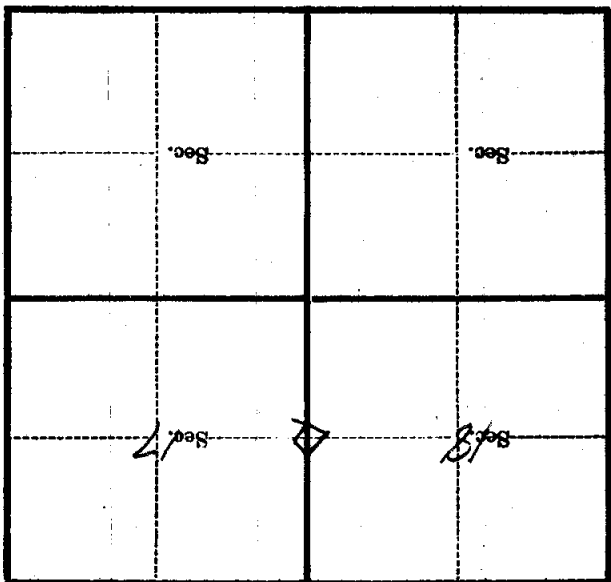

(Make sketch of topography near Corner)

T. 142N R. 27W S. 7h Mer.