

U. S. Department of Agriculture
FOREST SERVICE

Chippewa NATIONAL FOREST A-3
CORNERS OF THE PUBLIC SURVEY

T. 147 R. 27 5-31 Mer.

1/4 Corner common to Sections
6, and 31

Corner consists of a Iron Post (~~not~~) in place

State condition new

Dimensions above ground 2" - 2 1/2" inches

Sketch grooves, letters, figures, or notches, on proper face or edge.

CARDINAL POSITION

DIAGONAL POSITION

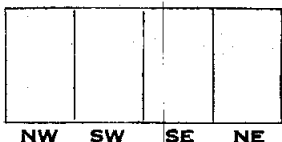
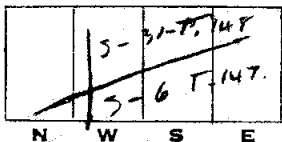

Mound of _____ is located _____

Pits are located _____

Sketch markings of Bearing Trees (or Rocks) in proper box and fill blanks below, giving bearings from Corner to Trees and Distances in Links.

T-148
R-27
S-31

T-147
S-6

--

--

B-T

B-T

--

--

Species T.A.M. T.A.M.

Diameter 5" 4"

Bearing N-24°E S-24°E

Distance 38 70

Do you believe this to be a genuine Land Office Corner? yes

If not, why? _____

B. A. ...
(Signature)

Leader
(Title)

1937
(Date)

Corner again.

Give any further facts which will aid in finding this

chains distant.

from which this Corner bears

side of

tree inches diameter, on the

Metal Location Poster is on a

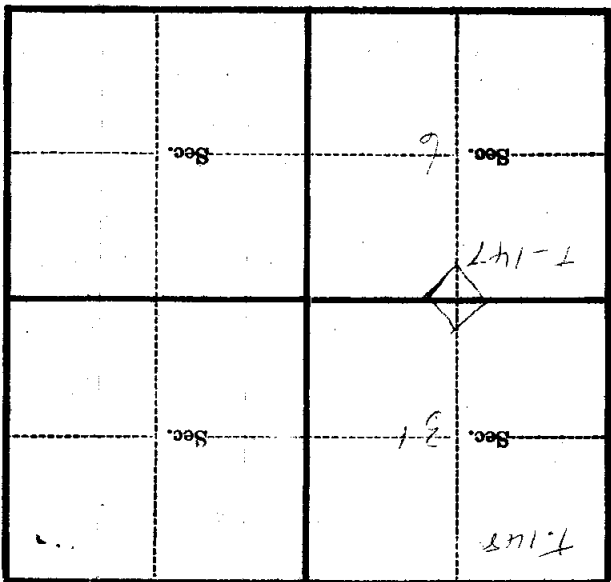

(Make sketch of topography near Corner)

T. 147 R. 27 Mer.

U. S. Department of Agriculture
FOREST SERVICE

A-3

Chippewa NATIONAL FOREST
CORNERS OF THE PUBLIC SURVEY

T. 147 R. 27 Mer. 5th

1/4 Corner common to Sections
6, and 31

Corner consists of a Iron Post (not) in place

State condition new

Dimensions above ground 2" - 28" inches

Sketch grooves, letters, figures, or notches, on proper face or edge.

CARDINAL POSITION

DIAGONAL POSITION

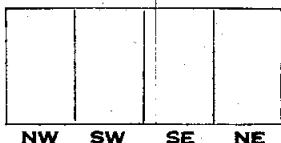
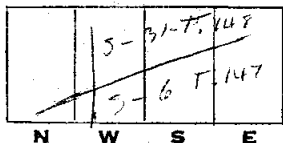

Mound of _____ is located _____

Pits are located _____

Sketch markings of Bearing Trees (or Rocks) in proper box and fill blanks below, giving bearings from Corner to Trees and Distances in Links.

T-147
R. 27
S-31

T-147
S-6

B-*

B.T

Species TAMM TAMM

Diameter 5" 4"

Bearing N-24°E S-24°E

Distance .38 .70

Do you believe this to be a genuine Land Office Corner? yes

If not, why? _____

B. also
(Signature)

1937
(Date)

Leader
(Title)

Corner again.

Give any further facts which will aid in finding this

chains distant.

from which this Corner bears

side of

tree inches diameter, on the

Metal Location Poster is on a

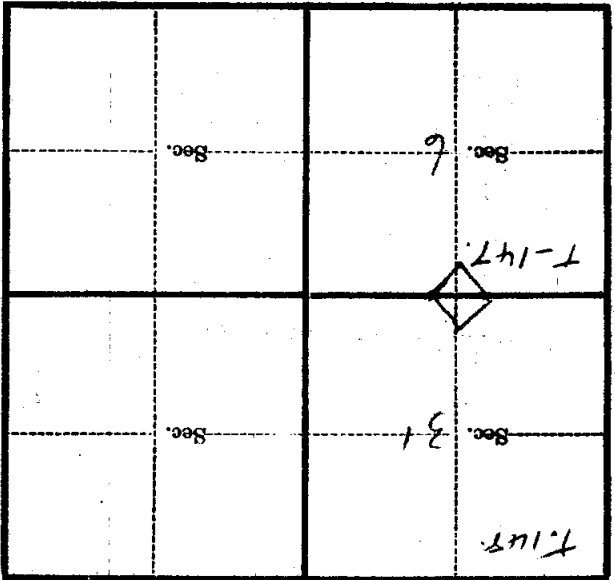

(Make sketch of topography near Corner)

T. 147 R. 27 S. 5 Mer.

A3
P

U. S. Department of Agriculture
FOREST SERVICE

Chippewa NATIONAL FOREST

CORNERS OF THE PUBLIC SURVEY

T. 147 R. 27 S Mer.

1/4 corner Corner common to Sections 31, 36, and 35

Corner consists of ~~Iron Pipe~~ in place
State condition ~~just erected~~

Dimensions above ground 2'-0"-28" inches

Sketch grooves, letters, figures, or notches, on proper face or edge.

CARDINAL POSITION

DIAGONAL POSITION

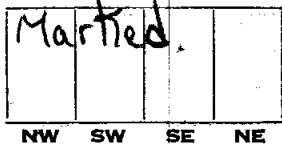
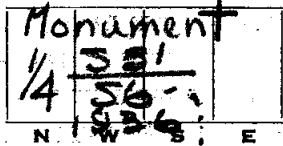

Mound of _____ is located _____

Pits are located _____

Sketch markings of Bearing Trees (or Rocks) in proper box and fill blanks below, giving bearings from Corner to Trees and Distances in Links.



Species 10m. 10m.

Diameter 5" 4"

Bearing N 24 W S 24 E

Distance 38 20

Do you believe this to be a genuine Land Office Corner? Yes.
If not, why? _____

(Signature)

(Date)

(Title)

Metal Location Poster is on a tree inches diameter, on the side of from which this Corner bears chains distant. Give any further facts which will aid in finding this Corner again.

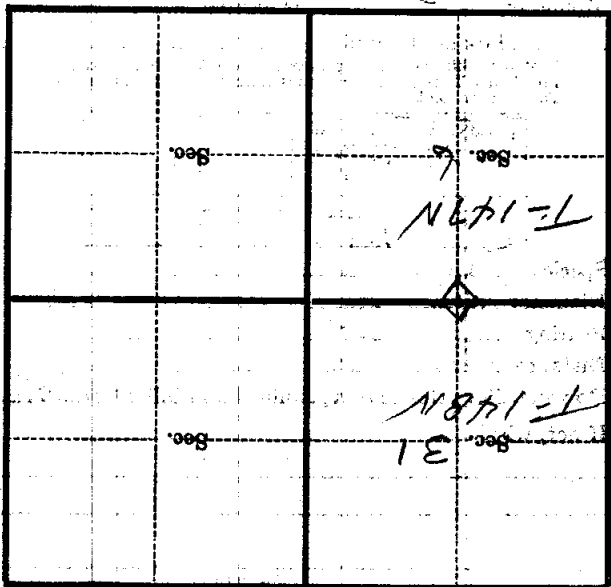

(Make sketch of topography near Corner)

T 147 R 27 Mer. 5